

# STAND DOWN®

## Self Contained Sensor Pad

### SD-2 and SD-3 Bed Monitoring Systems

#### INSTRUCTIONS – QUICK START GUIDE

StandDown is a completely self-contained bed monitoring system. There are no plugs to connect, wires to route, or alert units to locate. Simply position the sensing pad, place patient, and move the tamper resistant slide selector to the ON position.

#### SYSTEM PLACEMENT

Identify the topside of StandDown, then orientate the Pad so that the Pad Extension with Monitoring Controls drapes over the outside of the bed. Install StandDown under the bed pad or sheet, and in the area of the patient's upper legs and hips. See Fig. A



Fig. A

After positioning the StandDown system, tuck the lower part of the Pad Extension up and under the bed rail for standard beds, while still letting the Monitoring Controls hang. The “embedded magnets,” inside the Pad Extension, will attach it to the inside/top of the bed rail. See Fig. B. If the foot of the bed is raised while the patient is in bed, the magnetic attachment will free itself allowing the caregiver to reposition the controls during elevated mattress use.

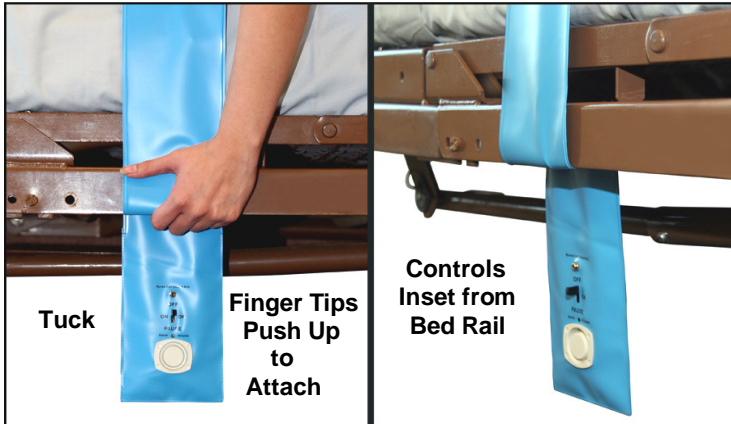

Fig. B

For special bed types, tuck approximately four inches of the lower part of the Pad Extension under the mattress. See Fig. C. If the foot of the bed is raised while the patient is in bed, the caregiver may reposition the controls during elevated mattress use.

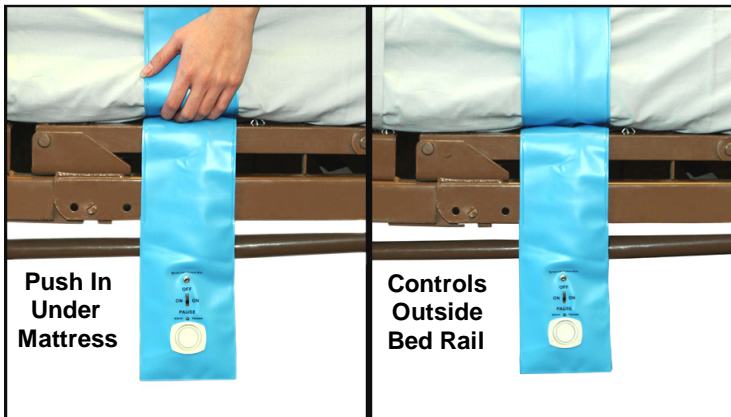

Fig. C

The “embedded attaching magnets,” in the lower part of the Pad Extension, may also be used to hold the Controls at any convenient location on or under both standard and specialized beds.

Best location, during care giving, will depend on type of bed, adjusted bed height, type of assistance required, patient risk level, and other considerations.

Please pay special attention to where Monitoring Controls are if the adjusted bed height is very low. Always keep Pad Extension with Monitoring Controls clear of moving bed parts.

#### MONITORING

When patient is lying in bed and comfortably situated, move the Slide Selector from the OFF position to the ON position and monitoring will automatically begin.

The Pad extension may be held with one hand while operating the Slide Selector with the other. See Fig. D for Slide Selector location.

The system will not alarm as long as the patient remains in bed. If the patient attempts to stand and exit the bed, alarm will sound. When the patient is returned to bed position, the system will automatically reset and monitoring will resume.

If a patient is being escorted from bed to a temporary non-bed activity such as toilet duties or shower, the slide selector may be moved to the PAUSE position.

In PAUSE position, StandDown emits a steady low-volume sound indicating that the system is “standing by” and neither monitoring (ON) or completely out-of-service (OFF). PAUSE setting will remind a caregiver to move the Slide Selector back to ON position after an out-of-bed activity has been completed and the patient has been resituated in bed. It is VERY IMPORTANT to MAKE SURE that StandDown IS IN THE ON Position when monitoring a patient.

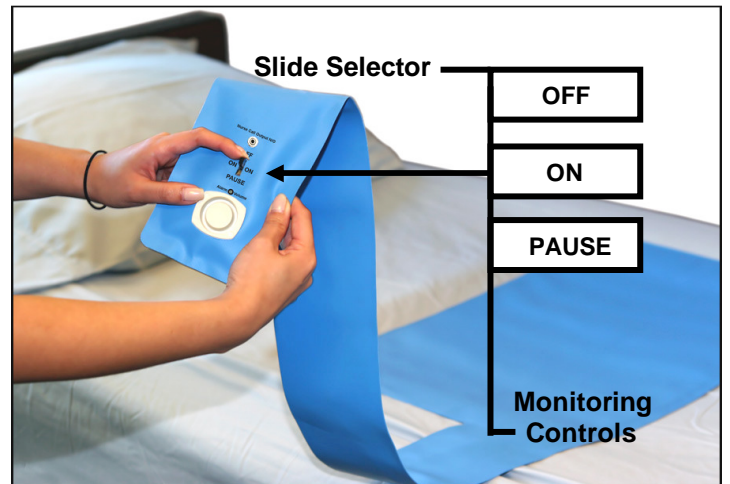

#### END MONITORING SESSION

Locate slide selector and move it to the OFF position.

#### NURSE CALL SYSTEM MONITORING

Remote monitoring is possible when StandDown is connected to a nurse call station using the optional SD-NC cable. See Fig. E.

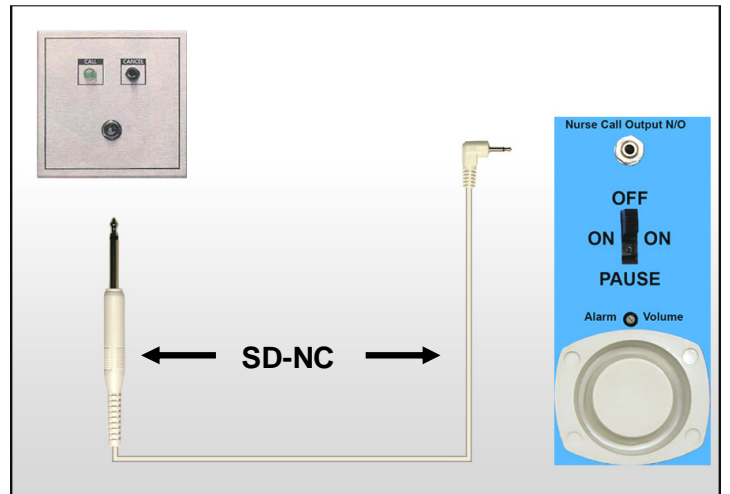

Fig. E

StandDown will now continue to provide local alarm while simultaneously sending an alarm signal to central monitoring personnel.

The SD-NC cable should be routed from the Pad extension, under bed or mattress, to the head of the bed, and then to the nurse call station. Please secure the cable as necessary according to your facility's safety and housekeeping requirements

If another device occupies the only available port on a wall station, the optional SD-NCA adapter can be used to enable dual inputs. See Accessories.

**ALARM VOLUME**

Alarm volume is adjustable. The volume adjustment screw is located on the Pad Extension between PAUSE and the audio speaker.

Using a small flat tip screwdriver, gently turn the screw clockwise to decrease volume or counterclockwise to increase volume. See Fig. F

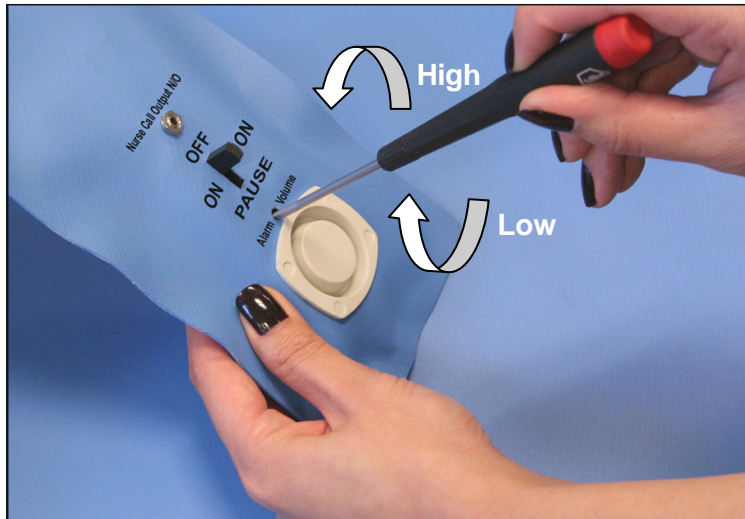

Fig. F

**TAMPERING - PREVENTION**

The embedded attaching magnets will normally prevent patient tampering, but in extreme cases, loop the supplied Velcro Strap around any suitable bed part, under and near the mattress. Grasp the Pad Extension and wrap the now hanging Strap securely around it. Press the hard area of the Strap to the soft area of the Strap. See Fig. G. If the foot of the bed is raised, two Straps (included) can be joined for added length.

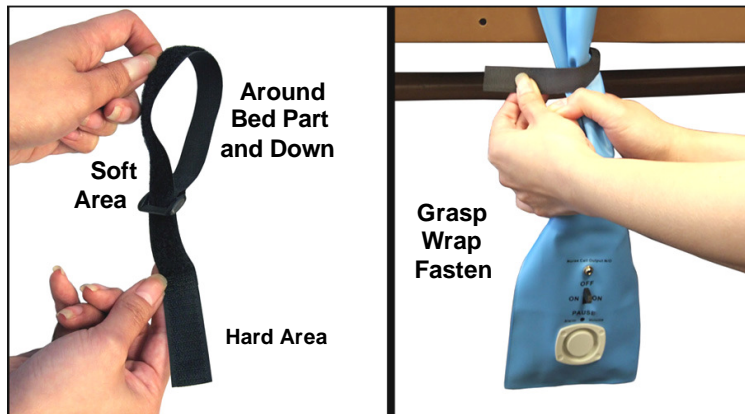

Fig. G

**TESTING**

Caregivers should test the StandDown system before each use by applying pressure to the Pad with their hand, moving the Slide Selector to ON, and then removing hand pressure. If STANDDOWN fails to alarm, immediate replacement is required.

**CLEANING**

StandDown may be cleaned with standard healthcare disinfectants. Do not immerse in water.

**STORAGE AFTER USE**

The StandDown monitoring system may be loosely rolled, or loosely folded for storage: FOLD OR ROLL IN ONE DIRECTION ONLY. Please follow the instructions on the bottom of the Pad to avoid damaging sensitive electronics and voiding warrantee.

StandDown is best stored by first folding the Monitoring Controls towards the Pad. This method keeps the Monitoring Controls protected inside the roll or fold. See Fig. H. Please make sure the Slide Selector remains in the OFF position when storing.

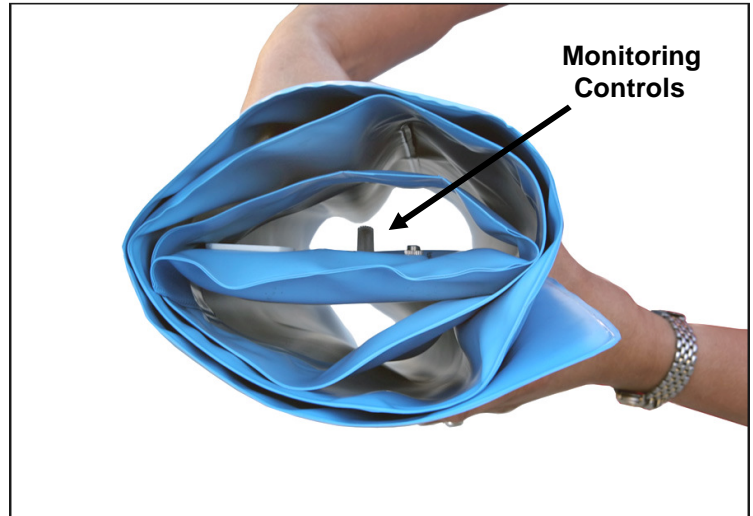

Fig. H

**REPLACEMENT - 1 YEAR**

Upon first use, caregiver's should calculate a date twelve months in advance and enter that date with indelible pen in the white writing area provided on the bottom of StandDown.

After twelve months, the disposable StandDown system must be removed from service and replaced.

StandDown is environmentally friendly and may be disposed of using standard methods for disposing similar electronic devices.

**SPECIAL NOTE TO CAREGIVER**

StandDown is 100% Latex-Free.

**ACCESSORIES (See Fig. I)**

SD-NC

24-Foot Cable: StandDown to Nurse Call Station.

SD-NCA

6-Foot Y-Adapter: Nurse Call Station to SD-NC and a second device.



Fig. I

**40 Years of Superior American Manufacturing**  
 Made in U.S.A.  
**U.S. and FOREIGN PATENTS**