



# APPLICATION INSTRUCTION SHEET POSEY® SELF-RELEASING CHAIR BELTS

Applicable Products:  
Cat. No. 4220, 4222, 4228, 4228L

**DESCRIPTION OF PRODUCT:** A self-releasing chair belt.  
For wheelchair or geri-chair use.

**INDICATIONS:**

- Patients needing a reminder to call for assistance before they ambulate.
- Patients who require a positioning product to assist medical treatment.

If the patient/resident is not able to easily self-release this product, it would be considered a restrictive product and therefore must be prescribed by a physician.

**CONTRAINDICATIONS:**

Contraindications include, but are not limited to the following conditions:

- This is not intended to be a restrictive product, and may be easily self-released by the patient. Patients who cannot safely ambulate without assistance, or those at risk for a fall or re-injury should not use this product.
- Aggressive, combative, agitated, or suicidal patients.
- Patients with Ostomy, Colostomy, G-Tubes, Hernias, severe Cardio Obstructive Pulmonary Disease (COPD), or those with post-surgery incisions that might be compromised by the pressure from a restrictive product.
- Discontinue use immediately if the patient is able to slide forward or down underneath the device. They could slide far enough under the device to become suspended, resulting in chest compression and suffocation. Posey products with a pelvic piece are designed to help prevent sliding. Products without a pelvic piece between the legs will not hinder sliding as effectively. See your Posey catalog for other more suitable products to help prevent sliding.

**SAFETY CONSIDERATIONS:**

The Posey catalog offers "self-release" and "assisted-release" products and the doctor's order must specify exactly which product is required.

**ADVERSE REACTIONS:**

Severe emotional, psychological, and physical problems may occur if a patient's movement is severely limited. The patient may become agitated if the device is uncomfortable or severely limits movement. Request assistance from a qualified medical authority to try to find a less restrictive alternative product or intervention.

We welcome your suggestions for improving our products or service:



**Posey Co.**  
5635 Peck Road  
Arcadia, CA 91006 USA  
Tel: 1-800-44-POSEY  
Fax: 1-626-443-5014  
www.posey.com

**⚠ WARNING**

Straps should always be snug, but not interfere with breathing. You should be able to slide your open hand (flat) between the device and the patient. Loose straps may allow the patient's body to slide forward or down in a chair and become suspended in the restraint, resulting in chest compression and suffocation.

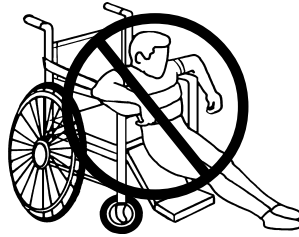

After the product has been applied, always monitor the patient appropriately per facility policy to make sure he/she is not able to slide down, or fall off the chair seat. Make sure straps are secured at a juncture of the frame and will not slide in any direction, changing position of device. If the patient's body weight becomes suspended off the chair, chest compression and suffocation could result. Restraints with pelvic pieces may be necessary to reduce sliding down or pulling the restraint off over their head.

**Laundering Instructions:**

This product was designed to be washed under CDC recommendations for linen soiled with blood or bodily fluids:

Fasten all buckles to minimize damage during wash and dry cycle.

Inspect buckles regularly and discard if cracked. Do not put buckles through extractors.

Lower temperature washing and drying cycle for non-contaminated linen will prolong product life.

The "hook" of hook and loop closure material has a tendency to collect lint after repeated use and/or laundering, reducing the grip strength of the hook and loop. Test for secure hold before each use. Discard if it does not hold securely. Occasionally go over the "hook" with a stiff brush to remove lint. Fastening the "hook" to the "loop" during laundering will also help to prevent lint buildup.

**ADDITIONAL SAFETY INSTRUCTIONS ON OTHER SIDE**

The following instructions demonstrate application on a wheelchair. For Geri-chair application, follow the same instructions attaching the belt to the chair frame behind and under the back of the seat. These products are for self-assisting patients, and are not designed to be used as restraints.

**⚠ WARNING** After applying belt, make sure it will not tighten or loosen if the chair seat or back is adjusted, changing the position or fit of the belt. See warnings to the left.

**APPLICATION INSTRUCTION: CHAIR**

**#4220 with airline buckle**

1. Remove the end of the nylon strap from the plastic slide buckle. Position the airline buckle on the wheelchair seat. Take the opposite end of the strap and thread it down between the sideskirt and wheelchair seat. Pull it through to the rear of the wheelchair. Now wrap the strap around the vertical bar located behind and under the wheelchair seat. Thread it back through the slide buckle and tighten the strap so it is secure against the bar. Make sure the slide buckle faces the inside of the wheelchair to avoid interfering with the wheel spokes. (See fig. 1)

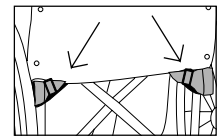
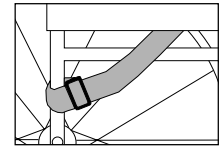

2. Repeat steps with the other strap, attaching it in the same manner to the opposite rear vertical bar of the wheelchair. (See fig. 2)
3. Position the patient/resident in the wheelchair with the hips against the back of the wheelchair seat. Secure belt around the hips using the airline buckle for attachment. (See fig. 3)

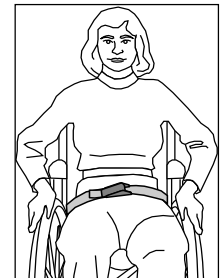

**#4222 with airline buckle**

1. Remove airline buckle from strap by unfastening snaps. From the rear of the wheelchair, wrap the strap around the vertical bar located behind and under wheelchair seat. Thread the strap back through the metal ring and pull until it is secure. Pull the strap through the space between the sideskirt and wheelchair seat to the front of the wheelchair. (See fig. 4) Reattach the airline buckle.

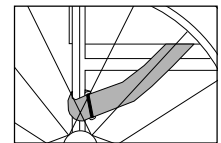

2. Attach opposite strap in similar manner with exception of airline buckle removal/reattachment. (See fig. 5)

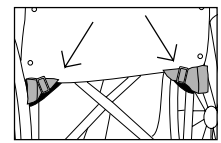

3. Position the resident/patient in the chair with their hips against the back of the wheelchair seat. Secure belt around the hips using the airline buckle for attachment. (See fig. 3)

**#4228 with hook & loop fastener**

1. From the rear of the wheelchair, attach the strap by wrapping it around the vertical bar located behind and under the wheelchair seat. Thread the strap back through the metal ring and pull until it is secure. Pull the strap through the space between the sideskirt and wheelchair seat to the front of the wheelchair. (See fig. 6) Make sure that the "hook" (rough) side of the strap is facing out so it will not touch the resident's skin.
2. Repeat this process on the other side. Make sure that the fuzzy "loop" (soft) side of the strap is facing in. (See fig. 5)

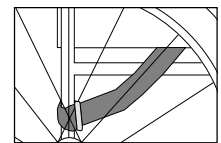

3. Position the resident/patient in the chair with their hips against the back of the wheelchair seat. Secure belt around the hips using the hook & loop closure for attachment. (See fig. 7)

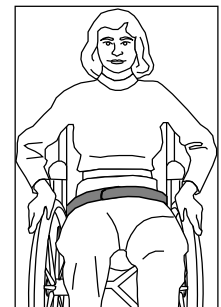



# Safety Information for the Use of Posey Torso and Limb Restrictive Products



## WARNING Monitor patients appropriately per your facility's policy!

Inappropriate and/or incorrect usage of any restrictive product may result in serious injury or death. The Posey Company recommends the following steps before any restrictive product is used:

- Identify the patient's symptoms.
- Determine and remove, if possible, the cause of the symptoms. This may include catering to individual needs and customary routines; increased rehabilitation and restorative nursing; modifying the environment; and increased supervision.
- If the cause cannot be determined and removed, attempt alternative treatments under proper medical supervision.
- A restraint should be used only when practicable alternatives have failed. The least restrictive device that will protect the patient and others should be selected and used for the shortest time while less restrictive alternatives are sought. It is critical that the appropriate restraint is selected.
- Follow the directions on the Application Sheet accompanying each product.

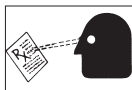

**#1 Posey restraints are labeled: Caution: Federal law (USA) restricts this device to sale by or on order of a physician.**

All staff should receive proper inservice training so products are applied in accordance with the manufacturer's instructions, state and federal regulations and the facility's policies and procedures. Posters, Videos and Inservice materials are available free from Posey Company.



**#2 Restrictive products should only be used within the carefully defined and documented parameters of the patient's Individualized Care Plan (ICP) which addresses (but is not limited to) restorative nursing, patient release, and pressure sore prevention. The ICP is created after an assessment by an interdisciplinary team which may represent (but is not limited to) PT, OT, Nursing, the Physician, and Social Services.**



**#3 NEVER use a Posey product as a seat belt in a moving vehicle.** Posey products are not designed to withstand the force of a crash.



**#4 DO NOT expose any Posey Product to open fire, flame, or contact with smoking materials.**

Components such as fabric, webbing, thread, etc. are susceptible to ignition and burning. The facility's smoking/no smoking policy should be vigorously enforced. Flame retardant fabric is available on request.



**#5 Never crisscross the straps of a Posey Vest/Jacket in back of the patient** unless there is a positioning slot in the rear of the product. Any restraint applied incorrectly and/or worn backwards may cause strangulation or injury.

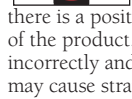

**#6 Secure straps of restrictive products out of the patient's reach at a juncture of the movable part of the bed frame at waist level so the device will not tighten or loosen when any section of the bed is raised or lowered. Make sure the strap will not slide in any direction, changing position of the device.**

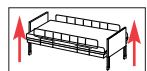

**#7 After applying a restraint or self-release product; always put all side rails in the UP position.**

Side rail covers, or gap protectors, especially with split side rails, may be required to keep the patient on top of the mattress, and avoid entrapment zones.



If the patient's body weight becomes suspended off the mattress by going under, around, over, through or between the side rails, chest compression and suffocation could result.



Restraints with pelvic pieces may be necessary to reduce sliding down or pulling the restraint over their head.

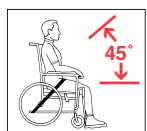

**#8 Hips should be held securely against the back of the chair whenever any type of restrictive product is used.** The straps should be at 45 degrees over the hips and secured under the seat out of the patient's reach. Make sure straps are secured at a juncture of the frame and will not slide in any direction, changing position of the device. Use extreme caution with all cushions. If dislodged, patient injury could occur. (see #9).

**#9 Monitor to make sure the patient is not able to slide down, or fall off a chair seat. If their body weight becomes suspended off the chair seat, chest compression and suffocation could result.**



Restraints with pelvic pieces may be necessary to reduce sliding down or pulling the restraint over their head.

**#10 Straps must always be snug, but not interfere with breathing.** You should be able to slide your open hand (flat) between the device and the patient. Make sure straps do not slide in any direction, changing position of device.

**#11 Always use quick-releasing ties (see drawings) or buckles to secure straps – they allow easy release in the event of accident or fire.** Restraint release should be an integral part of the facility's fire/disaster evacuation drills. Straps can be cut with scissors in an emergency.

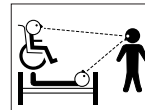

**#12 Patients in restrictive products require appropriate monitoring per your facility's policy.**

Aggressive, agitated, restless patients and/or those in danger of aspirating their vomit require constant monitoring and a systematic review and evaluation of both physical and psychological status.



**#13 Inspect before use for broken stitches or parts; torn, cut or frayed straps or fabric; or hook and loop fastener or locks that do not hold securely.**

These products could fail, resulting in injury or death. Destroy and discard them. Straps must be long enough to secure out of the patient's reach. DO NOT alter products.



**#14 Do not use Posey products on toilets, or on any type of furniture which does not allow application as directed in the product application sheet.**

Posey limb and torso restraints should NOT be used at home without constant supervision of a licensed healthcare provider, physician's order and an Individualized Care Plan.

Just as patient behavior is not 100% predictable, no product is 100% fool-proof under all circumstances. A restraint is not a substitute for good nursing care. Patient safety requires regular reassessment and appropriate monitoring per your facility's policy. A product that worked successfully in the past may prove inappropriate as the patient's mental and physical health status changes. Never apply any product you feel is unsafe and consult with the proper medical authority if you feel a product is inappropriate for the patient.

## How to Tie the Posey Quick Release Tie

1. Wrap the attachment strap once around the movable part of the bed frame leaving at least an 8" tail. Fold the loose end in half to create a loop and cross it over the other end. Make sure straps are secured at a juncture of the frame and will not slide in any direction, changing position of device.

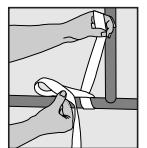

2. Insert the folded strap where the straps cross over each other, as if tying a shoe or making a tourniquet knot. Pull on the loop to tighten.

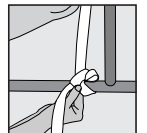

3. Fold the loose end in half to create a second loop.

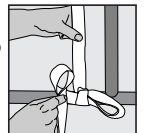

4. Insert the second loop into the first loop.

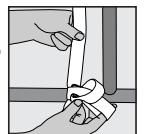

5. Pull on the loop to tighten.

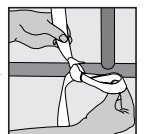

## Sizing Table for Posey Products

Always use the proper size product. Products that are too small or large compromise patient comfort and safety and should not be used.

| Binding Color | Size       | Weight (lb./kg) | Chest (in./cm) |
|---------------|------------|-----------------|----------------|
| White         | X-Small    | 60-90/27-41     | 28-34/71-86    |
| Red           | Small      | 80-120/36-54    | 32-39/81-99    |
| Green         | Medium     | 110-155/50-70   | 37-45/94-114   |
| Yellow        | Large      | 145-190/66-86   | 43-49/109-124  |
| Blue          | X-Large    | 180-230/82-104  | 47-52/119-132  |
| Black         | XX-Large   | 220-275/110-125 | 50-56/127-142  |
| Yel/Blk       | XXX-Large  | 265-305/120-139 | 54-60/137-152  |
| Blu/Blk       | XXXX-Large | 295-340/134-155 | 58-64/147-163  |

Posey belts are not color-coded, but are also sized according to this table.

Flame-retardant fabric is available on request.

Weight and size measurements give a general indication of the proper size. Individual physical characteristics should be taken into account before the medical authority determines the correct size. Refer to label on product for specific sizing indications.