

PARTS LIST

Image Number	Note	Part Number	Description	QTY per Product
1	A,B,F	226101	WELDED MAIN FRAME (570-573 B STYLE)	1
1A		501060	5/16" METAL GLIDE INSERT 570/571	4
1B		500350	GLIDE NON-SWIVEL ZINC 5/16X1" NP LN	4
2	C, D, E	501210	STAR KNOB, BLK 1/4-20 X 1 1/2" STL STUD	1*
2	F	501215	STAR KNOB, BLK 5/16-18 X 1 1/2" STL STUD	1*
3	C	226250	570 ARM COLUMN SLAT (570-575)	2*
4	D	400880	ANGLE BRACKET WITH HOLE	1*
5	E, F	701035	SQUARE INSERT W/BUTTON	1*

NOTES

Note	Description
A	Part #'s 226101 , 701035 & 501060 MUST be ordered together
B	Older versions identified in note C & D are NOT available. This frame can NOT be retrofitted.
C	Chair models WITHOUT an "A" or "B" in the serial # (EXAMPLE: 572555555)
D	Chair models WITH an "A" in the serial # AND made PRIOR to December 1st, 2008 (EXAMPLE: 573A555555)
E	Chair models WITH an "A" in the serial # AND made AFTER to December 1st, 2008 (EXAMPLE: 573A555555)
F	Chair models WITH a "B" in the serial # (EXAMPLE: 2572B555555)
*	QTY = PER ARM COLUMN

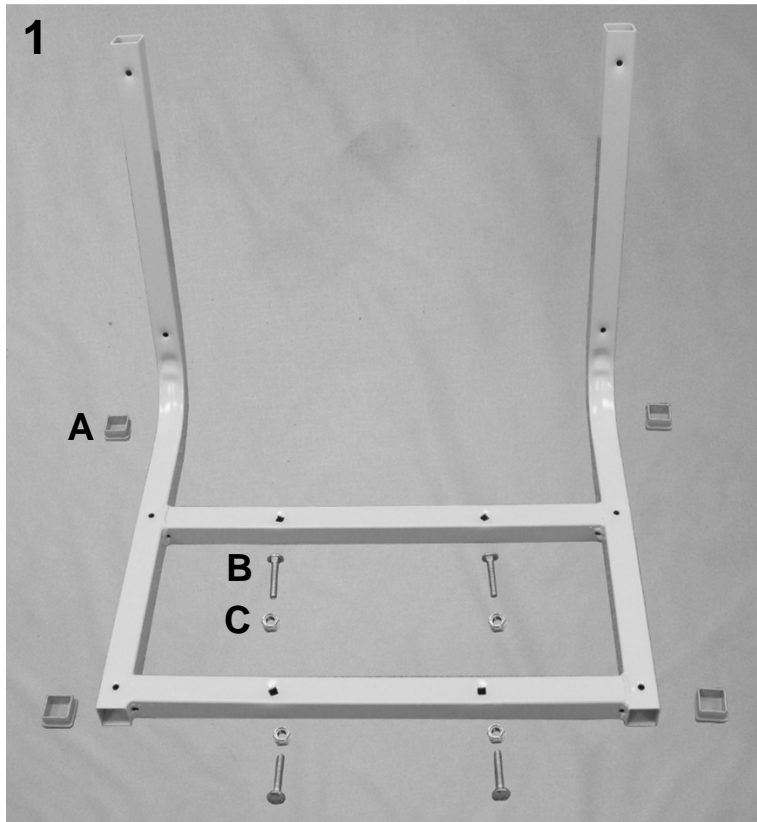

PARTS LIST

Image Number	Note	Part Number	Description	QTY per Product
1		226300K	SEAT/BACK FRAME ASSM KIT (572 STYLE)	1
1	B	226300	572/573 SEAT & BACK FRAME STL	1
1A	B	700700	SQ 1" CAP, GRAY	4
1B	B	566401	BOLT-CARRIAGE 1/4-20 X 1 1/2 ZINC	4
1C	B	566204	NUT-1/4-20 HEX NYLON LOCKNUT ZINC	4
2	A	U0250XX	572/573 UPHOLSTERED BACK	1
2		566536	SCREW-TAP 10 X 1 3/4 RND STD WASHER SQ T/S ZINC	4
3	A	U0350XX	572/573 UPHOLSTERED SEAT	1
3		566515	SCREW-MACH 10-24 X 1 3/4 PAN PHILLIP M/S ZINC	4

NOTES

Note	Description
A	XX- Use color code for specific part number i.e. 02 - Royal Blue
B	It is NOT recommended that these parts be sold seperately however in special cases they can be.
OPTIONS	For TB133 Add TB after Part Number i.e. U020702 TB

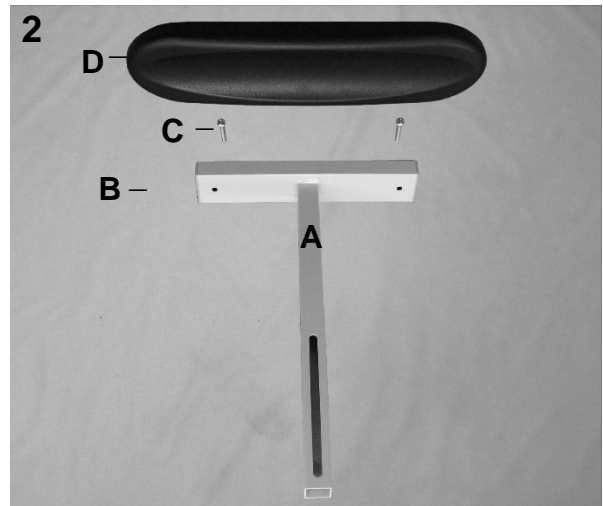
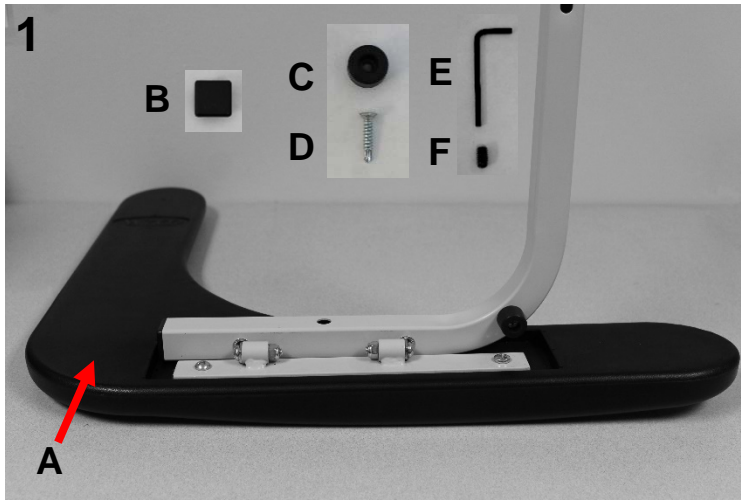

PARTS LIST

Image Number	Note	Part Number	Description	QTY per Product
1	A, B	226270K	WELDED ARM SUPPORT ASSM KIT 570,571,572,573,574,575	1
1A	A, B, D	708010	L-ARM, URETHANE, BLOOD CHAIR	1
1B	A, B, D	700700	SQ 1" RIBBED CAP, BLACK	1
1C	A, B, D	701905	RUBBER BUMPER	1
1D	A, B, D	566605	#8 X 1 WOOD SCREW, SS, FLAT HD, PHILLIPS	1
1E	A, B, D	566623	1/8 HEX KEY WRENCH	1
1F	A, B, D	566620	1/4-20 X 0.50 Set Screw, Skt, SS w-Patch Lock	1
2	C	226255K	WELDED ARM COLUMN ASSM. KIT	1
2A	C	226255	WELDED ARM COLUMN ASSM. SM URETH ARM	1
2B	C, D	701010	1X2X18 RECT INSERT CAP/GLIDE, BLACK	2
2C	C	566505	SCREW-MACH 1/4 X 20 X 1 1/4 RND PHILLIP M/S ZINC	2
2D	C	708020	ARMREST UNRETHANE, BLOOD CHAIR	1
Note	Description			
A	Used on both models - 572 & 573			
B	For ALL chair models WITH an "A" or "B" in the serial # (EXAMPLE: 572 A 555555)			
C	For 572 chair models WITH an "A" or "B" in the serial # (EXAMPLE: 572 A 555555)			
D	It is NOT recommended that these parts be sold seperately however in special cases they can be.			
	<i>Left & Right is determined - as if sitting in the chair.</i>			

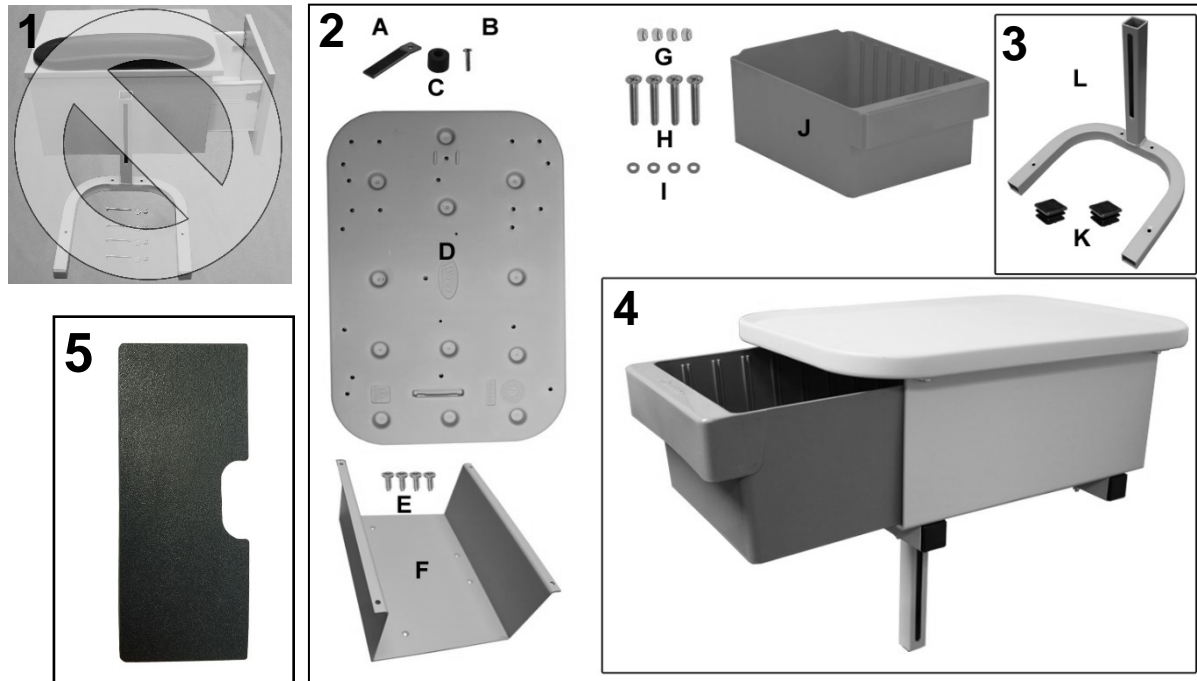

PARTS LIST

Image	Note	Part Number	Description	QTY per
1	B,C,E	267450K	CABINET KIT FOR BLOOD CHAIRS (No Longer Available)	1
1	A,B,C,G	267405	CABINET ASSM. COMPLETE (570 STYLE) (No Longer Available)	1
1	H	708020	ARMREST URETHANE, BLOOD CHAIR	1
	H	566505	SCREW-MACH 1/4-20 X 1 1/4 RND PHILLIP M/S ZINC	2
1	H	566516	SCREW-MACH 10-24 X 2 PAN PHILLIP M/S ZINC	4
1	H	566302	WASHER-#10 SAE F/W ZINC	4
1	H	566203	NUT-10-24 HEX NYLON LOCK NUT ZINC	4
1	B,C,G	226345K	WELDED CABINET SUPPORT ASSM. KIT	1
1	H	226340	WELDED CABINET SUPPORT ASSM.	1
1	H	700700	SQ 1" CAP, GRAY	2
2	G	267430	CABINET ASSEMBLED	1
2A	I	700630	DRAWER STOP 2570	1
2B	I	566628	#10-14 x 5/8" PHIL PAN HD ZINC STL THREAD ROLLING SCREW	1
2C	I	701905	RUBBER BUMPER	1
2D	I	700440	BLOW MOLD SIDE TABLE	1
2E	I	566613	#12 -11 X 1/2" PAN PHIL THREAD ROLLING SCREW, ZINC	4
2F	I	202360	DRAWER FRAME (GREY)	1
2G	I	566203	NUT 10-24 HEX NYLON LOCK NUT	4
2H	I	566574	SCREW 10-24 X 1 1/2 FLATHEAD ZINC	4
2I	I	566302	WASHER 10 SAE F/W ZINC	4
2J	I	700570	AKRO BIN	1
2K	I	700700	SQ 1" CAP, GRAY	2
2L	I	226345	WELDED CABINET SUPPORT	1
3	G	226345K	WELDED CABINET SUPPORT ASSM. KIT	1
3K	J	700700	SQ 1" CAP, GRAY	2
3L	J	226345	WELDED CABINET SUPPORT	1
4	D,F	267430K	CABINET ASSM. COMPLETE KIT	1
5	K	200580K	OPTIONAL AKRO BIN DIVIDER 6 PACK	1
NOTE			SEE NEXT PAGE FOR IMPORTANT NOTES	



Title:	2572-2573 Blood Drawing Chair Parts List	Page 5 of 7
	PL-2572-2573	Effective Date: 04/18/18 Rev. 04

NOTES	
Note	Description
A	570 Chair models WITH or WITHOUT an "A" or "B" in the serial #
B	570 Chair models with "A" in the serial # made ON or AFTER June 06, 2007 (EXAMPLE: 570 A 555555)
C	570 Chair models with "B" in the serial # (EXAMPLE: 570 B 555555)
D	570 chair models WITH a "B" in the serial # made after August, 01, 2016
E	This KIT includes everything shown in image 1.
F	This KIT includes everything shown in image 2 & 3.
G	Can be ordered as a stand-alone item
H	It is NOT recommended that these parts be sold seperately however in special cases they can be.
I	All parts included in kit 267430K
J	All parts included in kit 267345K
K	Sold as an option to the drawer. Up to 8 individual pieces available per chair.
	<i>Left & Right is determined - as if sitting in the chair</i>

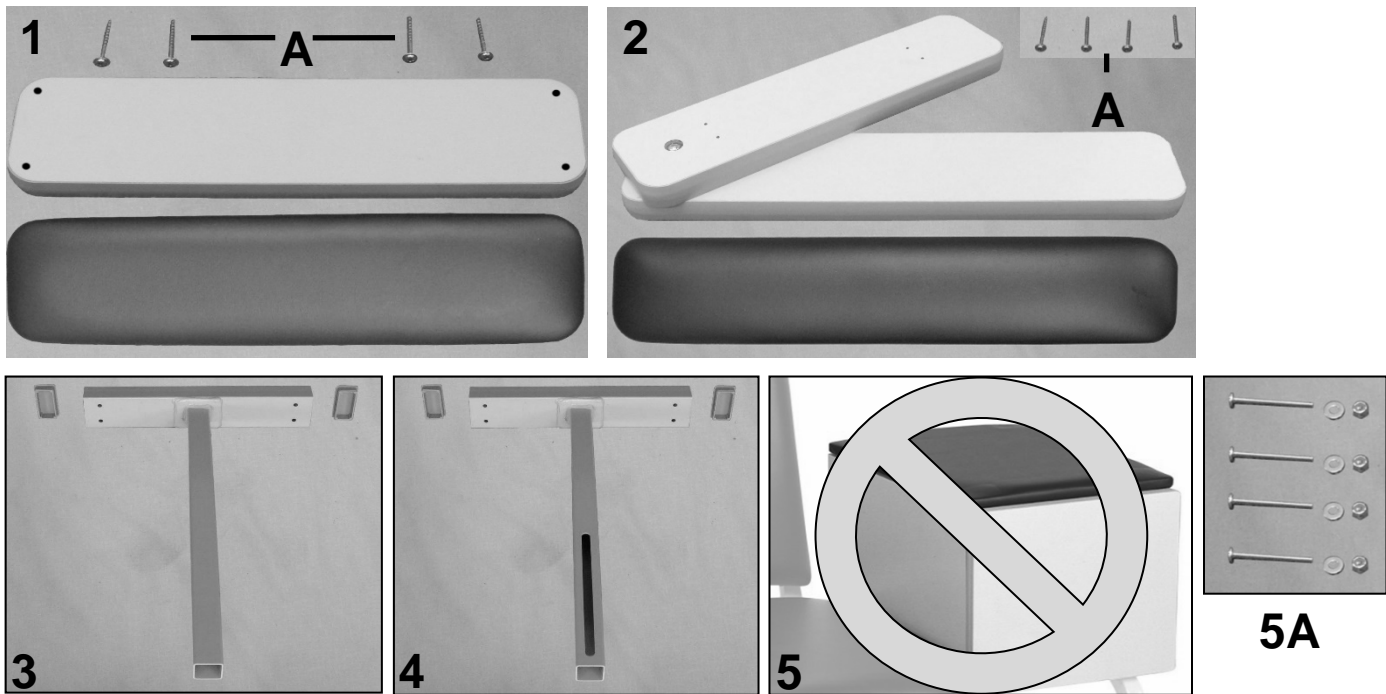

PARTS LIST				
Image	Note	Part Number	Description	QTY per
1	A,D,F	U2001XX	UPHOLSTERED STATIONARY ARM w/WOODSET	1
1A	C	566536	SCREW-TAP 10 X 1 3/4 RND STD WASHER SQ T/S ZINC	4
2	A,B,D,F	U2101XX	UPHOLSTERED SWIVEL ARM w/WOODSET	1
2A	C	566536	SCREW-TAP 10 X 1 3/4 RND STD WASHER SQ T/S ZINC	4
3	A,B,E	226200	WELDED ARM COLUMN, NO SLOT (570 THRU 575 & WOOD ARMS)	1
3	A,B,E	701010	1X2X18 RECT INSERT CAP/GLIDE, BLACK	2
4	G,H	226360K	WELDED PIVOT ARM COLUMN KIT	1
4	C	226360	WELDED PIVOT ARM COLUMN HD (574-575 STYLE)	1
4	C	701010	1X2X18 RECT INSERT CAP/GLIDE, BLACK	2
5	B,D,F	U2301XX	UPHOLSTERED CABINET PAD w/CABINET	1
5A	C	566516	SCREW-MACH 10-24 X 2 PAN PHILLIP M/S ZINC	4
5A	C	566302	WASHER-#10 SAE F/W ZINC	4
5A	C	566203	NUT-10-24 HEX NYLON LOCK NUT ZINC	4

NOTES	
Note	Description
A	For 573 chair models WITHOUT an "A" or "B" in the serial # ONLY (EXAMPLE: 572555555)
B	For 572 chair models WITHOUT an "A" or "B" in the serial # ONLY (EXAMPLE: 572555555)
C	It is NOT recommended that these parts be sold separately however in special cases they can be.
D	XX- Use color code for specific part number i.e. 02 - Royal Blue
E	Parts MUST be ordered together - See ALL parts referencing NOTE "E"
F	Uph. items are NOT available without the woodset or cabinet.
G	572 or 573 chair models WITH an "A" or "B" in the serial #. (EXAMPLE: 572 B 555555)
H	Can be ordered as a stand-alone item
OPTIONS	For TB133 Add TB after Part Number i.e. U200102 TB
	<i>Left & Right is determined - as if sitting in the chair</i>

For additional options please see: **IV POLE OPTIONS PAGE**



Title:	2572-2573 Blood Drawing Chair Parts List	Page 7 of 7
	PL-2572-2573	Effective Date: 04/18/18 Rev. 04

Revision History

REV	Effective Date	CCR Number	Description of Change
01	06/21/17	ECN 17-058	Akro bin divider changes.
02	10/27/17	ECN 17-107	Akro bin divider updates.
03	01/30/18	ECN 18-006	Update PN for new screw used in the side-table assembly.
04	04/18/18	ECN 16-191	Changes made to L-Arm assembly; pictures and parts used updated.