



North Coast

Orfitube™ Adjuster Kit

General Information

The Orfitube™ Adjuster is a special unit designed to be mounted onto a hand splint, to give the orthosis added adjustability and dynamic action. The dynamic outrigger portion of the orthosis consists of a custom fitted Orfitube™ containing elastic thread attached to a finger cuff. The outrigger is adjustable, as biomechanical alignment may change over time.

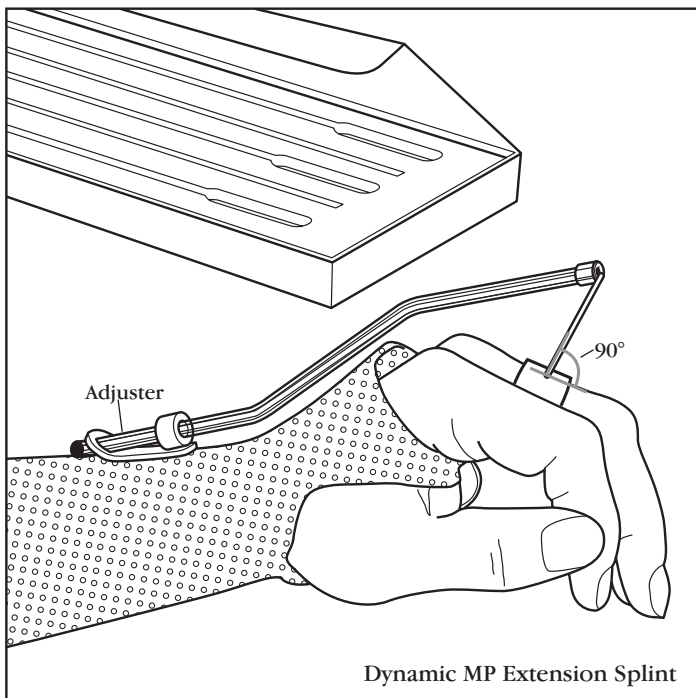

Kit Consists of:

Single Orfitube™ Adjuster	(5)
Orfitube™	(5)
Orfitube™ End	(5)
Bending Rod	(1)

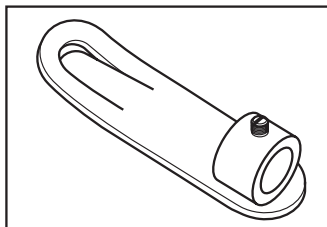

Single Orfitube™ Adjuster Consists of:

- 1) Adjusting screw (stainless steel): Secures the position of the Orfitube™ in the adjusting ring.
- 2) Adjusting ring (Polyacetal): Holds and allows alterations of the Orfitube™.
- 3) Fixation plate (Orfit®): fastens and stabilizes the Adjuster to a splint.

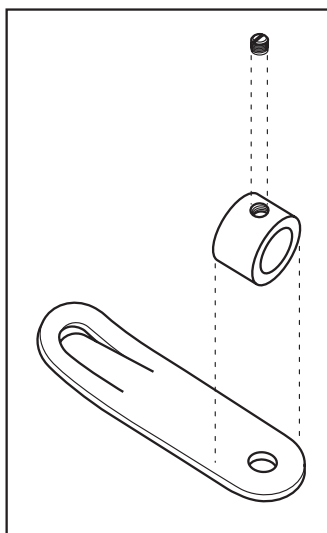

Orfitube™:

Tube (polycarbonate) into which a braided elastic or extension spring is introduced, provides a spatial suspension point for the finger.

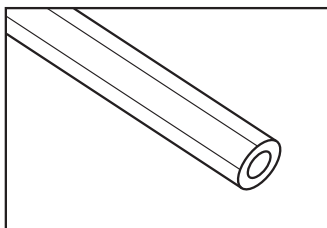

Orfitube™ End:

Metal cap (nickel-coated brass) with rounded edges to reduce friction of the elastic.

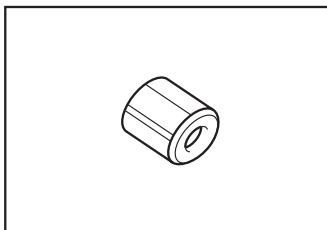

Bending Rod:

Synthetic rod used to prevent kinks from arising when the Orfitube™ is shaped.

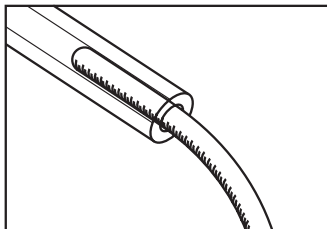

Indications

Ideal for dynamic positioning following joint orthoplasties, post tendon surgeries, and nerve injuries.

Fabrication Instructions

1. Make a thermoplastic splint (*splinting material not included*).

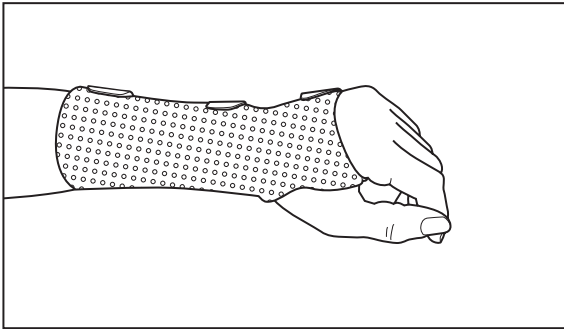

2. Determine the location and length of the outrigger needed over the involved digit.

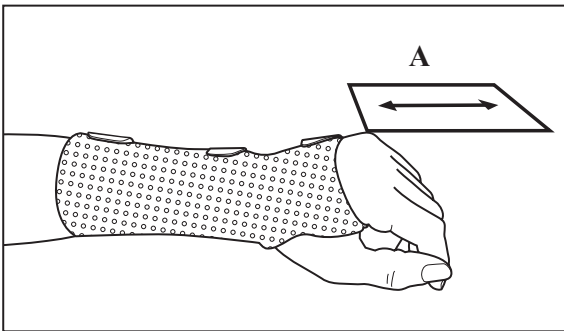

3. Find an area on the splint that can accommodate this length and is in alignment to the outrigger location.

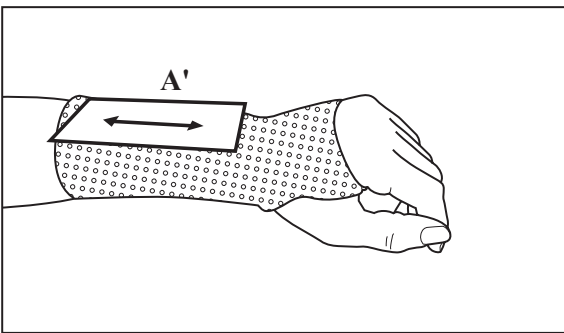

4. Feed the Orfitube™ through the Adjuster and extend it the length of the "A" area of the splint.

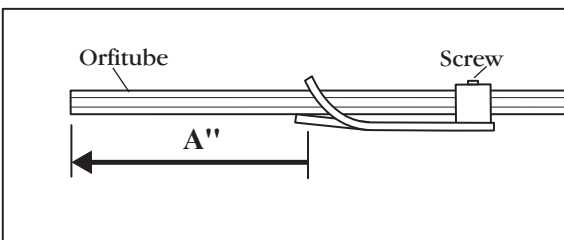

5. If the Orfitube™ will fit onto the splint without bending, fasten the screw of the adjusting ring, and skip to step #10.

6. In order to bend the Orfitube™, slide the bending rod into the Orfitube™ just beyond the adjusting ring.

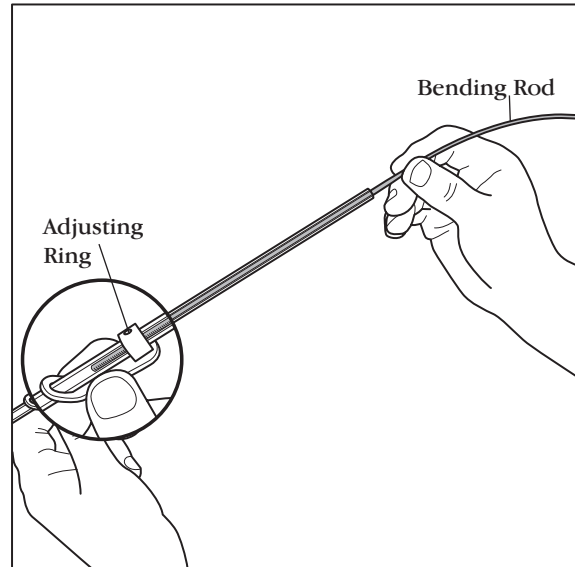

7. Bend the Orfitube™ in the area where the rod is located. This bend should match the wrist angle.

Note: The bending rod has to be inside the Orfitube™ at the bending point to prevent the Orfitube™ from collapsing. Never bend the bending rod in 2 places, as this will make it difficult to remove it from the Orfitube™. Make one bend, then slide the bending rod to the next point of bend.

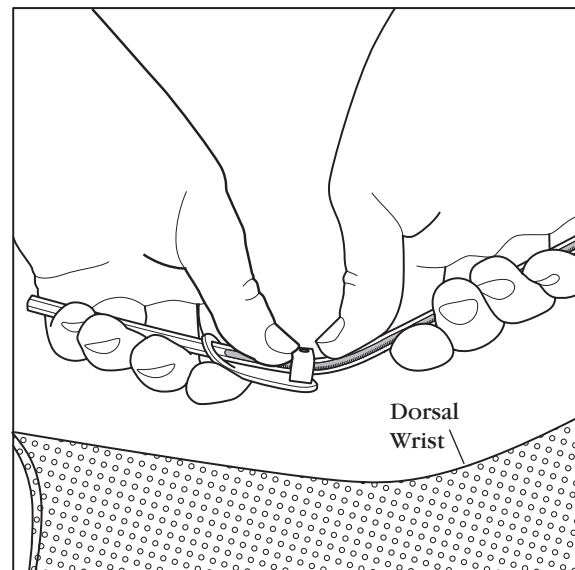

8. To bend the Orfitube™ to match the angle of the involved digit, withdraw the bending rod just distal to the joint and bend accordingly.

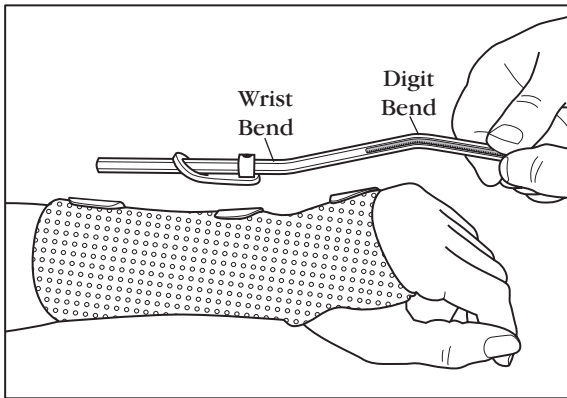

9. Completely remove the bending rod from the tube.

10. Now slide the Orfitube™ through the adjuster up to its most distal position. Remove hand from splint.

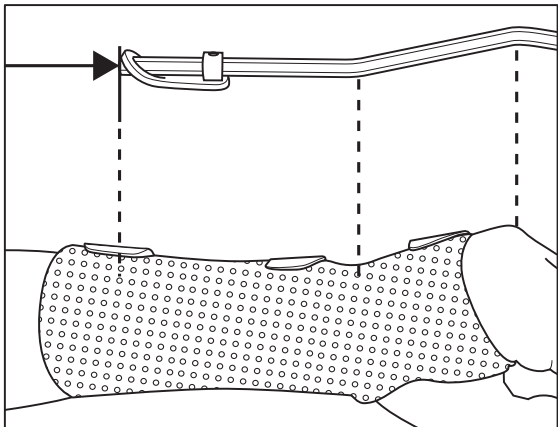

11. For a few seconds, heat the underneath of the Orfitube™ Adjuster as well as the attachment location on the splint with a heat gun (watch out for overheating). If using a coated thermoplastic splint base, use solvent first before heating.

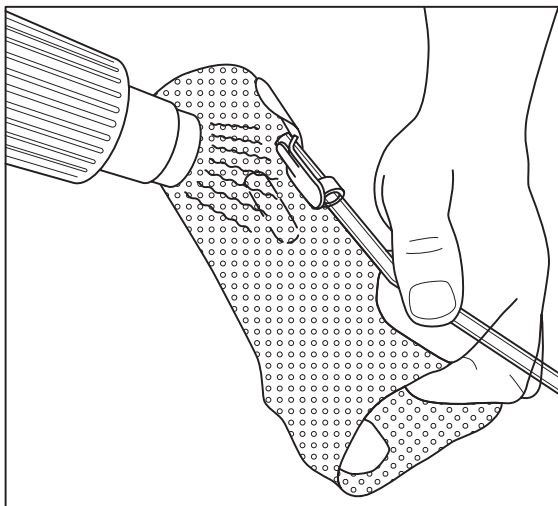

12. Firmly press the Adjuster onto the splint in the desired position and allow it to cool down completely.

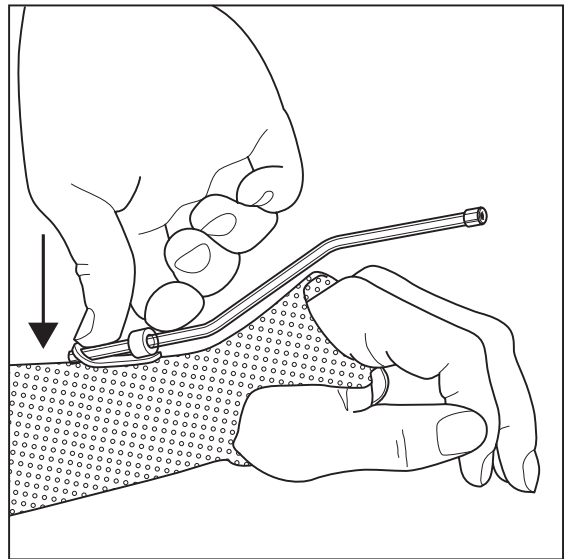

13. Cut the Orfitube™ using heavy duty scissors or by incision and breaking. The end of the Orfitube™ should be directly over the mid-shift of the phalanx distal to the involved joint.

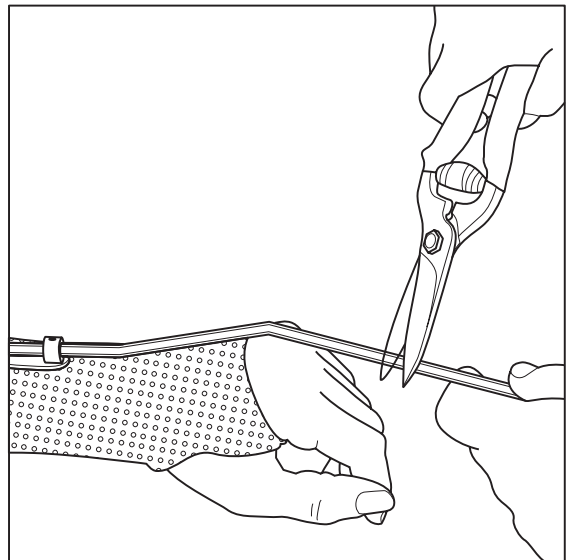

14. Press the Orfitube™ firmly onto the Orfitube™.

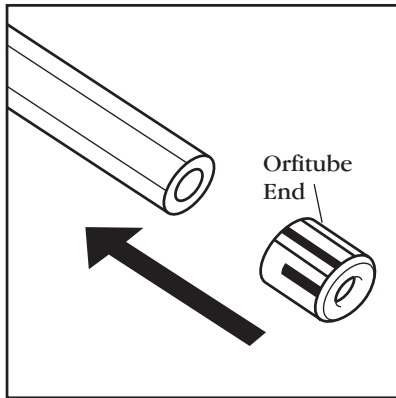

15. Feed the braided elastic cord through the Orfitube™. Attach a finger cuff to the distal end of the cord. Adjust the cord length so the cuff wraps around the mid-shaft of the phalanx. The cord should be taut and perpendicular to this phalanx while at rest.

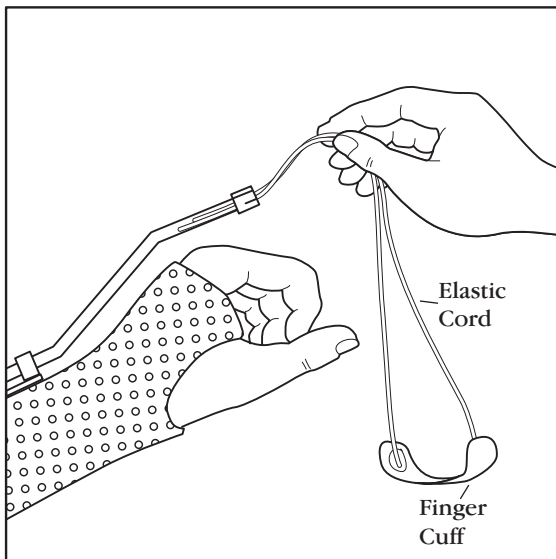

16. Once the required dynamic tension is achieved, cut and tie a large knot at the proximal end of the elastic cord to prevent the cord from slipping through the Orfitube™ and to maintain the tension in the cord.

D. Adjusting The Orfitube™

The Orfitube™ can be accurately adjusted to vary the elastic's suspension during the course of rehabilitation.

By loosening the adjusting screw, the Orfitube™ can be rotated and/or translated. (protracted/retracted for better biomechanical placement.)

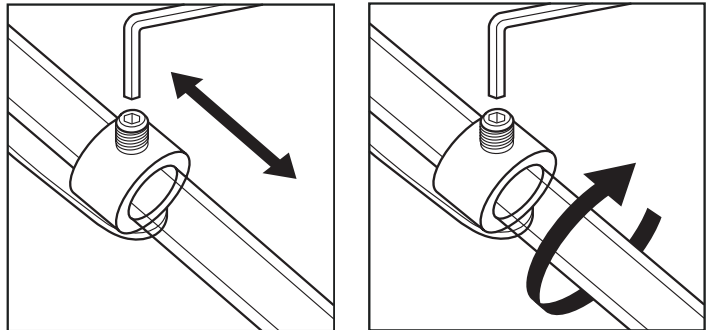

Instructions For Care

The Orfitube™ Adjuster does not require maintenance. It can be cleaned with lukewarm water and soap.

It is not possible to sterilize an Orfitube™ Adjuster in an autoclave, although it can be sterilized using gas sterilization. It can be disinfected using alcohol.

Warnings

Draw patient's attention to

- possible consequences of the incorrect action of dynamic splints.
- accidental modification of the Orfitube™ set-up,
- fixation plate or tube-end loosening.
- temperatures great than 120° F (49° C) due to melting and deformation of the splint.

Only trained medical personnel should make and apply dynamic orthosis using the Orfitube™ Adjuster.

Latex Free

To be used under the guidance of a qualified medical professional.



CE

North Coast Medical, Inc.
Gilroy, California U.S.A.
Authorised Representative
Medica Surgical Innovations Ltd.
BB2 4PB UK