

The MaxiBathe Bariatric Shower/Commode

PFA7500DX

Assembly and Instruction Manual



The MaxiBathe is a Bariatric Self-Propelled Shower Commode designed to be used either as a commode, over the toilet chair or as a shower chair. It has a Multi-Adjustable Width, ranging from 18" to 24". The large self-propelling rear wheels allow easy transporting and maneuverability. The weight capacity is 600 lbs. The MaxiBathe has sturdy, easy rotating front casters with brakes for safety. The MaxiBathe is also equipped with adjustable height swing-away footrests and an adjustable seat height function. It is ideal for use in the home, hospital or nursing home. The polyurethane cushioned seat provides clients with a soft warm seat for maximum comfort. Assembly of the chair requires no tools. The MaxiBathe is the most durable and flexible shower chair on the market.

A) Remove contents from package. The MaxiBathe is comprised of 10 parts:

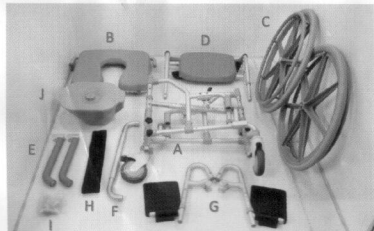

- (A) 1x main frame
- (D) 1 x backrest
- (G) 1 x footrest
- (J) 1 x pail with lid
- (B) 1 x seat frame & padded seat
- (E) 2 x armrests, 2 x screws & knobs
- (H) 1 x footrest strap

6 bolts and knobs for frame
2 bolts and knobs for armrest

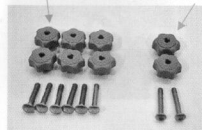

- (C) 1 set of rear wheels (2 Pcs)
- (F) 1 x footrest base frame
- (I) 6 x bolts, 6 x knobs

PHONE: 888.550.2410

EMAIL: info@platinumhealthllc.com

www.platinumhealthllc.com

B) The MaxiBathe has various adjustments for seat widths, comprising of 7 different widths. The chair's width can be modified by adjusting the following 4 components:

1. Main Frame
2. Seat Frame
3. Backrest Frame
4. Footrest Base Frame

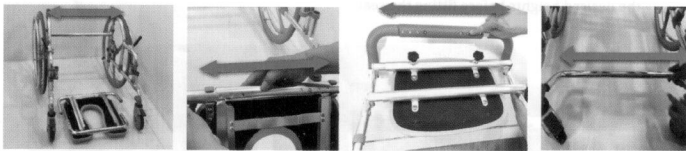

C) Each of above four frames consists of total 8 pin holes setting. Each pin hole will deliver different width size starts from 18", 19", 20", 21", 22", 23", 24" as shows per-image below. Each hole has to be adjusted in 1" increments. Clients can modify the seat width of the chair prior to assembly of the chair

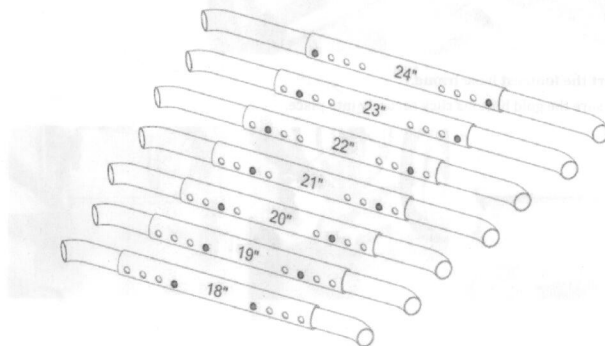

PHONE: 888.550.2410

EMAIL: info@platinumhealthllc.com

www.platinumhealthllc.com

Assembly Steps

1. Start with the frame.

It includes two front casters and the plastic joints for seat assembly. Place the commode frame on the floor and open the two sides arm supports.

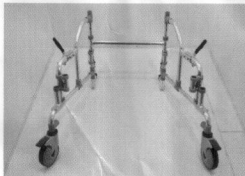

2. To avoid unnecessary movement during assembly, lock the two front casters by pushing down on the locking brakes.



3. Rear wheels assembly as per figures below:

- a. Unlock the two rear wheels by turning the lever on the left side to the upright position.

Locking position

Unlocked position

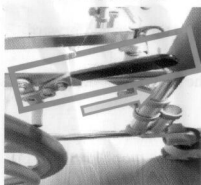

- b. Take the rear wheel and insert the axle into the receiving hole on the frame. This can be accomplished by following the steps below.



c. Loosen the black knob shown in the below figure that secure the wheel lock to the commode frame.

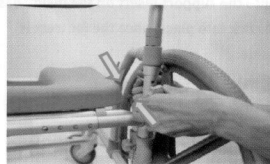

d. Insert the axle and push the wheel firmly into the hole

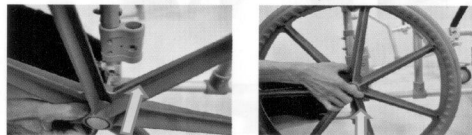

Push Lock

e. Tighten the black knob to lock the rear wheel.



Tighten Knob

f. Attach the wire pin that fitted on the frame by inserting it into the hole on the inner side of wheel lock.



Insert the wire pin

g. Repeat this step on the other side of rear wheel.

4. Seat frame assembly as per figures below:

- a. Place the padded seat on the seat frame. Position the seat over the frame and clip the seat to the frame. Please make sure the clips are properly positioned on the tubing. Take the seat frame and insert it into the four joint receptacles fitted on commode frame, as seen below. There are 2 height adjustment holes on the seat frame. Adjust the seat height to the desired heights before fitting the seat.

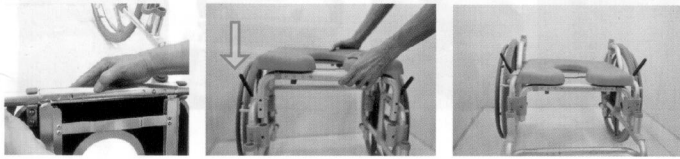

- b. Insert a bolt through the hole of the joint. Tighten a knob on to the bolt from the opposite side. Make sure the seat assembly locks securely. Repeat this step on all four sides.

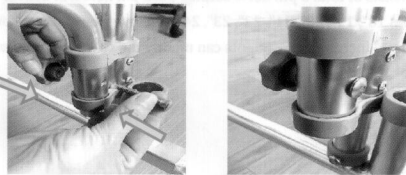

5. Insert the footrest base frame.

Make sure the gold buttons click securely into place.



PHONE: 888.550.2410

EMAIL: info@platinumhealthllc.com

www.platinumhealthllc.com

6. Assembly of Backrest

- a. Attach the backrest to the back of the chair. Insert a bolt through the hole and tighten the knob on the opposite side of the lower tube. Repeat this step on both sides. Please make sure it tightens securely.



- b. **Note:** If a client adjusts the width of the back, the back pad may be off center. If this is the case, adjust the backrest position. To perform this simply loosen the two knobs and move the backrest to the center position. Once the backrest in the center position, the knobs should be re-tightened securely.



7. Armrests assembly

Attach the armrest on each side and tighten. Do this by lining up the arm rest and inserting the knob. Tighten the knob to secure the arm rest. Perform this on each side of the chair.

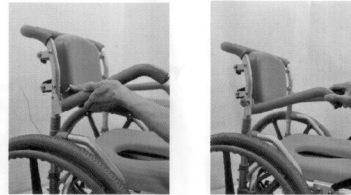

PHONE: 888.550.2410

EMAIL: info@platinumhealthllc.com

www.platinumhealthllc.com

8. Footrest assembly:

Insert the height adjustable swing-away footrest into the support insert on the inside base of the Commode frame. The spring gold button will click into place, once the footrest is properly inserted. Repeat this step on the other side.

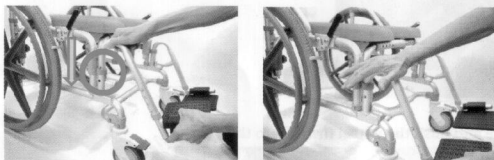

9. Attach the footrest strap

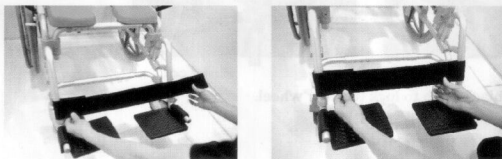

10. Remove pail lid and slide the pail underneath seat into the receptacle.



The Commode Chair will look like this once assembled



How to use the Commode

Position the Commode shower chair as close to the user as possible and lock the casters. Assist the client into the Commode by gently sitting them onto the seat. Buckle the chest strap around the front of the client for added safety. The casters can now be unlocked for transport into a shower room or designated bath area.

Safety Precautions

1. Always apply the brakes when using the chair for showering or toileting to avoid unnecessary chair movement.
2. **Do not** sit on the front edge of the seat as this will also tend to tip the chair forward
3. **Do not** use to transfer clients over raised threshold or slopes.
4. Make sure client has an upright posture and lean against the backrest.
5. Always ensure to buckle client with chest strap for safety.
6. **Do not** exceed maximum user weight 600 lbs
7. When transporting through doorways, please make sure all limbs are inside the footprint of the shower chair.
8. Use caution when operating on damp surfaces.
9. **Do not** use if a caster is damaged.
10. Supervision is essential when client is transferring on and off the chair.

Cleaning Instructions:

The Commode shower chair is easy to clean. The shower seat can be disinfected by spraying with any standard non-abrasive hospital grade hand surface disinfectant. Continue the