

LRT

“Lift - Rotate - Transfer”

Lift and Transfer System

The LRT Patient Transfer Lift, featuring a 4', 5' and 6' bi-fold articulating arm with up to a 12' range of motion, represents the pinnacle of transfer solutions. Its sleek, flexible design, effortlessly adapts to both standard and limited spaces, such as bedrooms, bathrooms, and mobile homes, while also accommodating cathedral ceilings, all without sacrificing aesthetic appeal. Skillfully crafted in America and adaptable to your selected lift and sling.

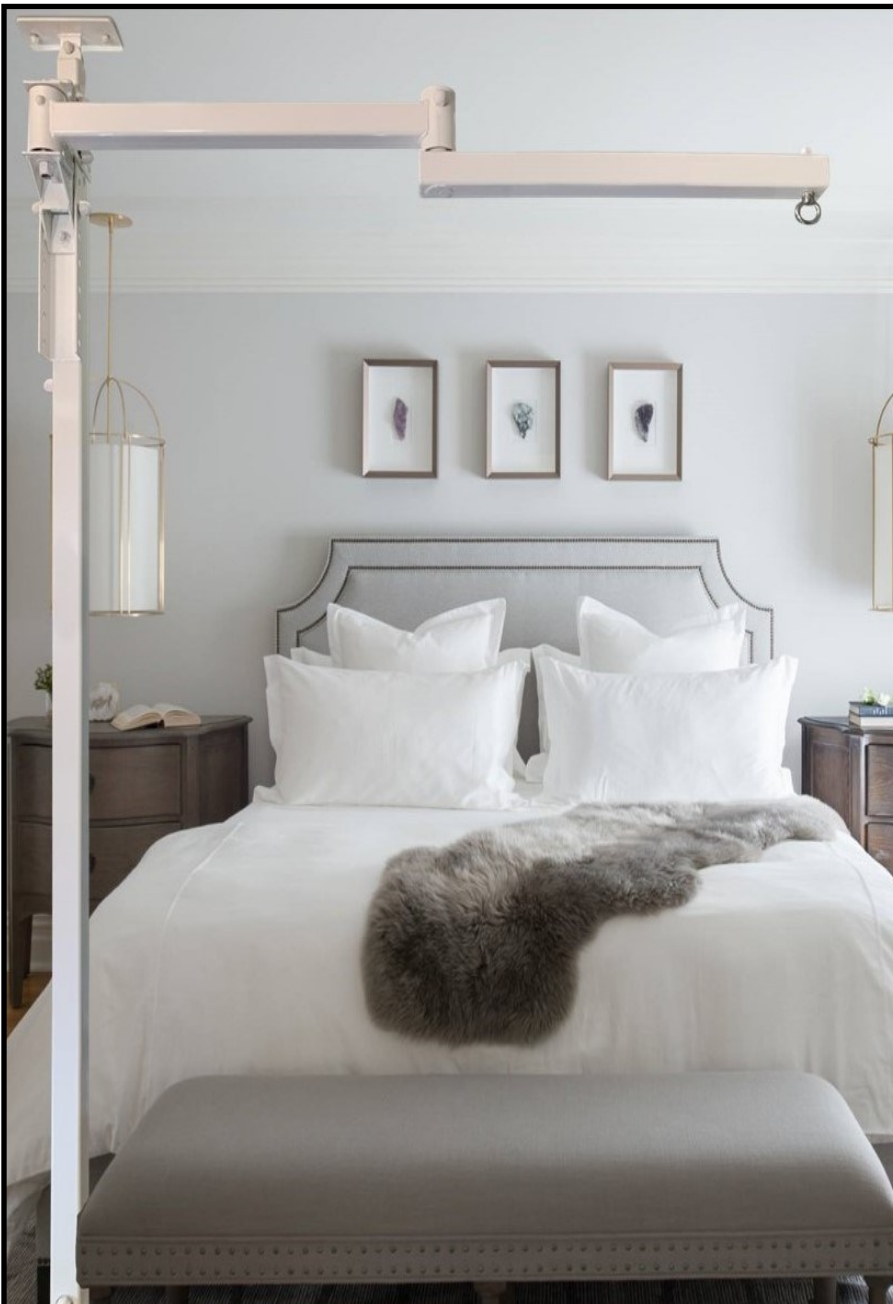

CATHEDRAL CEILINGS



MOBILE HOMES

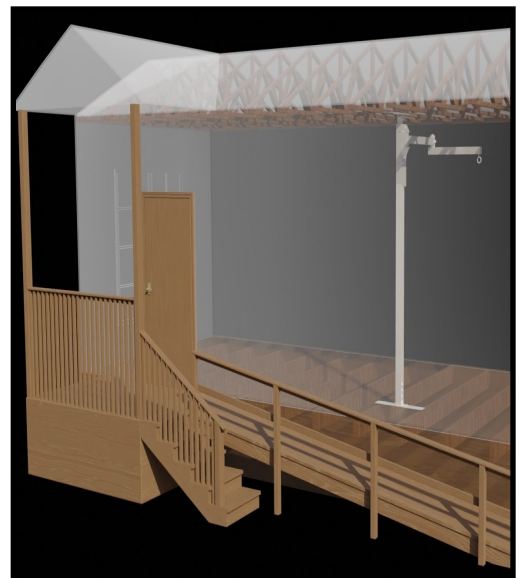

Features:

- **Lifting Capabilities:** A 440lbs/300lbs weight capacity options, reaching flat or cathedral ceilings up to 14', or a customizable height up to 16'.
- **Reach Capability:** Boasting a 360-degree rotating articulating arm, it provides an unrivaled 6' arm/12' range of motion with a lifting capacity of 300lbs, and 5' arm/10' range and 4' arm/8' range, both with a lifting capacity handling of 440lbs.
- **Multipurpose Attachments:** The LRT provides versatile mounting choices, making it suitable for a wide range of installations, such as in mobile homes, on cathedral ceilings, between ceiling and floor joists, and on walls.
- **Lifting Height:** Various base options facilitate lifting heights exceeding 9', accommodating higher elevated lifting surfaces such as beds.
- **Vertical Clearance:** Featuring a 5-position height-adjustable arm and various base options, providing maximum flexibility with vertical clearance.
- **Rotation Stops:** Adjustable rotation stops to limit arm movement individually in each direction.
- **Space Saving:** Conventional lifting systems can be imposing; the LRT design can be conveniently mounted out of the way.
- **Accelerated Setup and Mobilization:** Thanks to its efficient design, the LRT offers swift installation and relocation, arriving mostly preassembled. Minimal touchup is required if moved.
- **Fluid Transfer:** Built in swiveling eyelet to prevent the lifting strap from twisting.
- **Adaptive Solution:** You can position multiple LRTs throughout your home and easily move the portable lifting motor between them for additional transfer locations.

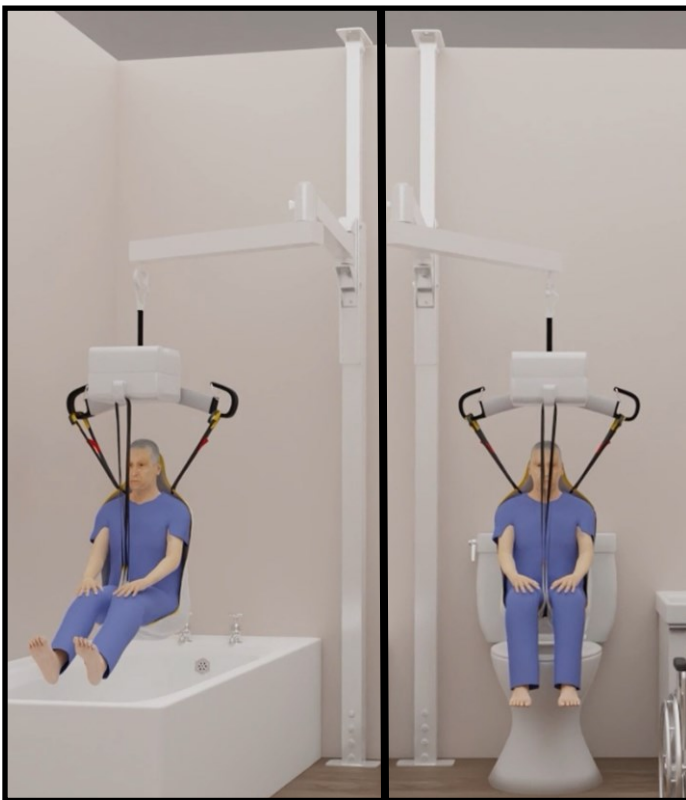

Range Of Motion: 6' Arm / 12', 5' Arm / 10', 4' Arm / 8'

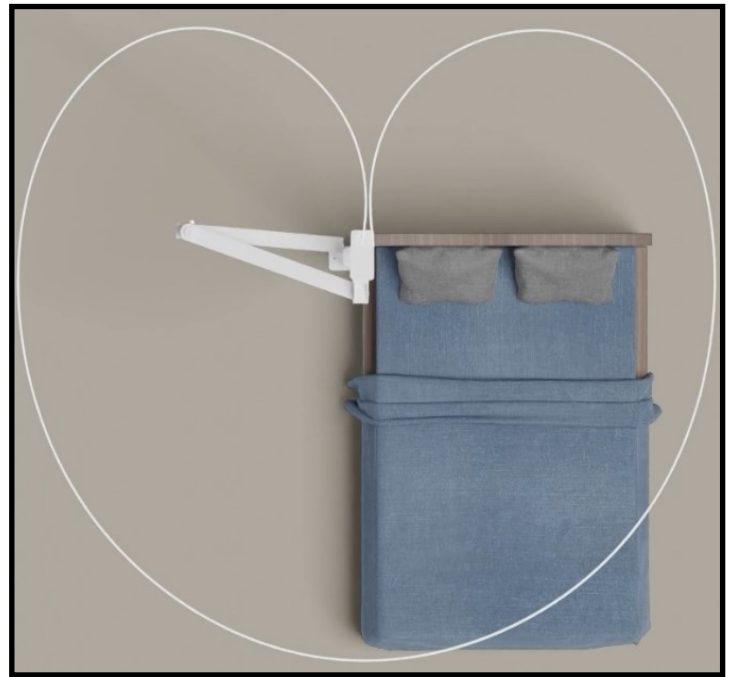
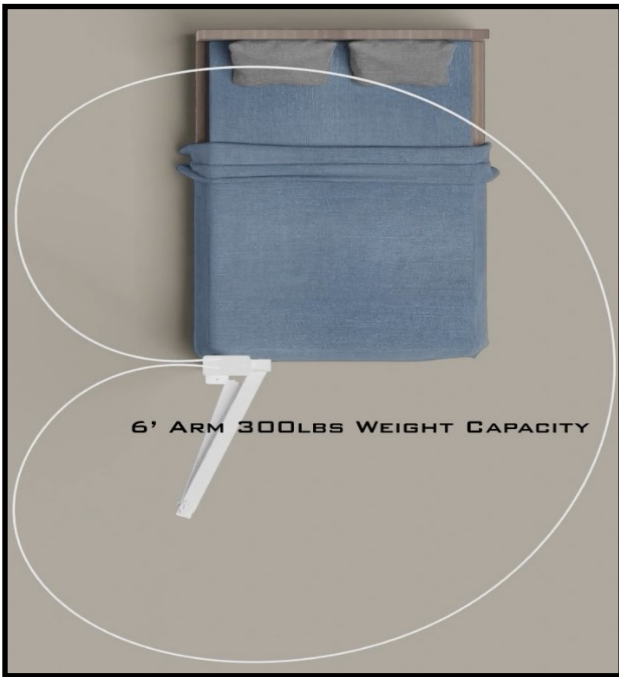

Multiple Transfer Points From One Location

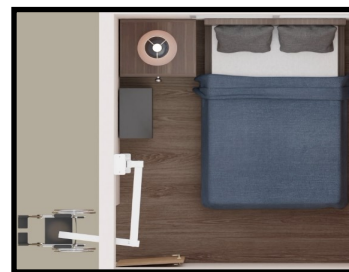
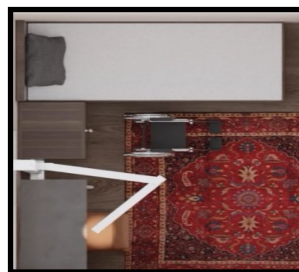
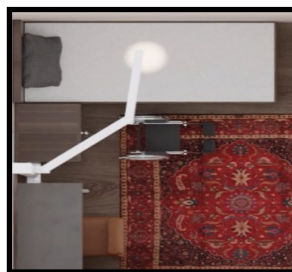
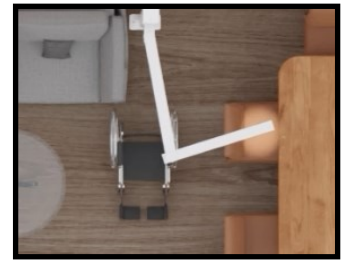
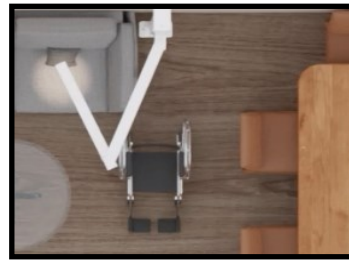
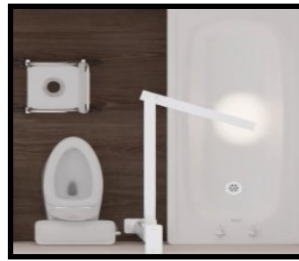
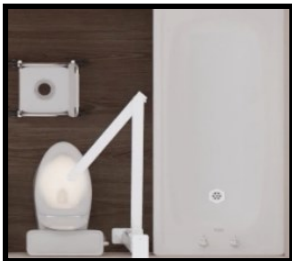

Slings

- Each LRT Comes With **Two FREE Slings**.
- Four Different Models And Fabrics. Up To XL In Size At No Cost.
- There Are Two Different Optional Models For Purchase



Portable Motors:

The LRT comes with three optional motor choices below. It designed to work with multiple manufacturers' portable motors. Regardless of the motor chosen, do not exceed the LRT's weight capacity of 300lbs. or 440lbs. The lift carabiner or reacher bar must fit securely within the 1.16" swivel eyelet. The lift motors' warranty and performance is with the lifts' manufacturer directly and not with EMR's LRT.

Three Optional Motor Choices:

Common features of all three motors:

- Come standard with a through the hand-control charger, hand-control, hanger bar, and reacher bar.
- Control buttons are located on both the motor and water resistant hand-control.
- Emergency down, soft start and stop.

The **CCP-440** is an exceptional value when lifting clearance can be met.

- 440lbs Motor capacity
- 5 year Warranty
- Eyelet to base of motor **15.5"**

The **Altair** has a very short distance from eyelet-hanger bar, making it a optimal choice in rooms with 8 feet ceilings. Be mindful of minimal lifting and surface heights with choose of motor in room with 8ft ceilings.

- Choose of 300lbs or 440lbs Motor capacity
- 2 year Warranty
- Eyelet to base of motor **11"**

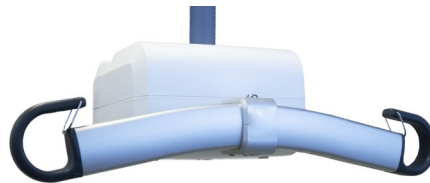

While some can install the LRT by themselves, not every contractor can. The "**LRT Install Assist**" makes it a breeze, ensuring a hassle-free, one-person installation.



Adjustable "Rotation Stops" limits arms movement in each direction.



Swivel Eyelet Opening - 1.16"
Prevent the lift strap from twisting

Basic Technical information:

LRT Warranty:	6 Year Limited Warranty
Units & Weight Capacity:	LRT with 6' Arm: 300lbs LRT with 5' Arm: 440lbs. LRT with 4' Arm: 440lbs. - Up to 16'
Affixing:	Mounting to: (1) Floor-Cathedral Ceiling, (2) Floor-Ceiling, (3) Floor-Wall-Ceiling (4) Floor-Wall
Function & Navigation:	Transfer to designated location through lifting and lowering procedures
Implementation:	Residential, Post-Acute, and, Acute

