

SLEEQ

spinal • therapy • system

INSTRUCTIONS FOR USE

SLEEQ AP SLEEQ AP+ SLEEQ APL

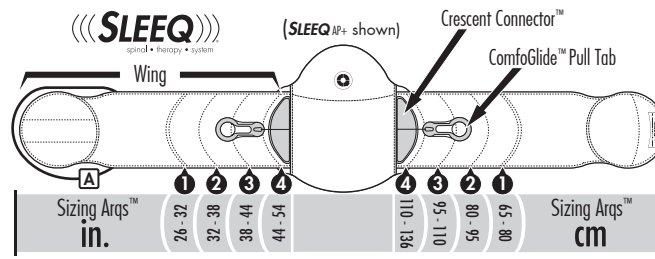

4615 Shepard Street, Bakersfield, CA. 93313, USA
800.432.3466 ThuasneUSA.com



1.0

Sizing

Determinación del tamaño

Größe

Dimensionnement

Regolazione delle dimensioni

1.1

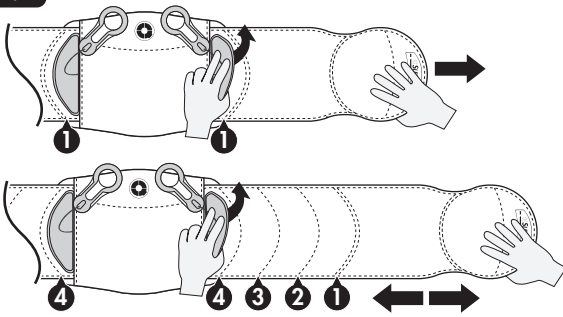

Adjust
Move right wing in or out and align Crescent Connector to appropriate Sizing Arq. Repeat on left wing.

SLEEQ adjusts to fit a vast majority of patients. Measurement is closely related to waist circumference. Four Sizing Arqs (1, 2, 3, 4) provide landmarks for waist circumference and proper alignment. These only act as guides as there is infinite adjustability and customization options within Sizing Arq range.

Ajustar
Desplace la aleta derecha hacia adentro o hacia afuera y alinee Crescent Connector con el Sizing Arq adecuado. Haga lo mismo con la aleta izquierda.

SLEEQ se ajusta de forma tal que puede adaptarse a una amplia mayoría de pacientes. La medición guarda una estrecha relación con la circunferencia de la cintura. Existen cuatro Sizing Arqs (1, 2, 3, 4) que ofrecen marcas de referencia de la circunferencia de la cintura y la alineación correcta. Estas sirven solamente como guía, ya que hay infinitas opciones en cuanto a capacidad de ajuste y personalización dentro del intervalo de Sizing Arq.

Anpassen
Bewegen Sie den rechten Flügel nach innen oder außen und richten Sie den Crescent Connector am passenden Sizing Arq aus. Am linken Flügel wiederholen.

SLEEQ kann auf die Größe der meisten Patienten angepasst werden. Die Größe ist sehr ähnlich zum Taillenumfang. Vier Sizing Arqs (1, 2, 3, 4) zeigen Markierungen für den Taillenumfang und die richtige Ausrichtung. Diese dienen lediglich als Hinweis, da der Sizing Arq beliebig verändert und angepasst werden kann.

Ajustement
Déployer ou rétracter le rabat de droite et aligner le Crescent Connector au Sizing Arq approprié. Recommencer pour le rabat de gauche.

La ceinture SLEEQ s'ajuste pour s'adapter à une vaste majorité de patients. Les mesures sont étroitement liées à la circonférence de la taille. Quatre Sizing Arq (1, 2, 3, 4) offrent des repères pour la circonférence de la taille et le bon alignement. Ils font uniquement office de guides, offrant des options de réglage et de personnalisation infinies dans les plages de chaque Sizing Arq.

Regolare
Spostare l'aletta destra verso l'interno o verso l'esterno e allineare il Crescent Connector al corretto Sizing Arq. Ripetere l'operazione con l'aletta sinistra.

Lo SLEEQ si regola in modo da poter essere indossato dalla maggior parte dei pazienti. La misura è strettamente correlata alla circonferenza della vita. I quattro Sizing Arq (1, 2, 3, 4) rappresentano punti di riferimento per la circonferenza della vita e per il corretto allineamento. Questi fungono solo da guide in quanto l'intervallo dei Sizing Arq consente infinite possibilità di regolazione e personalizzazione.

1.2

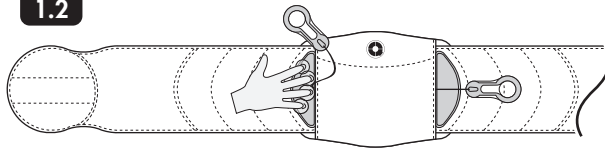

Secure
Firmly secure both Crescent Connectors to each wing. Return ComfoGlide Pull Tabs to ready position. Not quite right? No problem, re-adjust for best fit.

Fijar
Fije de forma segura los dos Crescent Connectors en cada aleta. Vuelva a poner las lengüetas de presión ComfoGlide en la posición de sistema preparado. Si el producto no se ha ajustado suficientemente bien no hay ningún problema: vuelva a ajustarlo para que se adapte lo mejor posible.

Sichern
Beide Crescent Connectors an beiden Flügeln sicher befestigen. Die ComfoGlide-Laschen auf die Bereitstellung zurücklegen. Nach nicht ganz passend? Kein Problem, zur besseren Passung neu anlegen.

Fixation
Fixer fermement les deux Crescent Connectors sur chaque rabat. Replacer ComfoGlide les languettes de tirage en position d'utilisation. Le réglage n'est pas parfait? Il suffit de recommencer pour un meilleur ajustement.

Fissare
Fissare saldamente i due Crescent Connector a ciascuna aletta. Riportare le linguette ComfoGlide in posizione di pronto. Non va bene? Nessun problema, ripetere la regolazione per una migliore vestibilità.

1.3

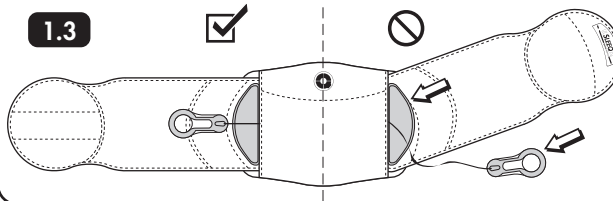

Check
Confirm Crescent Connectors are firmly secured, aligned to Sizing Arqs, and ComfoGlide Pull Tabs are in ready position.

Comprobar
Compruebe que los conectores Crescent estén fijados con firmeza y alineados con los Sizing Arqs y que las lengüetas de presión ComfoGlide estén en la posición de sistema preparado.

Prüfen
Stellen Sie sicher, dass die Crescent Connectors sicher befestigt, auf die Sizing Arqs ausgerichtet und die ComfoGlide-Laschen auf der Bereitstellung liegen.

Contrôle
S'assurer que les Crescent Connectors sont fermement fixés et alignés sur les Sizing Arqs, et ComfoGlide les languettes de tirage sont en position d'utilisation.

Verificare
Confermare che i Crescent Connector siano fissati saldamente, allineati al Sizing Arq e che le linguette ComfoGlide siano in posizione di pronto.

Care Instructions:



HAND WASH COLD



DO NOT DRY CLEAN



HANG OR LAY FLAT TO DRY



DO NOT BLEACH



DO NOT IRON

Warnings

- Carefully read use/care instructions and warnings prior to use.
- If increased pain, swelling, sensation changes, or any adverse reactions are experienced while using this product, immediately consult your medical professional.
- For single patient use only.

Contraindications:

- SLEEQ braces are contraindicated for women who are pregnant.
- SLEEQ braces are contraindicated for persons with circulatory, pulmonary, cardiovascular or other conditions where increased abdominal pressure would be of concern.

Advertencias

- Lea atentamente las instrucciones de uso y mantenimiento y las advertencias antes de utilizar el producto.
- Si experimenta más dolor, inflamación, cambios en cuanto a las sensaciones o reacciones adversas mientras utiliza este producto, consulte de inmediato a su profesional médico.
- Para uso con un solo paciente.

Contraindicaciones:

- Los aparatos ortopédicos SLEEQ están contraindicados en mujeres embarazadas.
- Los aparatos ortopédicos SLEEQ están contraindicados en personas con afecciones circulatorias, pulmonares, cardiovasculares o de otro tipo en las que un aumento de la presión abdominal pueda suponer un problema.

Warnhinweise

- Die Gebrauchts-/Pflegeanweisungen und Warnhinweise vor Gebrauch sorgfältig lesen.
- Kommt es beim Gebrauch dieses Produkts zu stärkeren Schmerzen, Schwellung, Empfindungsänderungen oder sonstigen Nebenreaktionen, wenden Sie sich sofort an Ihren Arzt.
- Nur für Gebrauch bei einem Patienten.

Gegenanzeigen:

- SLEEQ-Bandagen sind kontraindiziert bei schwangeren Frauen.
- SLEEQ-Bandagen sind kontraindiziert bei Personen mit Durchblutungs-, Lungen-, Herz-Kreislauf- oder sonstigen Beschwerden, bei denen erhöhter Bauchdruck ein Problem darstellen kann.

Avertissements

- Lire attentivement les instructions et les avertissements d'utilisation/soin avant toute utilisation.
- En cas d'augmentation de la douleur, de gonflement, de changement de sensation ou de toute autre réaction indésirable lors de l'utilisation de ce produit, consulter immédiatement le professionnel de santé qui vous suit.
- À usage unique exclusivement.

Contre-indications:

- Les ceintures SLEEQ sont contre-indiquées chez la femme enceinte.
- Les ceintures SLEEQ sont contre-indiquées chez les personnes souffrant de troubles circulatoires, pulmonaires, cardiovasculaires et autres troubles pour lesquels l'augmentation de la pression abdominale pose un problème.

Avvertenze

- Prima dell'uso, leggere attentamente le istruzioni e le avvertenze relative all'uso/alla manutenzione.
- Se durante l'utilizzo di questo prodotto, si avvertono aumento del dolore, gonfiore, alterazioni sensoriali o di altre reazioni indesiderate, consultare immediatamente il medico.
- Esclusivamente per l'uso su un singolo paziente.

Contraindicazioni:

- Il corsetto SLEEQ è controindicato per le donne in gravidanza.
- Il corsetto SLEEQ è controindicato per persone affette da patologia circolatoria, polmonare, cardiovascolare o di altra natura, e nei casi in cui l'aumento della pressione addominale potrebbe costituire un problema.

2.0

Application

Aplicación

Anwendung

Application

Applicazione

2.1

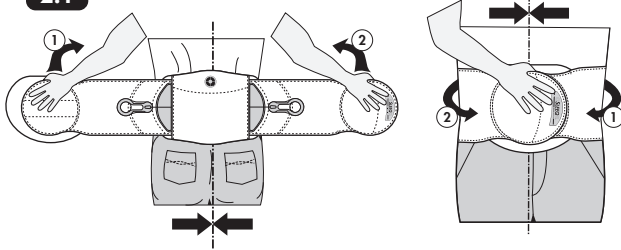

Wrap

Envolver

Anlegen

Positionnement

Indossare

2.2

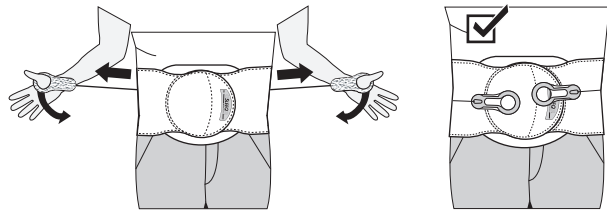

Tighten

Apretar

Anziehen

Serrer

Serrare

2.3

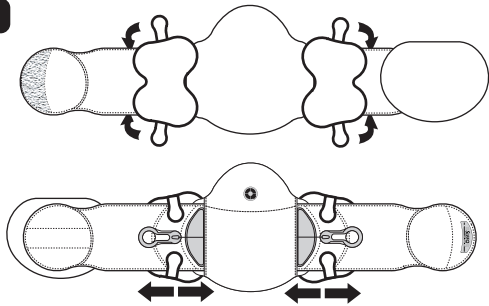

SLEEQ APL Setup
Attach lateral panels.

Preparación del APL con SLEEQ
Acople los paneles laterales.

SLEEQ APL-Einstellung
Bringen Sie die lateralen Felder an.

Installation de la ceinture SLEEQ APL
Fixer les panneaux latéraux.

Montare SLEEQ APL
Fissare i pannelli laterali.

3.0

Reset

Restablecer

Neu einstellen

Réinitialisation

Risistemare

3.1

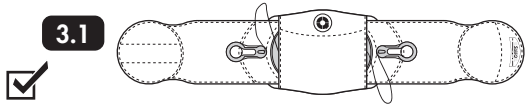

3.2

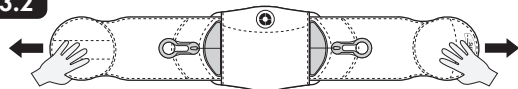

When removing SLEEQ, always return ComfoGlide Pull Tabs to ready position and then pull each Wing outward to reset the TruGlide™ Tightening mechanism.

Al retirar el aparato SLEEQ, vuelva a colocar siempre las lengüetas de presión ComfoGlide en la posición de preparado y luego presione hacia afuera cada aleta para restablecer el mecanismo de ajuste TruGlide.

Wenn Sie den SLEEQ entfernen, immer die ComfoGlide-Laschen auf die Bereitstellung legen und danach die Flügel nach außen ziehen, um den TruGlide-Feststellmechanismus neu einzustellen.

Lors du retrait de la ceinture SLEEQ, toujours replacer les languettes de tirage ComfoGlide en position d'utilisation, puis tirer chaque rabat vers l'extérieur afin de réinitialiser le mécanisme de serrage TruGlide.

Quando si rimuove lo SLEEQ, riportare sempre le linguette ComfoGlide in posizione di pronto, quindi tirare ogni aletta verso l'esterno per risistemare il meccanismo di serraggio TruGlide.

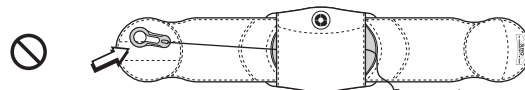

(SLEEQ AP shown)

LIMITED WARRANTY

Townsend Design warrants to the original purchaser that this product is free from defects in materials and workmanship. Normal wear and tear during the use of a product is not considered a defect. This Limited Warranty is effective from the date of delivery to the original purchaser. This warranty does not apply if this product; (1) has been altered in any way; (2) was not purchased from Townsend Design or one of its authorized distributors; (3) is not used in accordance with Townsend Design's Instructions for Use (IFU). Under this Limited Warranty Townsend Design's sole obligation shall be to repair or replace the defective product or associated part(s) at no charge. This Limited Warranty does not cover damage as a result of mishandling, accidents,

improper use or alteration of the product. This warranty is in place of all other warranties, either express or implied, including but not limited to warranties of merchantability or fitness for a particular purpose. Townsend Design shall not be liable under this or any implied warranty for any personal injury, property damage, or special, incidental, or consequential damages arising out of, related, or incidental to the use of the product even if Townsend Design has been informed of the prospect of such possible loss or damage, unless state law otherwise prohibits this exclusion. User should seek advice from their healthcare provider immediately if user encounters any kind of adverse reaction related to the use of this product. User should consult with their healthcare provider with any questions or concerns relating to the proper use of this product for their specific medical condition. IMPORTANT-Read all Instructions for Use (IFU) and any other associated materials to ensure proper use.