

Another Genuine Big John Product

BIG JOHN TOILET SUPPORT

The secure solution for supporting wall mounted toilets...



→ Wall-Mounted Toilet Supports Increases capacity to 1,000 pounds.

→ Protect yourself from liability, get the Big John Toilet Support

Height Adjustment From 7.5" to 14"



ADA Compliant Registration Number 4.23 ADAAG

Meets or exceeds

ASME / ANSI Z124.5

CSA

IAPMO / UPC



MADE IN THE U.S.A.



19" wide from Side to Side

See Our Wall-Mounted Toilet Supports on the back

Installation Instructions

 **MADE IN THE U.S.A.**

9 Easy Step-by-Step Instructions for Installing the Big John Toilet Seat

Step 1



Screw flanges all the way up so that there are no threads showing

Step 2



Hinges are marked right and left

Step 3

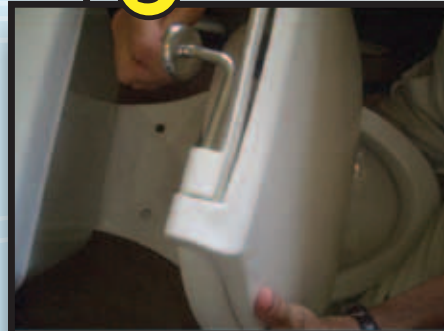

Insert the Left Hinge through the seat and lid on the Left side*

Step 4



Insert Right Hinge*

Step 5



Put on the washers

Step 6

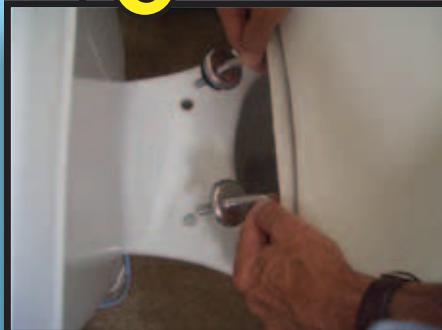

Mount on toilet and adjust flanges so bumpers are flat **See warning below**

Step 7



Be sure to put on the nuts with the beveled side up

Step 8

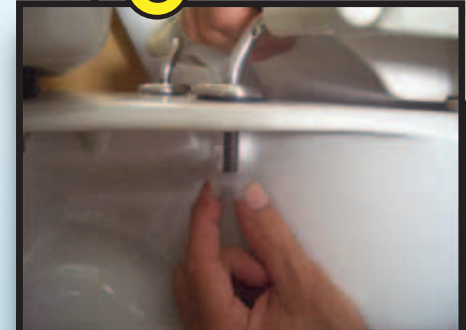

Finger tighten the nuts...make sure that the seat is mounted properly

Step 9



Secure the seat using pliers...
DO NOT OVER TIGHTEN.



*Left / Right Hinges - Refers to the left and right mounting holes on the toilet when facing it.

WARNING: ADJUST FLANGES SO THE BUMPERS SIT FLAT ON THE TOILET BEFORE TIGHTENING NUTS. Cracking or breaking around the hinges is a result of improper installation and IS NOT covered by the warranty!