



Choose versatility on the go with the HT1900 Hand Therapy Table. Optional locking casters promote easily mobility along with constant, smooth elevation to just the right height. Five top configurations, multiple table sizes, and a variety of colors to choose from gives you the choice to invest in the way you work best to change your workday.

**STANDARD FEATURES:**

- Load Capacity: 176 lbs.
- Sit or stand
- Electrical elevation: 27.875-47.625”H
- Charcoal finish on base
- Designed for therapy and rehabilitation
- (5) Top configurations
- Anti-collision safety feature
- Hand control with:
  - Constant smooth movement and soft start/stop
  - (3) Programmable memory locations
  - (2) USB ports
- Pre-assembled frame kits significantly reduces installation time
- (4) Leveling feet

# HT1900 HAND THERAPY TABLE



*HT1900-36  
with Casters*

**TABLE CONFIGURATIONS:**

**HT1900-5242 Group Therapy Table**  
52”W x 42”D x 27.875-47.625”H

Qty \_\_\_\_\_



**HT1900-36 36” Round Table**  
36”Diameter x 27.875-47.625”H

Qty \_\_\_\_\_

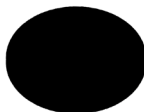

**HT1900-42 42” Round Table**  
42”Diameter x 27.875-47.625”H

Qty \_\_\_\_\_

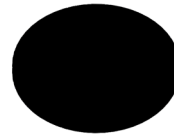

**HT1900-3636 36” Square Table**  
36”W x 36”D x 27.875-47.625”H

Qty \_\_\_\_\_



**HT1900-4836 48” Rectangular Table**  
48”W x 36”D x 27.875-47.625”H

Qty \_\_\_\_\_

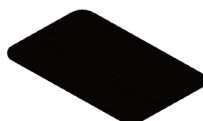

**OPTIONS:**

- RE410** - Battery
- RE470** - (4) Locking Casters (Adds 2.25" to height)

**TOP COLORS:**

-  **Brushed Concrete**
-  **Weathered Grey**
-  **Mineral Grey**
-  **Briarsmoke**
-  **White Wood Grain**
-  **Cocoa Bean**
-  **Nightshade**
-  **Sandlewood**

*\*Other top materials available upon request.*