

# Introducing the REDESIGNED



Effective January 1, 2024

## 2024 Evaluation Form



Chill-Out Chairs alternative seating system can help improve the user's positioning, providing the benefit of reduced transfers throughout the day and a comfortable seating experience. It features the redesigned, more defined reclined angle that aids in the reduction and easing of kyphosis of the occupant.

### Four-Step Order Process:

1. Select style and size.
2. Select foam package and fabric.
3. Choose accessories and foam warranty.
4. Call our team if you have any questions.

1-800-661-9915 or visit [chill-outchair.com](http://chill-outchair.com)

### Rock'er

Known for its adjustable tilt and calming rocking motion, the Rock'er can improve the alignment of users of all ages and abilities, while redistributing pressure.



### Roll'er

With a rolling wheelbase, the Roll'er can reduce the number of transfers required throughout the day – perfect for home, school or therapy settings.

The Chill-Out Chair comes standard with a multi-purpose ottoman and multi-use modular support wedge, covered in matching fabric.

### Sizing and Dimensions:

#### Recommended User Size Ranges / Chair Dimensions

Chill-Out Chair Size	Height Range (inches)	Height Range (cm)	Weight Range (lbs)	Weight Range (kg)	Overall Length (A)	Overall Height (B)	Overall Width (C)	Seat Width (#1)	Seat Depth (#2)	Seat Height (#3)	Rock'er Weight (lbs) ***	Roll'er Weight (lbs) ***
Small	40" - 52"	102 - 132	30 - 80	14 - 36	29"	33"	19"	12"	12"	26"	21	30
Medium	50" - 62"	127 - 157	55 - 120	25 - 54	34"	36"	21"	14"	14"	31"	26	37
Narrow Large	60" - 68"	152 - 173	70 - 155	32 - 70	40"	41"	22"	14"	16"	38"	33	42
Large	60" - 68"	152 - 173	90 - 175	41 - 79	40"	41"	24"	16"	16"	38"	36	46
Extra-Wide Large	60" - 68"	152 - 173	175 - 300	79 - 136	40"	46"	31"	21"	17"	38"	46	56

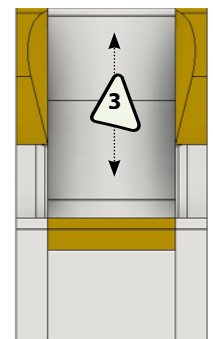
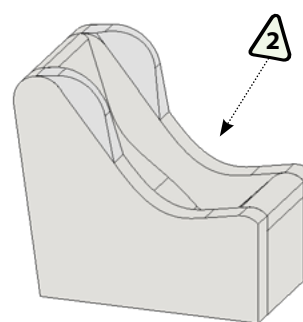
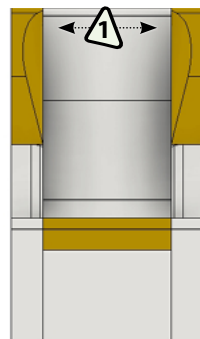

## Select Your Model (check selection)

	SMALL	MEDIUM	NARROW LARGE	LARGE	EXTRA WIDE LARGE
<b>Rock'er</b>	<b>\$2,150</b> (COCROCKRSM)	<b>\$2,500</b> (COCROCKRMD)	<b>\$2,650</b> (COCROCKRNLG)	<b>\$2,750</b> (COCROCKRLG)	<b>\$3,050</b> (COCROCKRXLGW)
<b>Roll'er</b>	<b>\$2,450</b> (COCROLLRSM)	<b>\$2,800</b> (COCROLLRMD)	<b>\$2,950</b> (COCROLLRNLG)	<b>\$3,050</b> (COCROLLRLG)	<b>\$3,400</b> (COCROLLRXLGW)

## Select Your Foam Package (check selection)

	SMALL	MEDIUM	NARROW LARGE	LARGE	EXTRA WIDE LARGE
<b>Essential</b> (Included with base price)	<b>No Charge</b> (3640121)	<b>No Charge</b> (3640321)	<b>No Charge</b> (3640521)	<b>No Charge</b> (3640421)	<b>Not Available</b>
<b>TEC Foam Package</b>	<b>\$575</b> (3640125)	<b>\$585</b> (3640325)	<b>\$660</b> (3640525)	<b>\$660</b> (3640425)	<b>\$680</b> (3640625)

Essential Foam Package	TEC Foam Package (Therapists'/Educators Choice)
Essential Foam Package is made of one density to offer great comfort and support for those 100lbs or less. <b>Included in base price of Chill-Out Chair</b>	Provides soft comfort, firm support and best durability for all user weights. It features softer foam under the knees and beside the headrest to increase comfort and eliminate pressure points. Recommended for heavier users.
Standard One-Year Warranty	Standard Three-Year Warranty

## Select Your Fabric Options (check selection) Spirit, Prairie and Seaside fabrics are included with the base price of your chair.

**Spirit Series:** Buttery soft, easy to wipe vinyl fabrics. Endurepel™ Armour topcoat protection provides an easy clean finish that has anti-bacterial and anti-mildew properties.



**Prairie Series:** Woven fabrics with a soft, dry hand and lots of visual, stylish texture. Treated with Endurepel™ Shield offering anti-stain and moisture repellent technology, combined with easy clean and odor protection properties.



**Seaside Series:** Soft and comfortable distressed suede like fabrics. Treated with Endurepel™ Shield offering anti-stain and moisture repellent technology, combined with easy clean and odor protection properties.

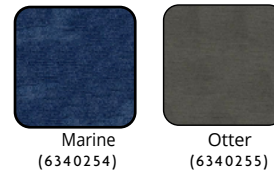

### Premium Fabrics: (check size and fabric)

**Escape Series:** Patterned and solid, intricately textured fabrics. Durable, anti-microbial and built for indoor and outdoor use. SolarShade fabrics are created with high UV rating, water repellency and anti-microbial technology.



Small	(9640221) (\$170)
Medium	(9640321) (\$215)
Narrow Large	(9640521) (\$260)
Large	(9640421) (\$260)
Extra Wide Large	(9640621) (\$285)

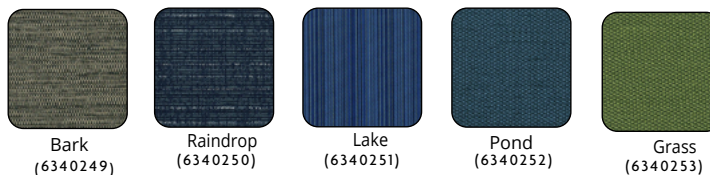

	SMALL	MEDIUM	NARROW LARGE	LARGE	EXTRA WIDE LARGE
<b>Occiput Headrest</b>	<b>\$340</b> (2640106)	<b>\$340</b> (2640306)	<b>\$340</b> (2640306)	<b>\$340</b> (2640406)	<b>\$340</b> (2640406)
<b>Activity Wedge</b>	<b>\$290</b> (2644031)	<b>\$290</b> (2644032)	<b>\$290</b> (2644034)	<b>\$320</b> (2644033)	<b>\$320</b> (2644035)
<b>Memory Foam Liner</b>	<b>\$145</b> (3640190)	<b>\$165</b> (3640390)	<b>\$190</b> (3640590)	<b>\$190</b> (3640490)	<b>\$210</b> (3640690)
<b>Medbloc Liner</b>	<b>\$290</b> (2640110)	<b>\$290</b> (2640310)	<b>\$340</b> (2640510)	<b>\$340</b> (2640410)	<b>\$340</b> (2640610)
<b>3-Piece Foam Positioning Aids</b>	<b>\$270</b> (2040750)	<b>\$270</b> (2040751)	<b>\$270</b> (2040751)	<b>\$270</b> (2040752)	<b>\$270</b> (2040753)
<b>5-Point Chest Harness</b>	<b>\$640</b> (2141071)	<b>\$640</b> (2141072)	<b>\$640</b> (2141073)	<b>\$640</b> (2141073)	<b>\$640</b> (2141074)

**New!**



**Occiput Headrest**  
Provides targeted support for the neck and head. Can be adjusted to allow for growth.

**Memory Foam Liner**  
Adds an extra layer of foam for comfort.



**Activity Wedge**  
Encourages upright positioning.

**Medbloc Liner**  
Heat-sealed liner that prevents moisture seepage and protects the hygienic integrity of the foam.

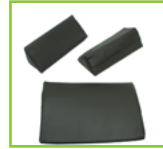

**3-Piece Foam Positioning Aids**  
Increase support and positioning with our foam positioning aids.  
**Includes the new Multi-Use Modular Support Wedge!**

**New!**

**3-Point Pelvic Positioning Belt**

Our 3-Point Padded Pelvic Positioning Belt is great for pelvic stabilization and safety, keeping the hips back in the chair.



**\$480**  
(2640041)

**Large Accessories Sleeve Pocket**

Keep all positioning aids at the ready when not in use with the Accessories Sleeve Pocket.

*Ideal for storing positioning pads.*



**\$150**  
(2640090)



**5-Point Chest Harness**  
Increase support and positioning while holding the user in the chair securely.

**Removable Abduction Pommel**

The Removable Abduction Pommel sits between the user's legs to help encourage hip abduction. The pommel is attached to the Chill-Out Chair with strong velcro straps and can be removed as desired.



**\$165**  
(2640048)

**Ottoman Support Kit**

Our ottoman support kit with multi height ottoman keeps the ottoman off the ground and allows you to roll your Chill-Out Chair with the ottoman in place.

**\*Not available in XW-LRG**



**\$200**  
(2040090)

**Pushbar**

Our Pushbar makes moving the Roller Chair from room-to-room effortless, resulting in less transfers in-and-out of the chair.



**\$265**  
(2040055)

**Small Accessories Sleeve Pocket**

Store your portable electronics, adaptive communication devices, and video players right with your chair.

**Always have them at hand!**



**\$75**  
(2040053)

**Feeding/Activity Tray**

Perfect for feeding, play or communication, the Feeding and Activity Tray is the ideal accessory to assist with individual development.

**XW-LG measures 35" across**



SM, MED, NLG, LG **\$715** (2040051)  
XWLG **\$1,455** (2040052)

**Rocking Base for Roll'er Chair**

Turn your Roll'er model into a Rock'er! Roll the Roll'er model onto the track for back-and-forth tilting motion or to add fixed tilt to the chair.

Please note, the Rocking Base requires our Ottoman Support Kit. *Some assembly required.*

**\*Not available in Small or Extra Wide Large.**



Medium **\$700** (2040041)  
Narrow Large **\$700** (2040042)  
Large **\$700** (2040043)

**Transport Chair Cover**

Bring your Chill-Out Chair wherever you go with the Transport Chair Cover that fits over both the chair and ottoman when placed on the seat. Prevents damage and protects integrity of chair when transporting.

**New!**



Small-Large **\$155** (6340700)  
XWide Large **\$200** (6340702)

WARRANTY PACKAGE	ESSENTIAL FOAM	TEC FOAM
ADDITIONAL One Year Warranty	\$125 (WARR_1YR)	\$125 (WARR_1YR)
ADDITIONAL Three Year Warranty	\$300 (WARR_3YR)	\$300 (WARR_3YR)
LIFETIME Warranty	N/A	\$450 (WARR_LIFE)

## Customizations



## Terms & Conditions

Prices and fabric colors are subject to change without notice. Prepaid or net 30 days O.A.C. All taxes extra. Freight extra. Manufacturer reserves the right to change prices, colors, features, dates, locations and products without notice. Residential delivery charge may apply. Duty and brokerage included where applicable.

CUSTOMER SIGNATURE

## Photo Release

I hereby give permission to Freedom Concepts Inc. to use photographs of me or my child for the sole purpose of the company's promotional use, and will not be distributed to third parties. YES NO

I would like to receive regular updates. MAIL EMAIL NO

SIGNATURE OF OCCUPANT/PARENT

## User Information

User Name: \_\_\_\_\_

Date of Birth: MONTH \_\_\_\_\_ /DAY \_\_\_\_\_ /YEAR \_\_\_\_\_

Height: \_\_\_\_\_ INCHES \_\_\_\_\_ CM Weight: \_\_\_\_\_ LBS \_\_\_\_\_ KG

Shoulder Width: \_\_\_\_\_ INCHES \_\_\_\_\_ CM Hip Width: \_\_\_\_\_ INCHES \_\_\_\_\_ CM

Diagnosis: \_\_\_\_\_

Purchaser Name: \_\_\_\_\_

Phone: \_\_\_\_\_

Email: \_\_\_\_\_

Address: \_\_\_\_\_

Prov/State: \_\_\_\_\_ City: \_\_\_\_\_

Postal/Zip Code: \_\_\_\_\_

## Order Information

Order Date: \_\_\_\_\_ Quote Date: \_\_\_\_\_

Chill-Out Representative: \_\_\_\_\_

Payment Terms: \_\_\_\_\_

CREDIT CARD (CHECK ONE) Visa MasterCard Exp. Date: \_\_\_\_\_

Card Number: \_\_\_\_\_

Name On Card: \_\_\_\_\_

Shipping Address: \_\_\_\_\_

Prov/State: \_\_\_\_\_ City: \_\_\_\_\_

Postal/Zip Code: \_\_\_\_\_ Federal ID/SS#: \_\_\_\_\_

## Privacy Policy

Freedom Concepts Inc. collects, uses and discloses personal information of the Customer and/or Rider to properly assemble and manufacture the mobility device and may contact the Rider's therapist for additional personal information to assist with this process. The collection, use and disclosure of the personal information of the Customer and/or the Rider is governed by any consent which may, from time to time, be provided, and by the Freedom Concepts Inc. Privacy Policy which is available on our website [www.freedomconcepts.com](http://www.freedomconcepts.com) or by contacting our office. By signing below, you hereby warrant that you have the authority to bind the Rider and hereby authorize the collection, use, and disclosure of personal information as herein provided and in accordance with the Freedom Concepts Inc. Privacy Policy.

	<b>Total - Page 1</b>	
	<b>Total - Page 2</b>	
	<b>Total - Page 3</b>	
	<b>Sub-Total</b>	
	<b>Additional Freight</b>	
	<b>Tax 1</b>	
	<b>Tax 2</b>	
	<b>Other</b>	
	<b>Total</b>	