

CARMINA

Bariatric shower commode chair



...with people in mind.

A SAFE SHOWERING SOLUTION FOR BARIATRIC CARE

Carmina is a new solution designed to improve assisted hygiene routines in bariatric environments. Safe, comfortable showering is now within reach for many bariatric residents and patients.

Obesity is recognized as a global epidemic. Healthcare environments have to rapidly adapt to the challenges of bariatric care and this is particularly urgent for hygiene procedures. The lack of suitable showering and toileting solutions for bariatric patients means hygiene routines often consist of passive methods such as bedpans and bed baths. If progress is to be made, caregivers need mechanical aids that will provide a safe working environment in wet, often slippery shower rooms.

A new alternative

Carmina is a shower commode chair designed specifically for bariatric care and creates new opportunities to considerably improve showering and toileting routines. With a safe working load of 705 lbs (320 kg), *Carmina* provides a secure platform for assisted showering. The transfer friendly design offers access methods that stimulate the mobility of many patients. *Carmina* is available in two versions, one optimized as a mobile shower chair, the other as an easily accessible bedside commode chair.

By enabling improved hygiene routines, stimulating mobility and facilitating safe, gentle handling methods, *Carmina* creates a better, safer working environment for caregivers and enhances quality of life for bariatric patients.





OPTIMUM ROUTINES FOR SHOWERING AND TOILETING

A safe solution for regular showering

Carmina is a mobile shower chair that functions as a complete solution for the showering cycle, providing secure transport to and from the shower room as well as a safe comfortable platform for showering in an upright position.

Carmina opens up opportunities for more bariatric patients and residents to enjoy regular showers with optimum showering conditions for A, B and C groups in the Bariatric Gallery. *Carmina* delivers the right support and mobility stimulation for these groups and provides a safer working environment for assisted showering in bariatric care than any other available solution.

Toileting at the bedside

Carmina Basic is designed primarily as an easily accessible bedside commode chair. It is a suitable solution for the A, B and C groups of the Bariatric Gallery. *Carmina* is designed to offer optimum transfer methods for different levels of functional mobility.

For many patients this is a superior alternative to the bedpan that offers better hygiene, stimulates mobility and helps to maintain skin integrity and normal bowel and bladder function.

When used as a mobile shower and commode chair, *Carmina* also supports toileting routines. It is compatible with most types of toilets, allowing access to toilets not built to support this patient group.

TRANSFERS

Carmina is designed to offer easy access from side or front, allowing transfer methods matched to patient's functional mobility levels – from independent access to assisted transfers with passive lifters.



- A and B patient/resident groups transfer independently or with a walking aid



- C patients/residents transfer with a sling lift. *Maxi Move* has a 500 lbs (228 kg) Safe Working Load (SWL)
- An optimum bariatric sling is an integral part of the solution



- *Tenor* (704 lbs/320 kg SWL) is designed to transfer C patients/residents

TRANSPORT

Ergonomically designed handles and push poles ensure that *Carmina* can be managed smoothly and safely during patient/resident transport.



- Pedal-operated foot support is raised for comfort during transport



- Full-length back push bar and push poles offer good assistance



- *Carmina* is easy to maneuver through doorways

IN THE BATHROOM

Carmina provides the best available solution for showering bariatric patients/residents.



- Bariatric patients/residents can be showered in a safe working environment



- The shower chair is easily pushed into position over a standard toilet



- *Carmina* integrates with flush toilets

IN THE BEDROOM

As a bedside commode, *Carmina* is accessible via a number of transfer methods, providing a safe, comfortable alternative to the bedpan.



- More dependent patients transfer with a passive sling lift



- *Carmina Basic* acts as a convenient bedside commode chair



- The commode container can easily be accessed from the top

REDUCING RISK AND IMPROVING COMFORT

Every feature of *Carmina* has been designed with the safety and comfort of the caregiver and patient/resident in mind.

Armrests

- Wide armrests provide optimum support for the resident's arms
- The armrests fold up, giving good access both for caregivers managing hygiene routines & residents making lateral transfers
- Detachable armrest covers for efficient cleaning procedures

Adjustable backrest

- Easily adjustable backrest has four positions & self-adjusting angle
- The four different seating depths provide extra support for individual needs & allow integration with most toilets

Tip-up seat

- The tip-up seat design makes cleaning/disinfection easier & provides good access to the commode container

Push poles*

- The push poles assist caregivers when maneuvering the chair
- More mobile residents can use the push poles as support when sitting down/standing up
- Poles fold away to allow easy lateral transfers for residents

Compact for storage/transport*

- The footrest folds up easily onto the seat
- A compact solution for storage & transport through narrow doorways

Self-adjusting commode container holder

- Container holder adjusts to different toilet heights

Adjustable footrest*

- Pedal-operated footrest
- Resting on the floor, the footrest acts as an extra brake providing added stability for mobile residents when sitting down or standing up
- When raised, it provides a comfortable sitting position & good access for transfers with different types of passive lifter

* Not available on Basic version



AN ACTIVE CONTRIBUTION TO BETTER BARIATRIC CARE

Carmina plays an important part in improving quality of life for bariatric patients/residents and enhancing the working environment for caregivers involved in hygiene routines.

Carmina can enhance hygiene routines in bariatric care by meeting people's different needs with optimized solutions. The hygiene requirements of a wide range of patients in bariatric environments can now be covered in a far superior way. Caregivers can work with confidence, knowing they are managing better hygiene routines and providing quality care using a safe, ergonomic system.

Whether it is used as a bedside commode chair or mobile shower chair, *Carmina* delivers a wide range of benefits for caregivers and patients/residents.

Caregiver benefits

- Safer routines for showering and toileting
- Reduced workload with manual handling
- Less risk of injury
- Improved quality of care
- A better working environment

Patient/Resident benefits

- Safe, comfortable hygiene procedures
- Solutions adapted to personal needs
- Stimulated mobility in daily routines
- Showering and toileting with dignity
- Improved quality of life

PRODUCT SPECIFICATIONS

Space Requirement

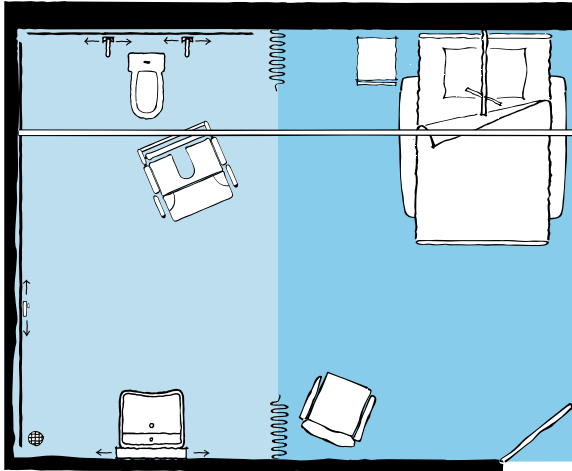

Accessories



Stainless steel commode container with lid

Mobility Gallery

Suitable for Adisa, Bob and Calvin



A Adisa, who is ambulatory and independent

B Bob, who can support himself to some degree

C Calvin, who sits in a wheelchair and has some trunk stability

For further information on bariatric design see ARJO's Guidebook for Architects™.

Product Information

Max. safe working load	705 lbs (320 kg)
Weight (Carmina)	165 lbs (75 kg)
Weight (Carmina Basic)	81 lbs (37 kg)
Total width (Carmina)	39 1/4" (997 mm)
Total width (Carmina Basic)	37 3/4" (960 mm)
Total depth (Carmina)	38 1/2" (980 mm)
Total depth (Carmina Basic)	30" (760 mm)
Total height	50" (1265 mm)
Chassis, clearance for lift legs	6 1/8" (155 mm)
Chassis, width between legs	31 1/4" (793 mm)
Chassis, clearance for toilet	18 7/8" (480 mm)
Distance from front of seat to backrest (4 positions)	16 1/2"-20 2/3" (420-525 mm)
Backrest width	29 3/8" (745 mm)
Seat width	36" (915 mm)
Footrest depth	15" (380 mm)
Low friction castors	
Turning diameter	51 1/8" (1300 mm)
Color	Blue/Grey
Approvals	CE marked. Tested by TÜV

Use only ARJO Designed Parts, i.e. parts specifically designed for the purpose, on equipment and products supplied by ARJO. Our Conditions of Sale specify that ARJO is not liable for injuries attributable to the use of inadequate parts. Continuous development is part of our policy, and we therefore reserve the right to change specifications without notice.

ARJO, Carmina, Carmina Basic, Maxi Move, Maxi Sky¹⁰⁰⁰, Tenor and Bariatric Resident Gallery are trademarks belonging to the ARJO group.

ARJO ...with people in mind.

ARJO, Inc.
50 N. Gary Avenue
Roselle, Illinois 60172
Phone: 800-323-1245
Fax: 888-594-2756
www.arjo.com

MEMBER OF THE GETINGE GROUP