

## FRAME ASSEMBLIES, MECHANICAL AND POWER COMPONENTS

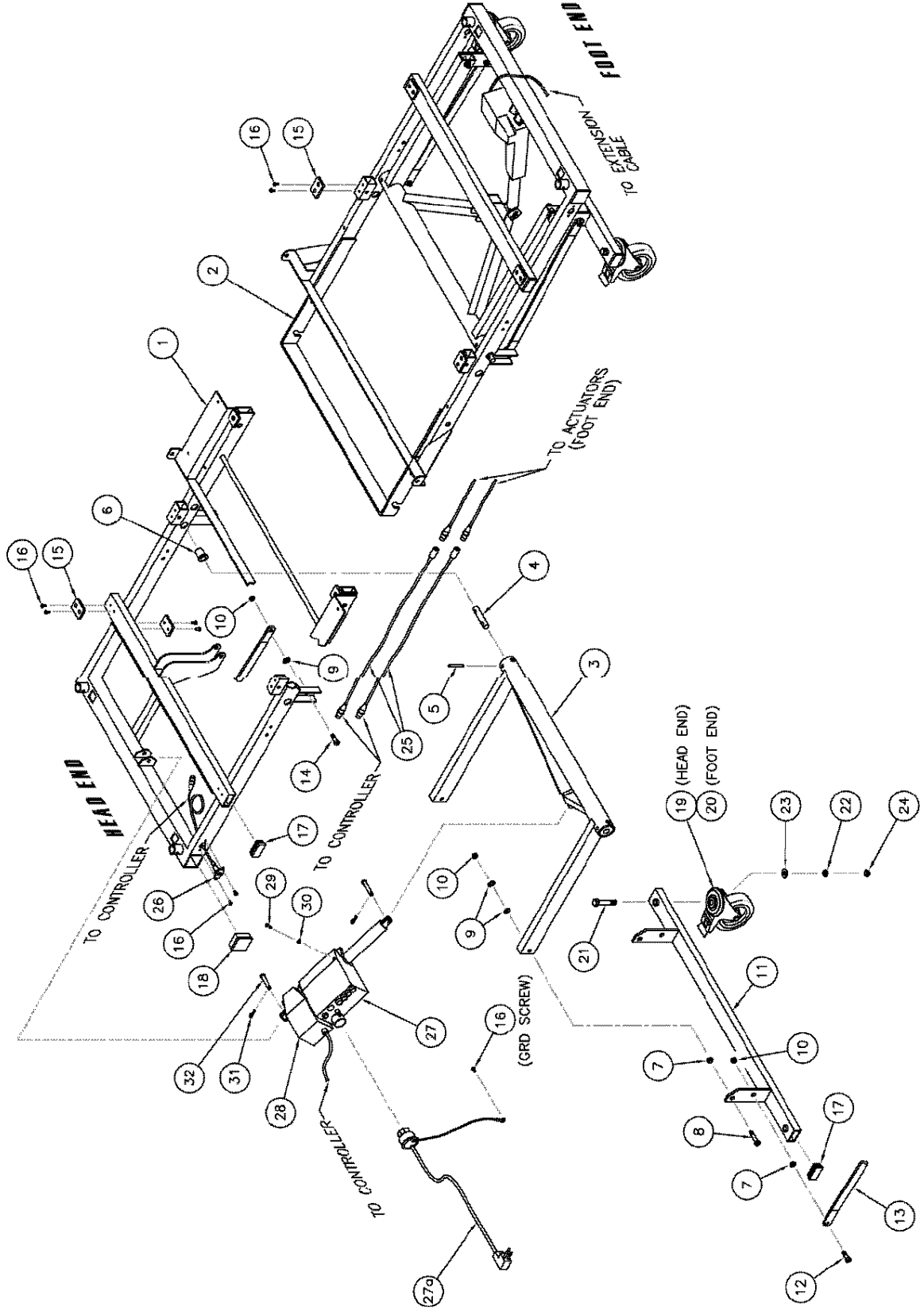

## TOP SECTIONS, HEAD/FOOTBOARDS, SIDERAILS, MECHANICAL AND POWER COMPONENTS

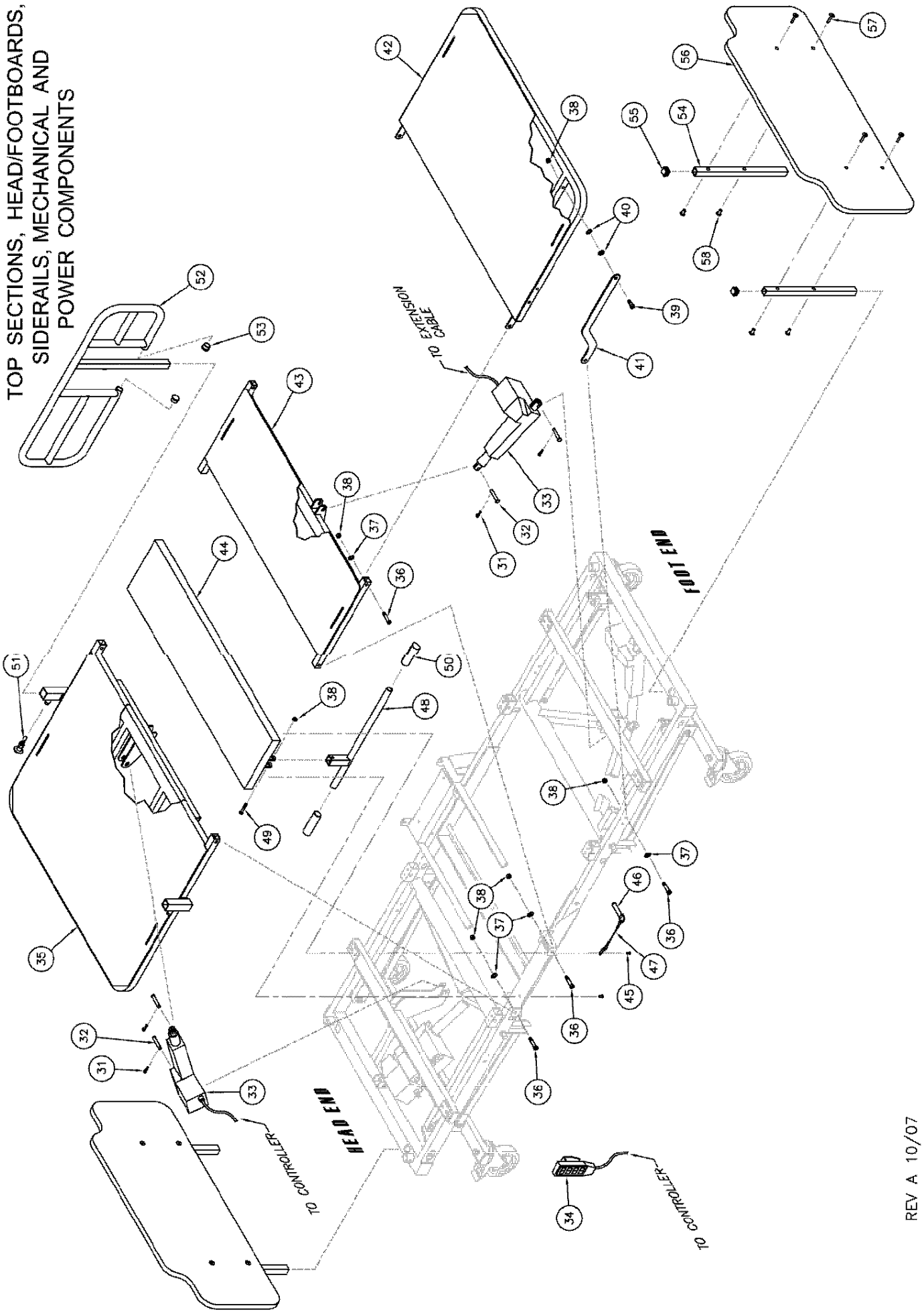

# HOMECARE BED

## MODELS: 5639 and 5648

PARTS LIST

Pg 3 of 3

REF No.	DESCRIPTION	PART No.	QTY	REF No.	DESCRIPTION	PART No.	QTY
<b>FRAME ASSEMBLIES &amp; MECHANICAL COMPONENTS</b>				<b>TOP SECTIONS, HEAD/FOOTBOARDS SIDERAILS &amp; MECHANICAL COMPONENTS</b>			
1	WLMT, BED FRAME H.E.	22200-2	1	35	WLMT, BACKREST 39" (Model: 5639) 48" (Model: 5648)	22240-1 22240-2	1
2	WLMT, BEDFRAME F.E.	22220-2	1	36	SCREW, SOC. HD. SHLDR.	P435	8
3	WLMT, LIFT LEG, HOMECARE	22270-1	2	37	WASHER, FLAT	P741	12
4	PIN, PIVOT	22226	4	38	NUT, LOCK	P547	11
5	PIN, ROLL	P511-5	4	39	SCREW, SOC. HD. SHLDR.	26059	2
6	BUSHING, BRONZE FLANGED	22286	4	40	WASHER, FLAT	P741-2	4
7	BUSHING, BRONZE FLANGED	P24056-1	8	41	LINK, FOOT SECTION	22228	2
8	SCREW, SOC. HD. SHLDR.	P435-3	4	42	WLMT, FOOT SECTION 39" (Model: 5639) 48" (Model: 5648)	22257-1 22257-2	
9	WASHER, FLAT	P741	6	43	WLMT, LEG SECTION 39" (Model: 5639) 48" (Model: 5648)	22251-1 22251-2	1
10	NUT, LOCK	P547	10	44	WLMT, SEAT SECTION 39" (Model: 5639) 48" (Model: 5648)	22221-3 22221-4	1
11	WLMT, CASTER MOUNT	22229	2	45	SCREW, PHILLIPS PAN HD. SHEET METAL	P461-1	4
12	SCREW, SOC. HD. SHLDR.	22287	4	46	PIN, SELF LOCKING	22288	2
13	LINK, LIFT LEG	22227	4	47	LANYARD, 6"	22723	2
14	SCREW, SOC. HD. SHLDR.	26059	4	48	WLMT, LIFT HANDLE	22231	1
15	SPACER, DELRIN	22655	10	49	SCREW, HEX. HD. CAP	P385-1	1
16	SCREW, PHILLIPS PAN HD. SHEET METAL	P461-1	23	50	GRIP, GREY HAND	P135	2
17	CAP, 2" x 1" BLACK PLASTIC	P162	8	51	ASSEMBLY, RELEASE PIN	RS9154	2
18	CAP, 2" x 2" BLACK PLASTIC	22285	4	52	WLMT, SIDERAIL	22009-2	2
19	CASTER, 5" BRAKE & SWIVEL LOCK	20557	2	53	CAP, 1" DIA. BLACK PLASTIC	P163	4
20	CASTER, 5" SWIVEL LOCK	20557-4	2	54	TUBE, HEADBOARD MOUNT	22413	4
21	SCREW, HEX. HD. CAP	P422-1	4	55	CAP, 1" SQ. BLACK PLASTIC	P152	4
22	WASHER, LOCK	P760	4	56	HEADBOARD, WOOD 39" (Model: 5639) 48" (Model: 5648)	22218-1 22218-2	
23	WASHER, FLAT	P638-1	4	57	SCREW, JOINT CONNECTOR	P556	8
24	NUT, LOCK	P543	4	58	NUT, JOINT CONNECTOR	P557	8
<b>POWER COMPONENTS</b>							
25	CABLE, EXTENSION	22266	2				
26	CABLE, BATTERY EXTENSION	22289	1				
27	CONTROLLER	20552	1				
27a	CABLE, POWER W/ GROUND	20552-1	1				
28	ACTUATOR, 250mm	20550	2				
29	SCREW, PHILLIPS PAN HD. PLASTITE	20569	1				
30	WASHER, INTERNAL TOOTH STAR	P754	1				
31	RUE RING	26061-2	8				
32	PIN, CLEVIS	P20430-5	8				
33	ACTUATOR, 150mm	20551	2				
34	HANDSET	20553-1	1				

### INSTRUCTIONS FOR ORDERING PARTS

In addition to the Part(s) you require, specify Model Number of your Bed. On Left or Right hand parts, be sure to include the Suffix "L" for Left or "R" for Right with Part Number (Left and Right Hand can also be determined as you are positioned in the Bed)