

Midline Joystick Mounting Kits

INSTALLATION AND USER'S INSTRUCTIONS

ART NOS. PC202, PC205, PC206 & PC207

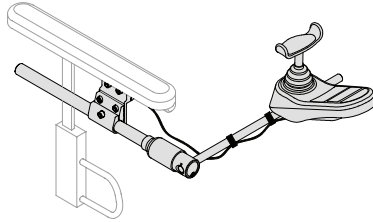

These instructions provide important information for the safe use and maintenance of all Bodypoint Midline Joystick Mounting Kits. Give these instructions to the user or their caregiver and review them to ensure that they are understood.

⚠ CAUTION! Turn off wheelchairs electrical system before installation.

⚠ WARNING! If a serious incident occurs related to the use of this product, it should be reported to the manufacturer (Bodypoint, Inc.) and the local Competent Authority.

MAINTENANCE: To ensure smooth rotation, the PC024 Rotating Shaft should be checked annually for lubrication by sliding back the rubber protective boot (sleeve), as shown in these instructions. Apply a small quantity of medium-viscosity PTFE (Teflon) bearing grease to the slot, and slide the rubber protective boot back into place. No maintenance is necessary on other components.

PERIODIC SAFETY AND PERFORMANCE CHECKS:

To ensure user safety, this product must be checked periodically for function and signs of wear. If the product does not function correctly or if significant wear is found, stop using it and contact your supplier for qualified repair or replacement by Bodypoint. Under no circumstance should this product be altered or repaired by unqualified persons — health and safety depend on it!

SCRAP/DISPOSAL: Product is made of materials which can be disposed of safely without special precautions at the end of its useful life.

WARRANTY: This product carries a limited lifetime warranty against defects in workmanship and materials arising under normal use by the original consumer. Contact your supplier or Bodypoint for warranty claims.

PACKAGE CONTENTS

Package may contain one or more of the following:

- Joystick Mounting Clamp
- Tri-Lock™ Rotating Shaft
- Midline Arm
- Joystick Mounting Adapter
- Quick Release Lever (Optional) or a complete joystick Mounting Kit. Art PC202-, PC205-, PC206-, PC207-

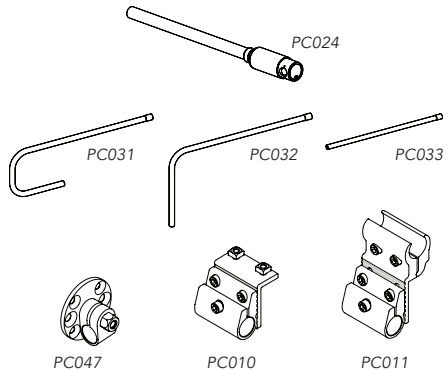

PC042



PC045



PC046



PC047



PC010

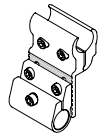

PC011

JOYSTICK MOUNTING CLAMP

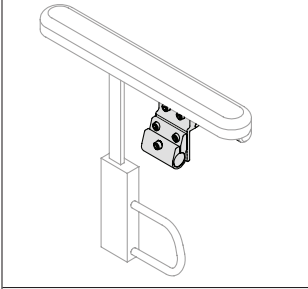

Joystick Mounting Clamps can be installed on the right or left side. Attach clamp to armrest. Position the clamp as far forward as possible and tighten.

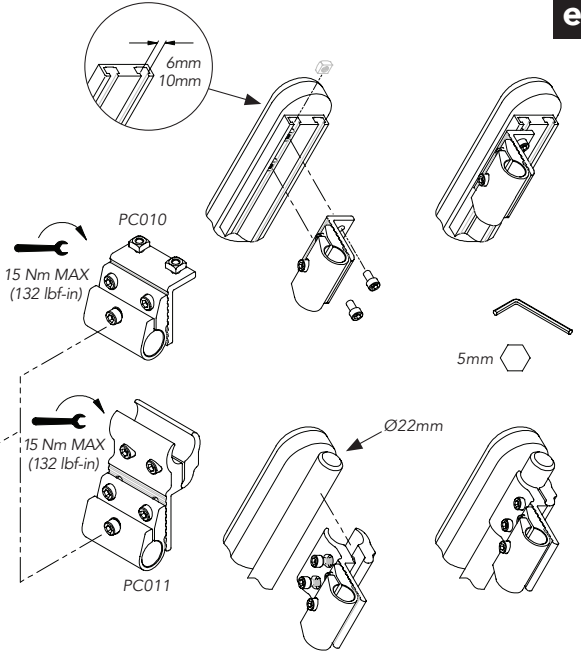

Art. No. FA171

TRI-LOCK™ ROTATING SHAFT

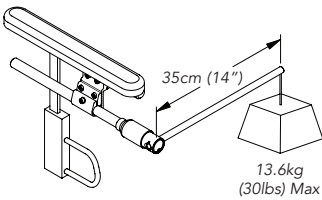
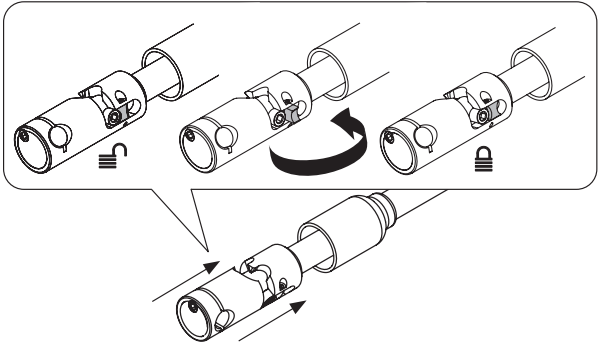
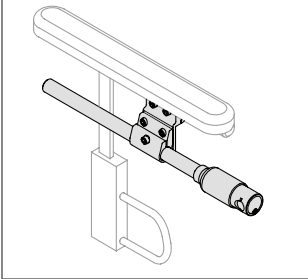

Tri-Lock Rotating Shaft is compatible with right or left side mounting. Rotate Shaft in Mounting Clamp to ensure correct positions of rotation.

The Flip-stop allows conversion from non-locking to locking. 0° horizontal position becomes locked. Press end to unlock.

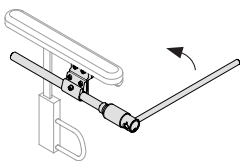

0° Driving Position

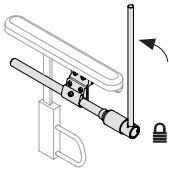

Vertical

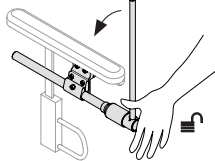

Press end to unlock

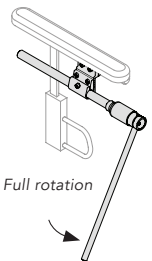

Full rotation

MIDLINE ARMS

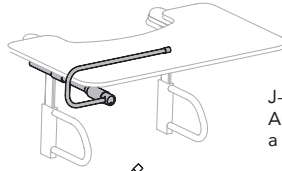
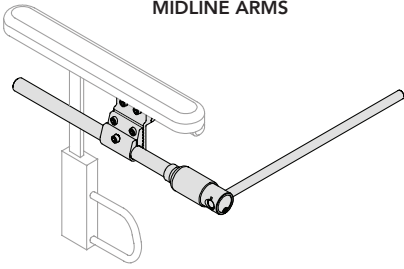

J-Shaped Midline Arm allows use over a lap tray.

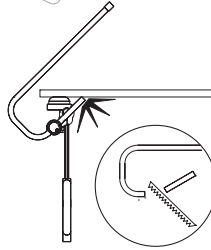

NOTE: The Midline Arm can be cut to length using a hacksaw or tube cutter.

JOYSTICK MOUNTING ADAPTERS

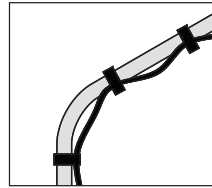
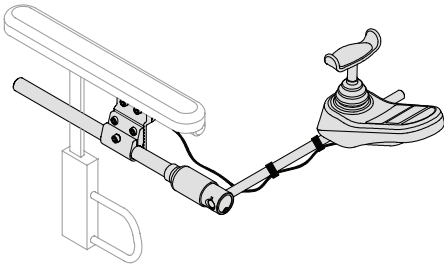

Attach loose wires with nylon ties included.

INVACARE

Art. No. PC042

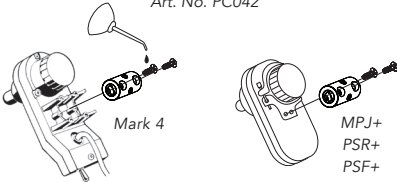

Mark 4

MPJ+
PSR+
PSF+



1/2" (12mm)



3/8" (10mm)



1/8"

#2 Phillips

PGDT R-NET & VSI

Art. No. PC046

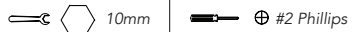
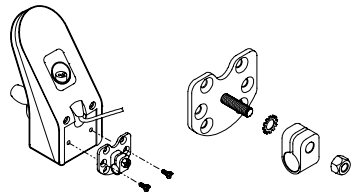

10mm

#2 Phillips

PGDT PILOT PLUS

Art. No. PC045

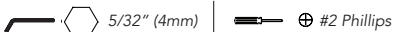
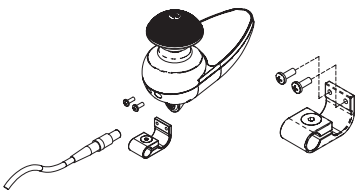

5/32" (4mm)

#2 Phillips

COMPACT JOYSTICKS

Art. No. PC047

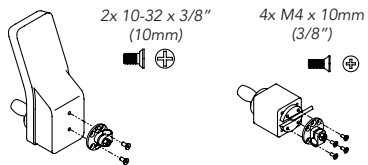

2x 10-32 x 3/8" (10mm)

4x M4 x 10mm (3/8")



#2 Phillips

10mm