

6000 Series
Work Simulation Devices
Product Manual

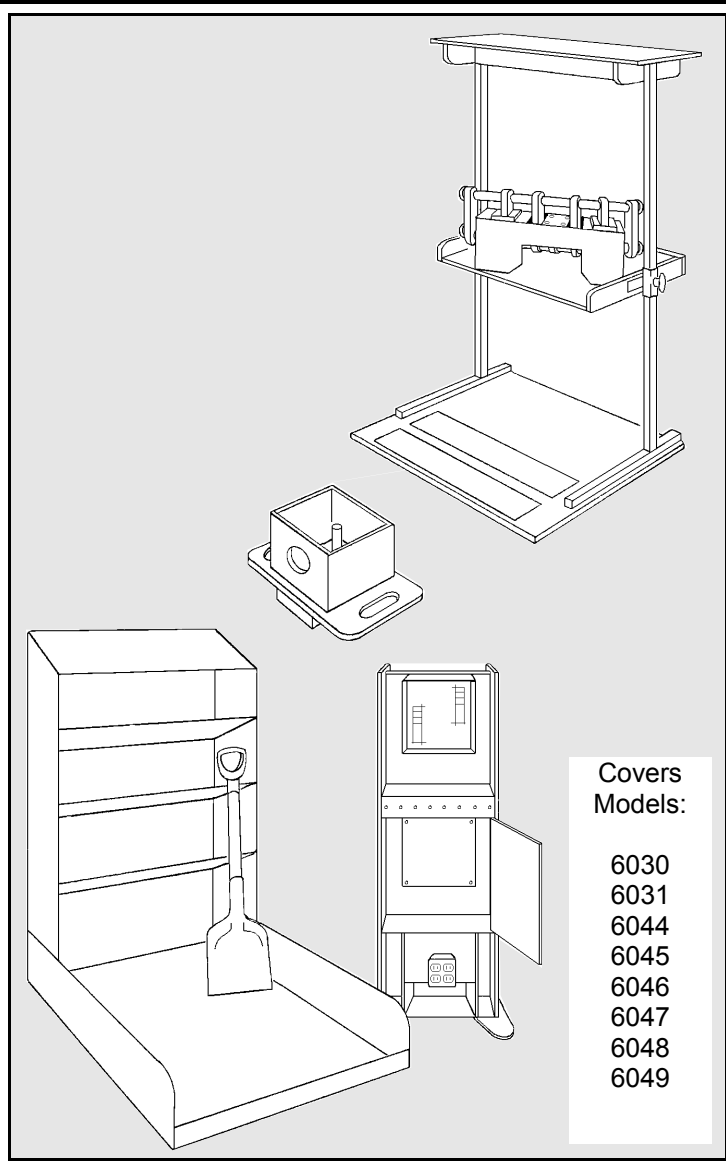

Covers
Models:

- 6030
- 6031
- 6044
- 6045
- 6046
- 6047
- 6048
- 6049

FERRELL

Important Read This First

Bailey Manufacturing Company is proud of the reputation we have earned as a leader in the physical, occupational, and sports medicine industry for more than 50 years. Our products are made from the highest quality materials and built in the USA by skilled craftsmen.

Prior to shipping, this product was thoroughly inspected to ensure the highest quality standards and your total satisfaction. If you experience any problems, please follow the instructions outlined in the Warranty & Support Section of this manual. Contact either your dealer or Bailey at 1-800-321-8372.

Please take a moment now and record the following information for future reference:

<i>Date of Purchase [delivery date]:</i>
<i>Bailey Dealer:</i>
<i>Packing Slip #:</i>
<i>Serial Number:</i> <i>Date of Manufacture:</i> <i>Model Number:</i>

Contents:	Pages:
Product Section	4 thru 18
General Information	4
Parts	4 - 7
Assembly	7 - 13
Operation	14 -17
Safety	17
Maintenance & Cleaning	18
Troubleshooting	18
Inspection & Service Logsheet	23
Warranty & Support Section	19 thru 22
Warranty Terms	19
Product Support & Assistance	20
Product Registration	21
Damage & Loss In Transit	21
Returns	22

General Information:

Read entire Product Manual before assembling and using this product. If you have any questions regarding the following information, please contact a Bailey Customer Service Representative at 1-800-321-8372.

Features & Specifications, Model 6030:

- Removable weight holder with weight keeper.
- Variety of fasteners included.
- Maximum load capacity of 80 lb. / 36 Kg.

Features & Specifications, Model 6031:

- Convenient wall mount with height adjustment.
- Variety of fasteners included.
- Mounting hardware *not included*.

Features & Specifications, Model 6044:

- Composed of 102 individual parts [including supplied hardware] for hand assembly simulation.
- Includes Hex Key tool.

Features & Specifications, Model 6045:

- Three (3) angled shelves at multiple heights.
- Shovel included.
- Recommended work material is SAND [*not included*].

Features & Specifications, Models 6046 & 6047:

- Basic electrical assembly supplies included.
- **Not to be wired with live current** [see Safety section].

Features & Specifications, Model 6048:

- Sorting bins with adjustable upper separators.
- Six (6) assorted fixed lower sorting bins.

Features & Specifications, Model 6049:

- Eight (8) position adjustable [6" increments] height shelf.
- Fixed position upper shelf.
- Maximum load capacity 80 lb. / 36 Kg.

Parts:

Your new Work Simulation Device is shipped "knocked down", with all hardware and parts included for final assembly. **Models 6030, 6044 & 6046 are shipped fully assembled and ready to use.**

Parts [cont'd]:

Inspect the unit carefully, immediately upon removal from packaging, to ensure that the unit is in good condition and all materials are present before starting assembly.

Note: Bailey Manufacturing Company waives any responsibility for concealed freight damage not reported within five (5) days of receiving shipment. Refer to Product Warranty and Support Section of this Manual for more information.

The following parts are supplied with these Models:

Model 6030 Lifting/Bolt Center:

- (1) EA. #A6020WH, Removable 6 1/2" Weight Holder
- (1) EA. #19250 Weight Keeper
- (10) EA. #1408 3/8-16 x 1 1/2" Hex Head Screw
- (5) EA. #2560 3/8-16 Hex Nut
- (20) EA. #3610 3/8 SAE Flatwasher
- (5) EA. #2630 3/8-16 Wing Nut

Model 6031 Work Station:

- (1) EA. #21443 3/8-16 x 1/2" Male Height Adjust Knob
- (2) EA. #16050 1/2-13 Female Round Knob
- (2) EA. #21426 3/8-16 Female Ball Knob
- (2) EA. Snap-on Finger Strap
- (12) EA. #1408 3/8-16 x 1 1/2" Hex Head Screw
- (2) EA. #1503 1/2-13 x 1 1/4" Hex Head Screw
- (5) EA. #2560 3/8-16 Hex Nut
- (5) EA. #2630 3/8-16 Wing Nut
- (1) EA. #3425 3/8-16 x 3/8" Socket Set Screw
- (1) EA. #3450 3/16" Hex Key
- (20) EA. #3610 3/8 SAE Flatwasher

Model 6044 Hand Assembly Device:

- (2) EA. Shaft
- (22) EA. #15151 Shaft Collar with Setscrew
- (4) EA. #1290 1/4-20 x 2 1/4" Hex Head Screw
- (4) EA. #1291 1/4-20 x 2 1/4" Slotted Head Screw
- (4) EA. #1420 3/8-16 x 2 1/4" Hex Head Screw
- (4) EA. #2540 1/4-20 Hex Nut

[continued on page 6]

Parts [cont'd from page 5]:**Model 6044 Hand Assembly Device [Cont'd]:**

- (4) EA. #2610 1/4-20 Wing Nut
- (4) EA. #2560 3/8-16 Hex Nut
- (1) EA. #3451 5/32 Hex Key
- (16) EA. #3581 1/4" SAE Flatwasher
- (8) EA. #3610 3/8" SAE Flatwasher

Model 6045 Shoveling Station:

- (8) EA. #2300 3/8-16 x 2" Carriage Bolt
- (8) EA. #2560 3/8-16 Hex Nut
- (8) EA. #3597 3/8 Lockwasher
- (8) EA. #3610 3/8 SAE Flatwasher
- (1) EA. #16212 Shovel

Model 6046 Tabletop Electrical Assembly Center:

- (12) EA. #15255 Twist-on Wire Connector
- (6) EA. #15256 Conduit Fitting
- (24) EA. #15257 Crimp-on Lug Terminal
- (20) FT. #15258 14 AWG Wire, White
- (20) FT. #15259 14 AWG Wire, Green
- (20) FT. #15260 14 AWG Wire, Red

Model 6047 Deluxe Electrical Assembly Center:

- (2) EA. Cabinet Support
- (4) EA. #1275 1/4-20 x 1" Hex Head Screw
- (4) EA. #3581 1/4" SAE Flatwasher
- (24) EA. #15255 Twist-on Wire Connector
- (12) EA. #15256 Conduit Fitting
- (24) EA. #15257 Crimp-on Lug Terminal
- (20) FT. #15258 14 AWG Wire, White
- (20) FT. #15259 14 AWG Wire, Green
- (20) FT. #15260 14 AWG Wire, Red

Model 6048 Sorting Bin:

- (4) EA. Upper Bin Divider

Model 6049 Adjustable Height Shelf:

- (1) EA. Base Assembly
- (2) EA. Upright Support Tube
- (1) EA. Adjustable Shelf Assembly
- (1) EA. Top Shelf Assembly

Parts [Cont'd]:**Model 6049 Adjustable Height Shelf:**

- (4) EA. #1405 3/8-16 x 1 1/4" Hex Head Screw
- (4) EA. #1420 3/8-16 x 2 1/2" Hex Head Screw
- (4) EA. #2560 3/8-16 Hex Nut
- (12) EA. #3597 3/8 Lockwasher
- (4) EA. #3610 3/8 SAE Flatwasher
- (2) EA. #15031 Plunger Assembly

Assembly:

The following Work Simulation Devices are shipped fully assembled and need no assembly or installation:

- Model 6030 Lifting/Bolt Center
- Model 6044 Hand Assembly Device
- Model 6046 Tabletop Electrical Assembly Center

For all "knocked down" devices, the following minimum tools are required:

- 7/16" wrench
- 9/16" wrench

Any of these additional tools will make assembly easier:

- 7/16" socket and drive ratchet
- 9/16" socket and drive ratchet

Model 6031 Wall Installation:

Note: Due to wide variances in wall and building construction, no mounting hardware or detailed hardware recommendations are provided. Consult an installation contractor or design professional who is familiar with your particular wall construction and materials. They can ensure compliance with the Uniform Building Code and any applicable local codes.

Determine a permanent location for wall mounting, and mark the wall using the location dimensions in Figure 1, page 8.

[continued on page 8]

Model 6031 Wall Installation [Cont'd]:

The following minimum materials are required for installation:

- Four (4) each fasteners, 5/16" diameter, for mounting upper and lower brackets to the wall.

After obtaining proper wall fasteners, install per fastener manufacturers instructions and mount both brackets to the wall. Tighten all fasteners securely. Loosen height Adjust Knob and check adjustment; retighten in desired location.

Check all components for tightness and proper fit. Review Operation section before placing unit into service.

Figure 1
Model 6031 Work Station Installation

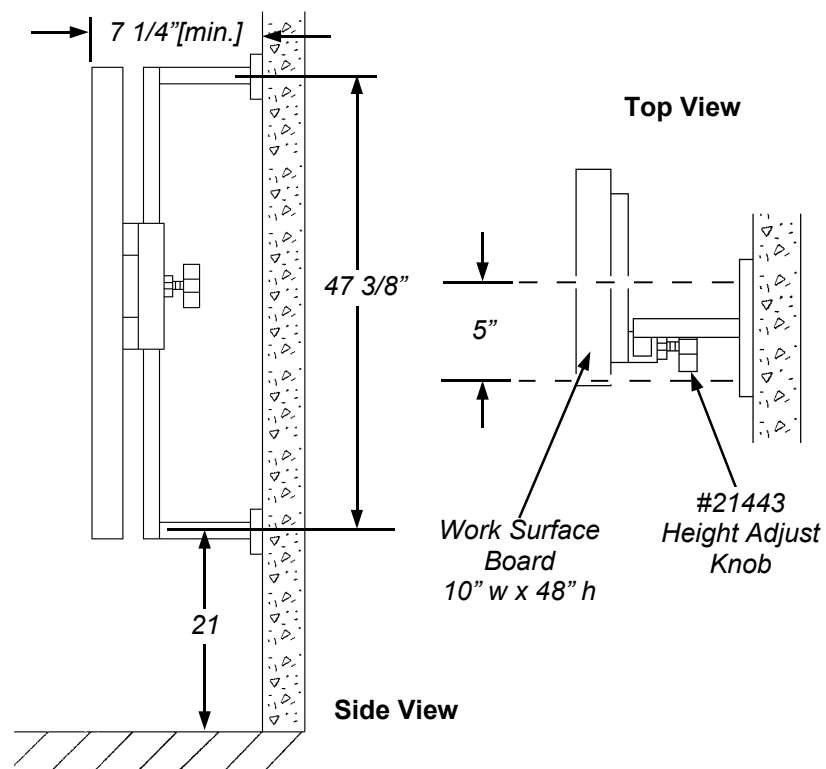
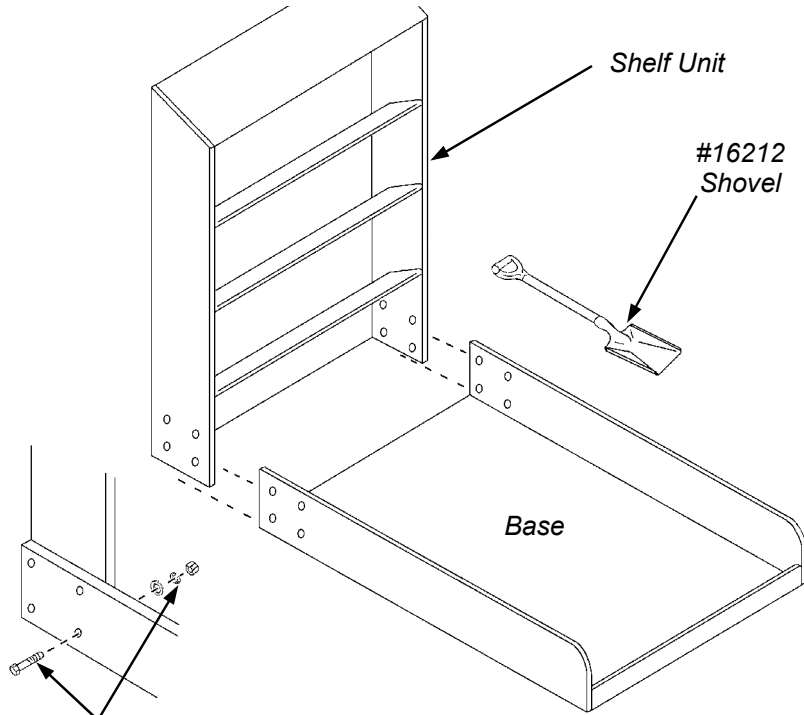

Figure 2
Model 6045 Shoveling Work Station Assembly



- #2300 3/8 x 2 Carriage Bolt, (8) EA
- #3610 3/8 Flatwasher, (8) EA
- #3597 3/8 Lockwasher, (8) EA
- #2560 3/8 Hex Nut, (8) EA

Model 6045 Assembly:

Locate the Base where the finished unit is to be used. Slide the upright Shelf into the Base as shown in Figure 2, above, and align the holes in both parts. Install all eight (8) sets of fasteners with Hex nuts and Washers on the inside, and tighten securely.

Check all components for tightness and proper fit. Review Operation section before placing unit into service.
[continued on page 10]

Assembly [Cont'd]:**Model 6046 Assembly [Figure 3, below]:**

The Tabletop Electrical Assembly Center is preassembled.

Model 6047 Assembly [Figure 4, opposite page]:

Attach the two (2) Cabinet Supports to the main cabinet, one on each side as shown in Figure 4, opposite page. Fasten each support using two (2) Hex head Screws and Flatwashers, and tighten securely. Reverse Lower Cabinet Door handle from shipping position [inside] and reinstall.

Check all components for tightness and proper fit. Review Operation section before placing unit into service.

Warning: These products are intended for work simulation only. Do not use with live current!

Figure 3
Model 6046 Tabletop
Electrical Assembly Center [preassembled]

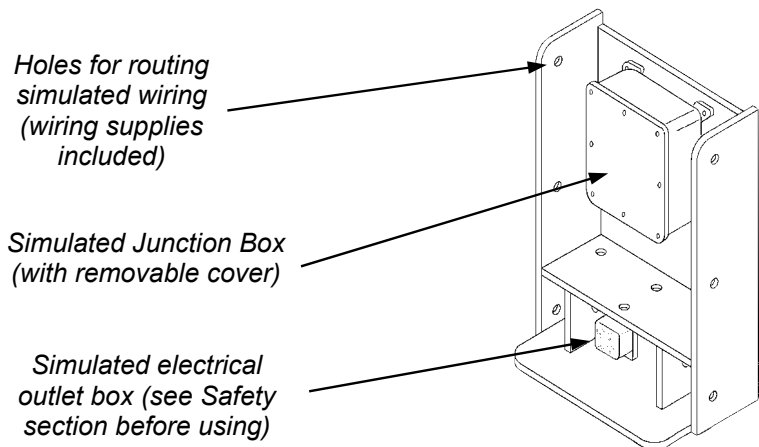
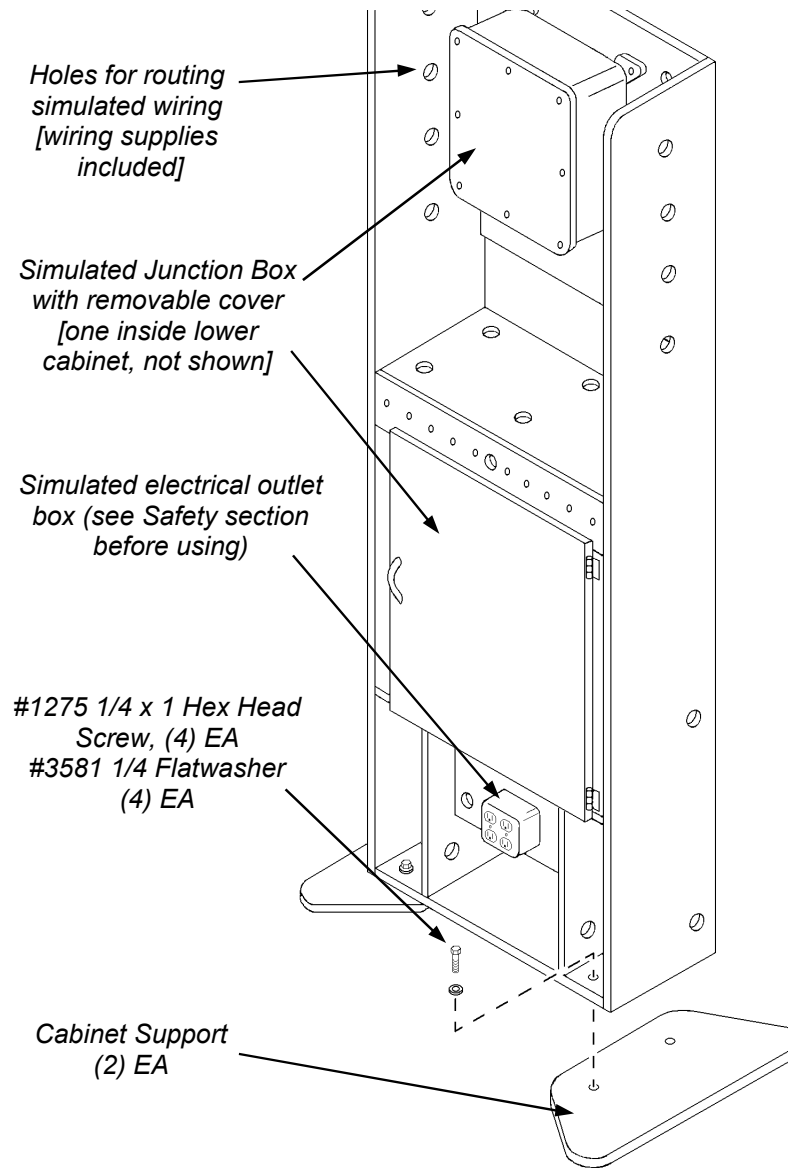

Figure 4
Model 6047 Deluxe Electrical Assembly Center



Assembly, [Cont'd]:**Model 6049 Assembly [Refer to Figure 5, opposite page]:**

Place all parts in the location where the unit will be used. The Base is supplied preassembled, with four (4) 3/8 x 1 1/4" Hex Head screws and Washers installed in the two (2) Base Tubes, where the vertical Uprights attach to them.

In order not to "lose" a Tube Insert in a Base Tube by removing these screws all at once, remove only one (1) set of screws and washers from each Base Tube at a time. Attach each Upright to the Base with this screw and washer set first, then remove the second set, and attach the Upright with these. **Note that the holes in both Uprights must face outward.** Do **not** tighten these screws completely at this time. If a Tube Insert becomes "lost" inside the Base Tube, remove the rear End Cap and the 3/8 Hex Head Screw, and the Insert will slide out of the Tube.

With both Uprights attached to the Base, place preassembled Adjustable Shelf over the Uprights until at the lowest adjustment hole location. Install the two (2) Plunger Assemblies and fully engage them both in the lowest holes.

Install Top Shelf to the uprights using four (4) 3/8 x 2 1/2" Hex Head screws, Lockwashers and Hex Nuts as shown.

Tighten lower Upright mounting screws securely. Pull plungers back and slide Adjustable Shelf up until locked into the uppermost holes. Tighten the Top Shelf mounting screws securely. Check Adjustable Shelf operation by engaging and locking into all Upright hole positions.

Check all components for tighness and proper fit. Review Operation section before placing unit into service.

Figure 5
Model 6049 Adjustable Shelf

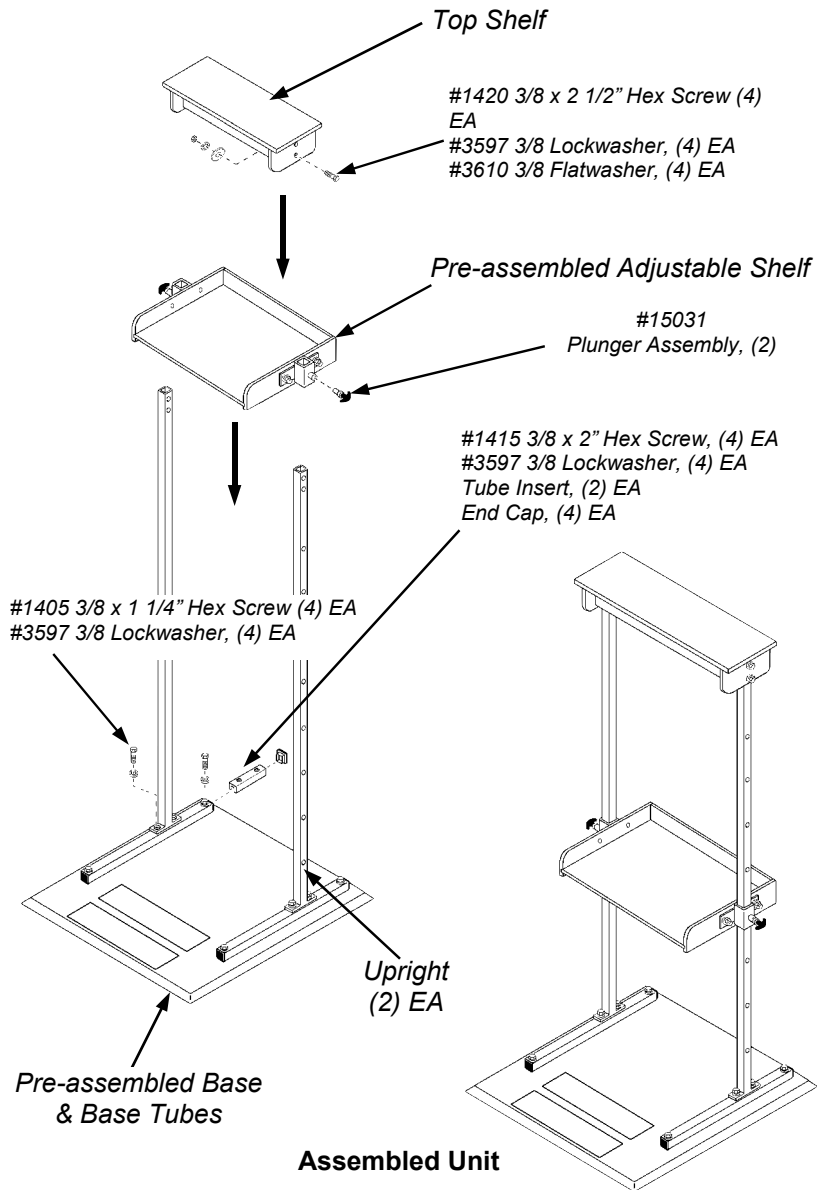

Operation:**Model 6030 Lift Box/Bolt Center:**

Caution: Each facility must use its own definition of a safe lift. Identify the patients body mechanics with preliminary tests using empty Lift Boxes. In all cases, the back should be stable, with the legs and arms used for power. Always consider ergonomic factors when designing work simulation tasks.

The Disk Weight Holder [Figure 7, page 16] may be removed by unscrewing by hand; the Weight Keeper is removed by squeezing the Tabs together and lifting off of the Holder. Use the supplied hardware kit to simulate hand dexterity tasks.

Model 6031 Work Station [Refer to Figure 1, page 8]:

Adjust the working height of the unit by loosening the Height Adjust Knob, behind the work surface. Retighten the Knob when in the desired location. **Do not overtighten!** Use the supplied hardware kit to simulate standing assembly tasks.

Model 6044 Hand Assembly Device:

This preassembled unit provides a challenging task routine for advanced assembly techniques. Refer to the diagrams in Figure 6, opposite page, if reassembly proves difficult. The 5/32" Hex Key required for removing and installing the Shaft Collars is supplied with the unit.

Model 6045 Shoveling Station:

The Shoveling Station [Figure 2, page 9] is designed for use with any type of sand or other small granular material [not included]. A Shovel is supplied with the unit.

The Station has three shelves at entry heights of 15", 30" and 43". These shelves are angled toward the back in order to allow the shoveled material to return to the Base with a minimum of loss.

[continued on page 16]

Figure 6
Model 6044
Hand Assembly Device [preassembled]

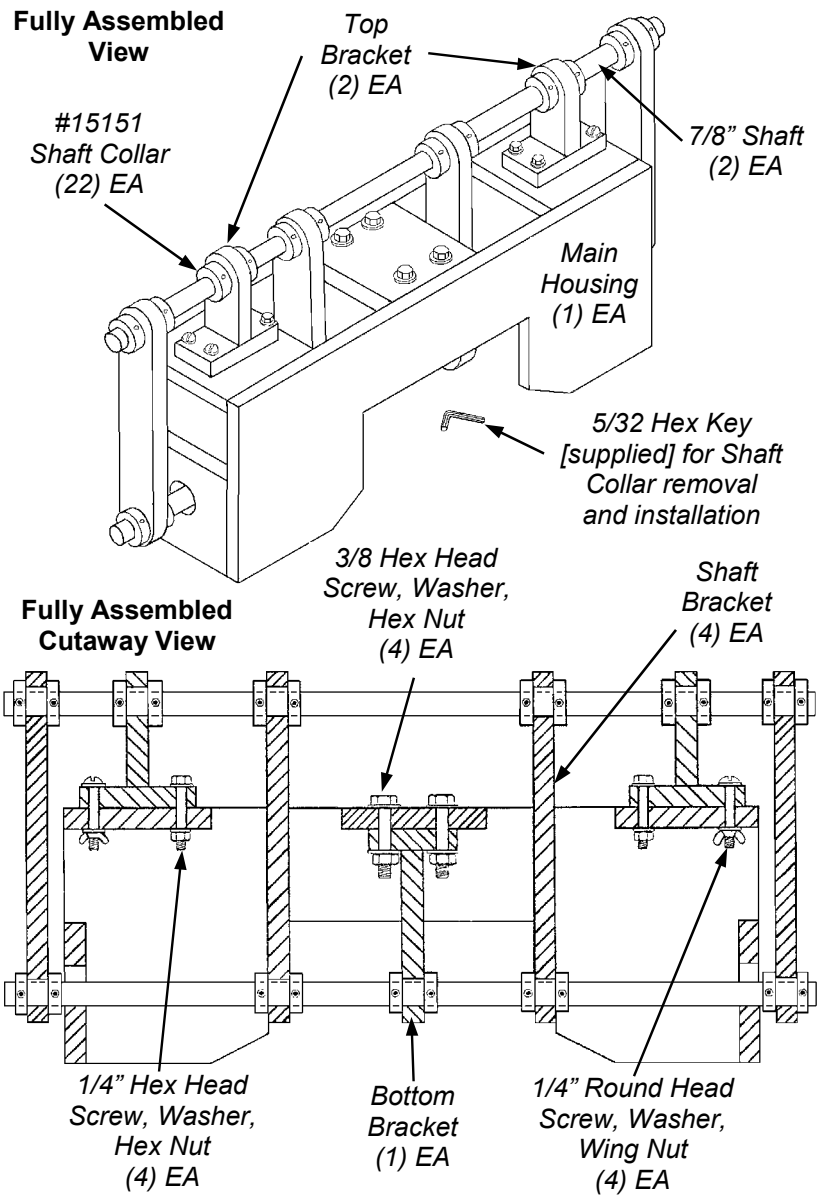

BAILEY MANUFACTURING COMPANY

Operation [Cont'd]:**Models 6046 & 6047 Electrical Assembly Centers:**

Electrical Assembly Centers feature actual industry standard parts and supplies for use in simulated work tasks. The Junction boxes have removable covers and internal terminal strips; the cabinets feature pass-through holes for wiring runs [Refer to Figures 3 & 4, pages 10 & 11]. *Industrial trade tools are not supplied and may be required for some realistic work simulations.*

Warning: These products are intended for work simulation only. Do not use with live current!

Model 6048 Sorting Bin:

This Sorting Bin features six fixed lower bins and five variable upper bins. The four (4) Sort Bin Dividers may be inserted into the upper bin grooves in any arrangement [see Figure 8, opposite page].

Model 6049 Adjustable Height Shelf Unit [Figure 5, page 13]:

The Adjustable Shelf has eight (8) fixed locations. Ensure Plungers are fully engaged before using the Shelf! When adjusting shelf height, both Plungers must be retracted at the same time before raising or lowering.

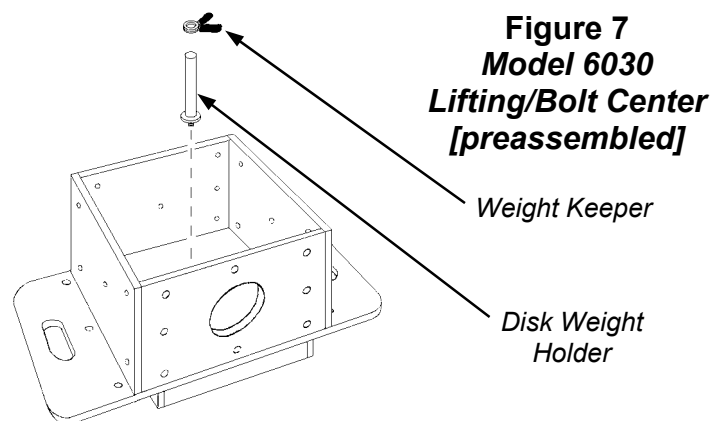
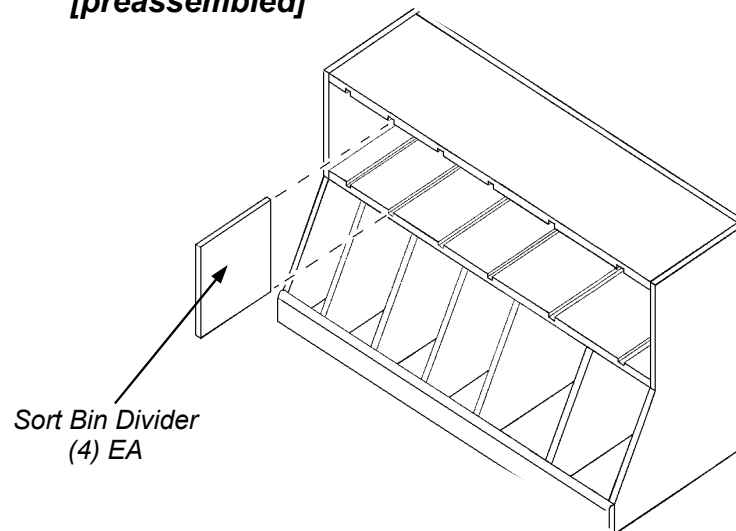

Figure 7
Model 6030
Lifting/Bolt Center
[preassembled]

Weight Keeper

Disk Weight
Holder

Figure 8
Model 6048 Sorting Bin
[preassembled]



Model 6049 Adjustable Height Shelf Unit [Cont'd]:

For the easiest adjustment, approach the Shelf from behind, or use two people. Note: Due to the vertical, space-saving design of this unit, some movement in the Uprights will be noticeable while in use. *The unit is stable as long as the combined load on both shelves does not exceed the load rating on Page 4. Avoid placing the entire load on the top shelf.*

Safety:

Be safe! All Bailey Work Simulation Devices are designed to allow the therapist to create protocols based upon a patient's previous work experience rehabilitation goals. Always design work simulation tasks within NIOSH and OSHA guidelines, and observe product Load Ratings as stated on page 4 where applicable.

Maintenance & Cleaning:

Regularly inspect components for wear and proper adjustment. Should the unit need attention, remove from service until the unit is returned to its original condition. A convenient Inspection and Service Logsheet is provided on page 23 for recordkeeping.

To help keep your product in good condition, clean as required using **abrasive free** and **solvent free** products. Test any cleaner or disinfectant on a small, inconspicuous location before using. Discontinue use if surface softens, discolors, or loses gloss.

Never use any cleaners or disinfectants containing harsh solvents on product surfaces. Check their Material Safety Data Sheet and consult the manufacturer with any questions. Some chemicals will severely shorten the life of your plastic parts and lacquer coated wood finishes.

For light soiling, we recommend liquid dish soap and water, or liquid cleanser and water applied sparingly with a soft bristle brush. For difficult stains or disinfection, use a solution of 10% household bleach [sodium hypochlorite] and 90% water applied sparingly with a soft white cloth. Rinse with water dampened cloth to remove any remaining soap, cleanser or bleach solution.

Troubleshooting:

Your new Bailey Work Simulation Device will provide years of reliable service. In the event the Table does not function correctly, inspect all components for tightness and proper condition.

For detailed information or component replacement, contact Bailey Customer Service at the number on this page. **Have your date of purchase and Bailey Dealer information handy for faster service.**

Five Year Limited Warranty:

Bailey Manufacturing Company warrants the products we manufacture to be free of defects in materials, workmanship, or design under normal use and service conditions for five years after the date of original purchase (two years for Bailey Basics). Resale products and components manufactured by others will carry the warranty of the manufacturer. If the product and/or equipment should become defective within the designated warranty period, Bailey Manufacturing Company will repair or replace it (at our option) free of charge, including return transportation to you, provided you deliver the equipment or product prepaid to Bailey Manufacturing Company at 118 Lee Street, Lodi, Ohio 44254. Please receive "authorization" before returning product to the factory, as Bailey Manufacturing Company will not accept collect shipments. Bailey Manufacturing Company reserves the right to repair or replace component parts without return of the entire unit.

This warranty does not include damage resulting from accident, abuse, or misuse of the product and expressly excludes normal wearing of parts or defect caused by transportation, accident, fire, flood, alteration, or negligence.

Bailey's warranty liability is limited to that stated above; other than the warranty stated above, there are no warranties expressed or implied. Bailey will have no responsibility for consequential or incidental damages.

Product Support:

Bailey Manufacturing Company is totally committed to producing the finest quality physical, occupational, and sports medicine products. Our goal is your total satisfaction. If you experience any problems, please feel free to contact a Bailey Customer Service Representative at 1-800-321-8372 between the hours of 8:30 AM and 4:30 PM Eastern Time weekdays.

The following information is provided to help ensure that your experience with Bailey is a positive one. Please read this information carefully before you unpack or begin assembly.

If You Need Assistance:

To provide the best possible service to our customers and dealers, warranty claims should be made directly to Bailey. Since Bailey is in the best position to solve the customer's problem, it will speed up the process and help ensure total customer satisfaction. Should you encounter any problem with our products or services, please contact a Bailey Customer Service Representative at 1-800-321-8372 between the hours of 8:30 AM and 4:30 PM Eastern Time, weekdays. Please have the date of purchase and Bailey dealer information recorded inside the front cover of this manual, or a copy of your packing list available to help our customer service representative provide you with the fastest service. In most cases, you will also want to notify your dealer to enable them to provide any further assistance.

Registration:

Product registration will be accomplished through the use of the enclosed Product Registration Form. *Please take time to complete this Form and return it to Bailey.* We also ask that you answer a few simple questions concerning our products and services. Our goal is your total satisfaction, and this information will be used to improve our products and services for you...the customer. *Please take a moment to record your purchase inside the front cover of this manual. Note the date and the name of your Bailey dealer.*

Damage or Loss in Transit:

All of our equipment is thoroughly inspected and carefully packed before leaving our plant. It is receipted for by the carrier as having been shipped in good condition. Any loss or damage which occurs to the equipment in route will be solely through negligence of the carrier and all claims must be filed directly with the carrier. Important; If a shipment is delivered to you in a visibly damaged condition or in a quantity that is less than is enumerated on the Bill of Lading or delivery receipt, insist on a notation of this damage or shortage by the delivering carrier's agent on the delivery receipt or freight bill. When a shipment has been delivered to you in apparent good condition, but upon opening the containers or crate, damage is discovered, notify the delivering carrier immediately upon discovery. This notification must be made within 5 days of receipt of the shipment. Insist upon an inspection and inspection report. You must retain all packaging, including the carton or crate in which the damaged item was shipped, until inspection has been made. All claims must be made by you, the consignee, directly to the carrier or its agents.

Returns:

Merchandise to be returned **must** have proper authorization. Please contact your dealer for assistance with this procedure. A reference (return authorization or RA) number is to be clearly marked on all cartons and correspondence. Freight charges are to be prepaid, as collect shipments are not accepted. Items must be in the original packaging and returned within 30 days of the invoice date. Returns that are **not** the result of a warranty claim are subject to a restocking fee of 20% to cover inspection and handling. Any damage due to use, mishandling, or improper packing of the return will be noted and deducted from the credit issued. Special order items may not be returned for credit. Bailey Customer Service Representatives will complete a "Returned Merchandise Information" form to clearly identify all information concerning the returned merchandise.

Specifications:

Due to continuous improvements in design, materials, and construction techniques, specifications in the Bailey catalog are subject to change without notice. In all cases, the equipment shipped will be of equal or superior quality. Bailey Manufacturing Company also reserves the right to discontinue the manufacture of any product at such time as we consider necessary.

Customer Service:

When service is required, it is nearly impossible to place a value on it. For that reason we have an extremely competent Customer Service Department available to assist you with answers to your questions or recommendations in your planning process. In the unlikely event that a product may be in need of repair, our staff will assist with prompt identification of the required replacement part. Have the date of purchase and the name of your Bailey dealer handy for reference. Please contact us at 1-800-321-8372 between the hours of 8:30 AM and 4:30 PM Eastern Time weekdays for assistance.

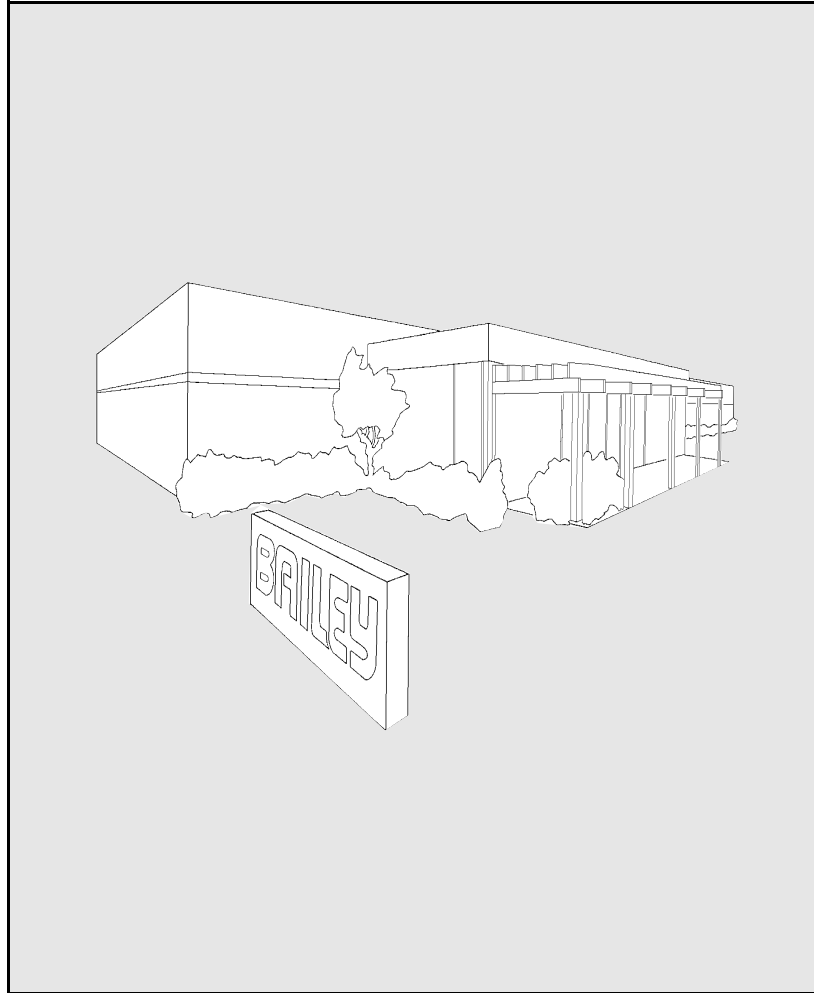

BAILEY