

# pivot & tilt overbed table

# assembly & operating instructions



Note: Spare part 2 packed separately and included in the box.

Release knob 1 before straightening tube 2

Tighten knob 1

Release knob 4

Secure tube 5 into part 6 by pushing button

Screw on part 3 for up and down setting



Locking Device



Protective Trim



Height Adjustment Knob



Folding Knob



Casters With Locks

## step 1

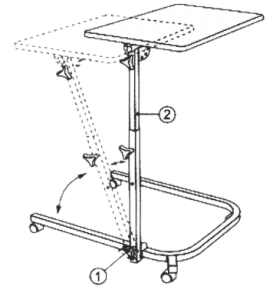

## step 2

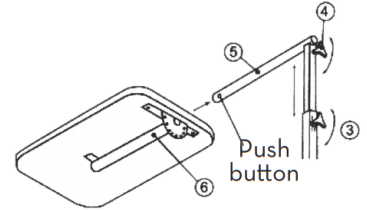

## complete

