



The therapeutic tricycle for children with disabilities



Assembly Instructions

Amtryke AM-12S

#50-HFC-0110

Tools Required:

4mm Allen Wrench

10mm Wrench or Socket

Crescent Wrench or 22mm Socket/ Wrench



Too large for the AM-9 and too small for AM-12? The AM-12SMALL AmTryke features the combination hand/foot drive and fills the size gap between the AM-9 AmTrykes and the AM-12. Smaller frame size and 3 inch crank arms accommodate riders transitioning from the AM-9 to the AM-12.

1) Install seat post tube over main frame by sliding it over.

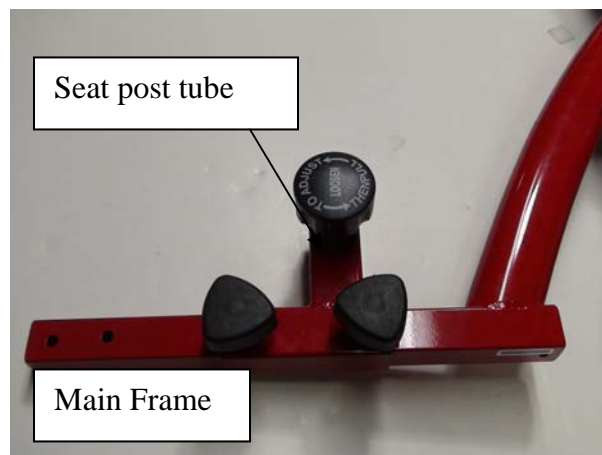

2) Slide rear deck frame over main frame, loading lock rod should be on right side.

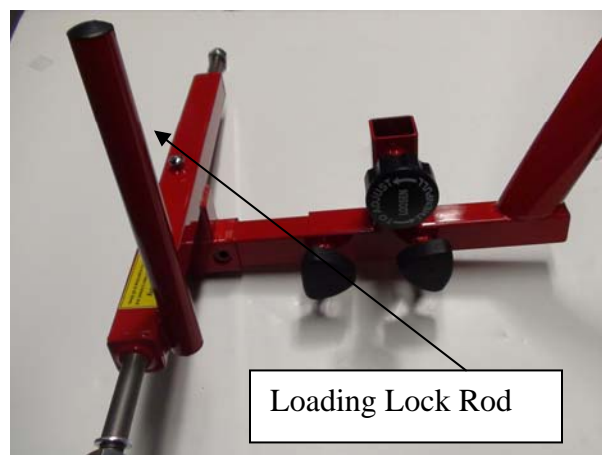

3) Align two holes in rear deck with main frame and insert cam lock lever through.

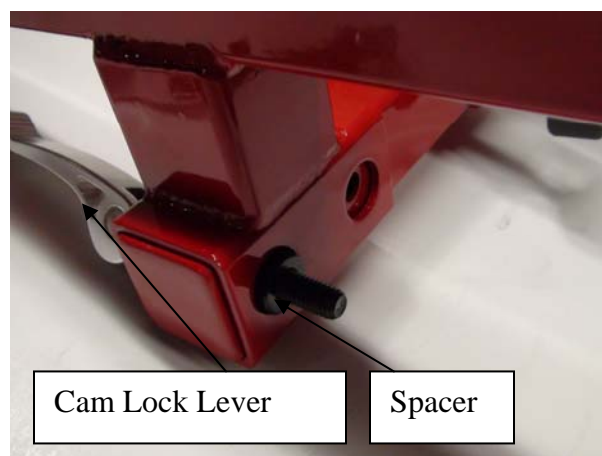

4) Insert spacer over threaded portion so that it recesses into hole in rear deck.

5) Install thumb nut by turning clockwise, lightly tighten and then pull cam lock lever back to secure.

6) Remove 22mm nut and washer from each axle end, slide rear tire over with valve stem on the inside.



7) Slide one washer over each axle and then install 22mm nut by using crescent wrench or 22mm socket/wrench, snug nut down.

8) Press white nut cover onto rear axle nut and then use rubber hammer or wooden block to tap in place.



9) Install handgrips, located on the end of each threaded portion it is stamped "L" or "R" for left or right. The right side of the AM-12S has the chain guard while the left does not. Turn the right clockwise to thread it in and the left counter clockwise to thread it in. Use the large end of the wrench provided to tighten.



10) Install pedals, please refer to step 9 when installing pedals.



11) Slide loading lock brake over loading lock tube, loading brake should be flush with black plastic cap located at the top of loading lock tube. Use 10mm wrench or socket to tighten two nuts until secure.

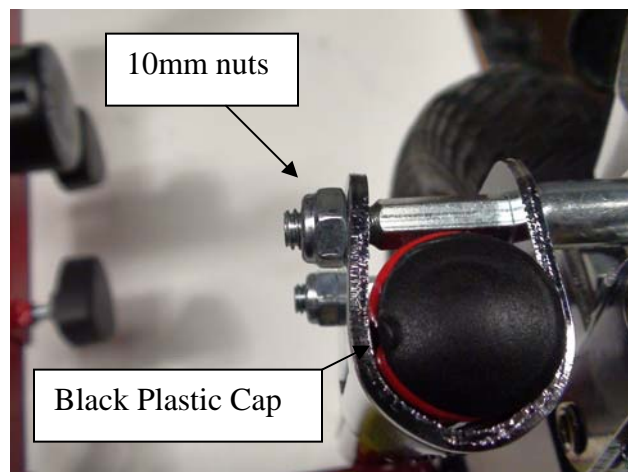

12) Turn padded seat over to expose the underside, place seat post on top of seat and align holes in seat post up with holes in seat. Use 4mm Allen Wrench to tighten screws.

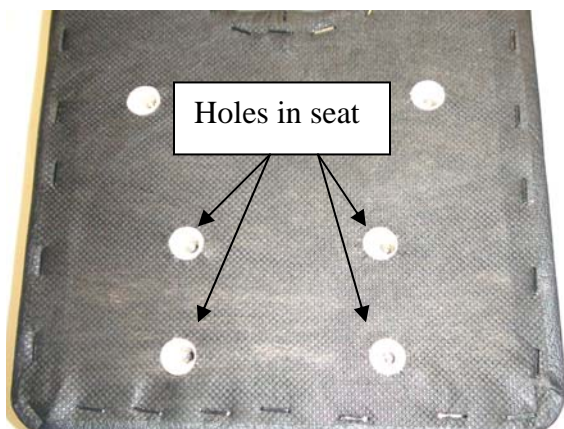

13) Install black retainer plate to seat post, use large end of wrench provided to tighten.



14) Slide back support rod in between black retainer plate and seat post. Use small end of wrench provided to tighten. Do not completely tighten until rider has been fitted on tryke.



15) Remove two knobs and two washers from back of curved plastic seat back. Slide curved plastic seat back down over back support rod. Install both washers and plastic knobs and tighten.



16) Insert seat assembly into seat post tube, pull out on seat post knob to adjust height and then release and tighten.



PARTS LAYOUT

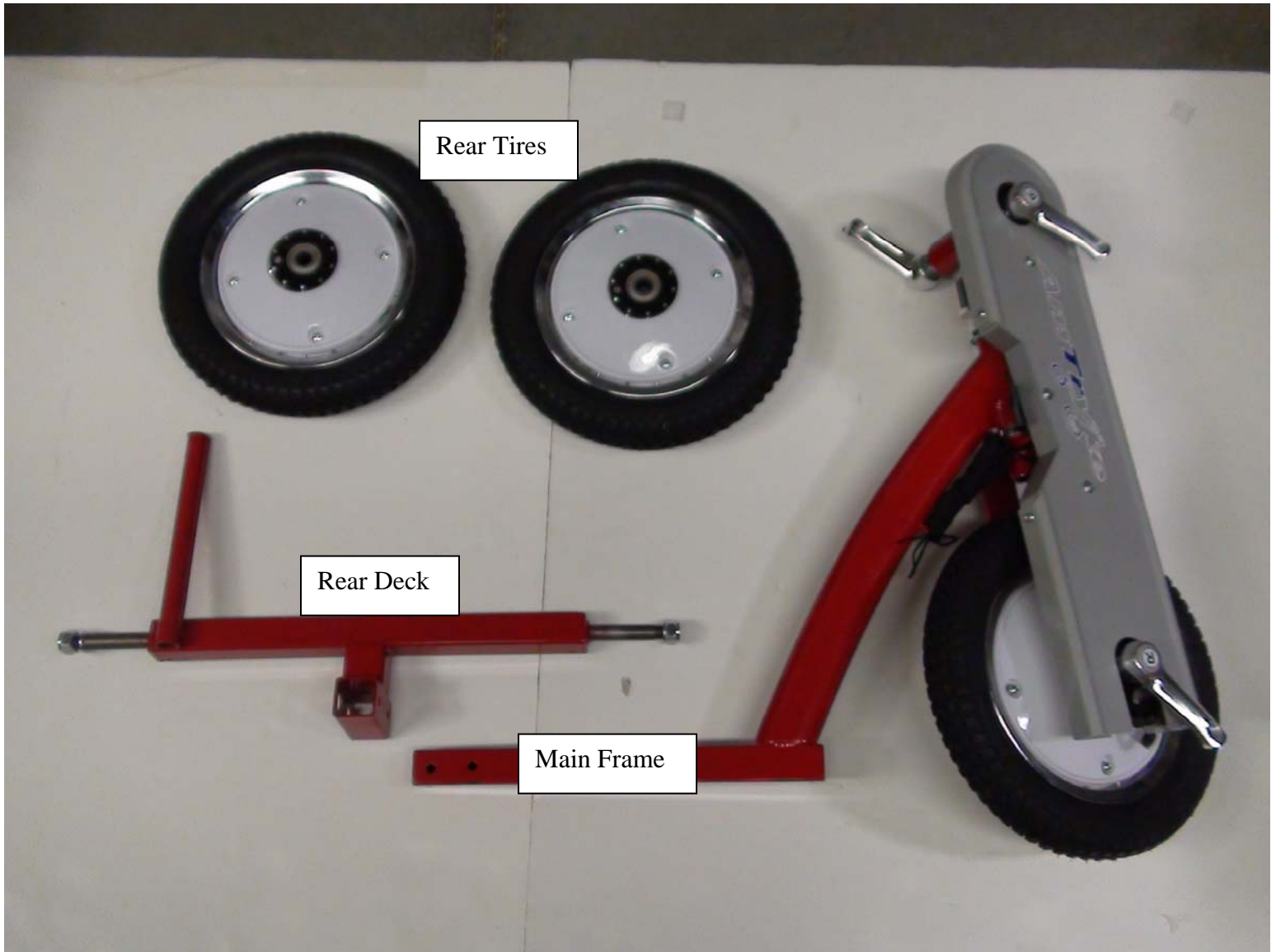

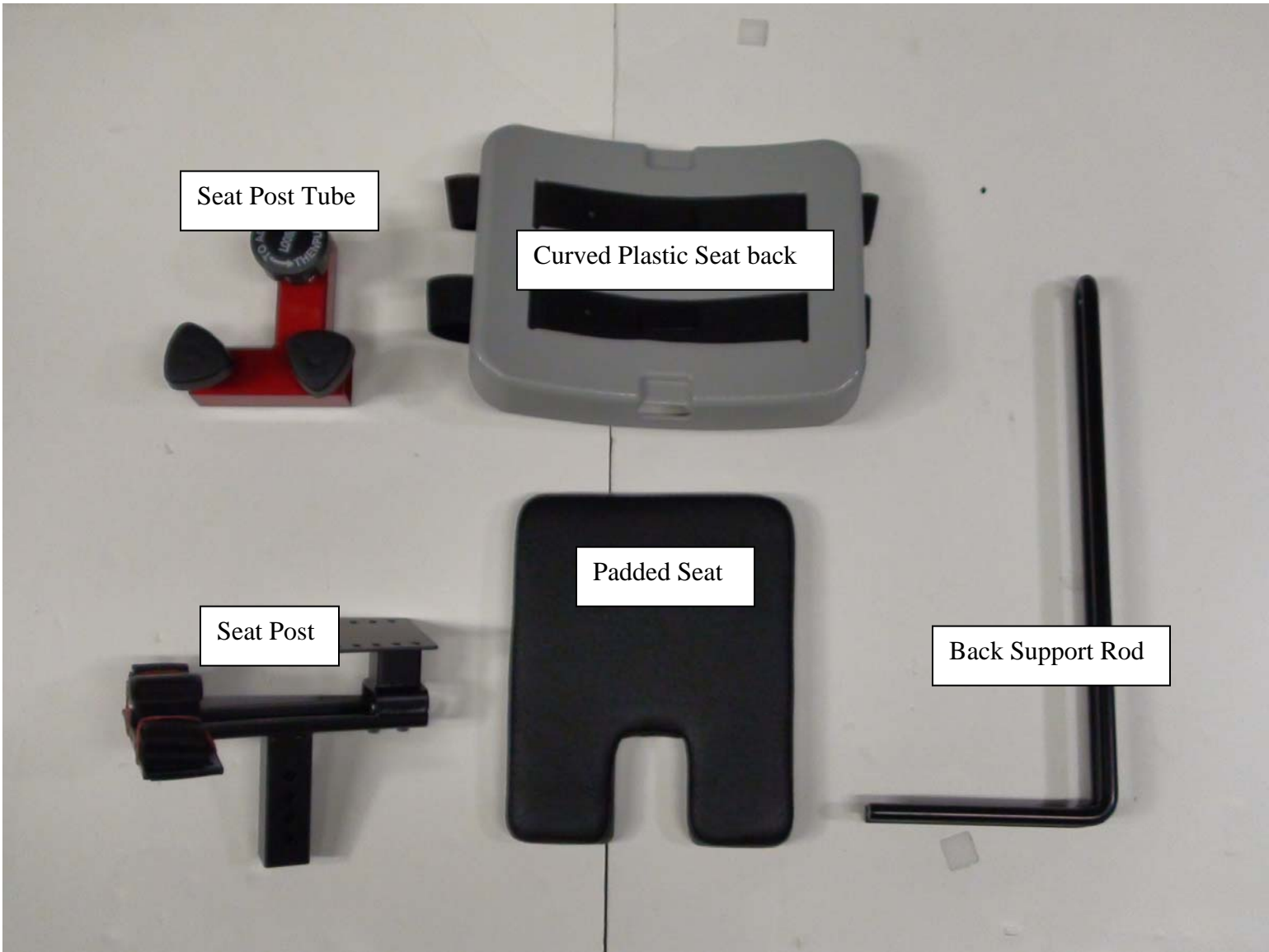

Seat Post Tube

Curved Plastic Seat back

Seat Post

Padded Seat

Back Support Rod

Loading Lock Brake



Rear wheel nut covers



4mm Seat Bolts and washers



Steering Pin

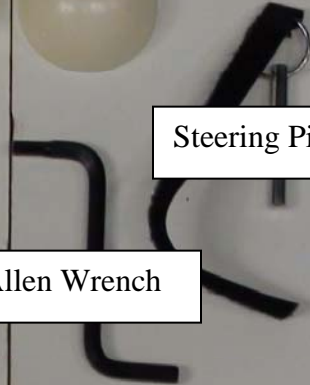

Cam Lock Levers



Allen Wrench



Wrench



Black Retaining Plate and Bolts



Cam lock lever wrench



Right and Left Pedals



Right and Left Hand Grips

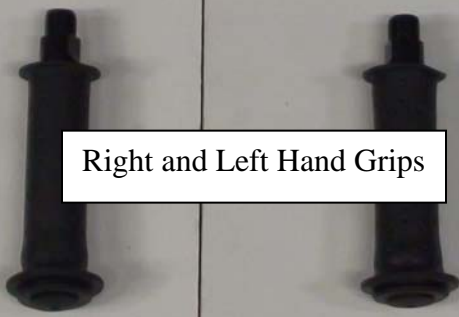

AmTryke LLC.

AmTryke, LLC and National AMBUCS, Inc maintain a warehouse and ships product from High Point, North Carolina. Due to continual product improvement, AmTryke, LLC reserves the right from time to time to make reasonable substitutions without prior notice. Prices are subject to change without notice.

Our goal is to provide prompt and efficient service. We try to maintain ample inventory but unusual demand will sometimes deplete our stock of an item. If due to unusual demand, our inventory of an item is depleted and the item is backordered, allow six to eight weeks for delivery. You will be notified if an item is delayed or discontinued.

Terms

Individuals may order by using Visa, Mastercard, American Express, check, money order, or may be billed to AMBUCS™ chapter, district or region if authorized.

Shipping

Orders are shipped by USPS, Fed Ex or UPS. Rush orders are sent at your request, and you, or your chapter, district or region is billed for rush charges and handling. Shipping and handling charges are added to all orders. Please contact us for shipping items outside Continental U.S.

Fed Ex or UPS:

The guarantee does not apply to shipments that are delayed due to causes beyond UPS or Fed Ex control, including but not limited to, the following:

1. The act, default or omission of the Shipper, Consignee or any other party claiming an interest in the shipment, including delivery instructions from the Shipper or Consignee with which we complied;
2. The nature of the shipment, defect, or inherent vice of the product;
3. Failure of the Shipper or Consignee to observe any term contained in these Air Freight Terms, including but not limited to improper or insufficient packaging, securing, addressing or marking of any shipment, including omission of, or provision of, an incorrect Consignee address or ZIP code on the Air Waybill, providing insufficient information, or the Shipper's failure to follow any term related to shipments that are not acceptable for transport.
4. Acts of God, weather conditions, environmental or hazardous goods incidents, perils of the air, public enemies, public authorities acting with actual or apparent authority, acts or omissions of customs officials or similar authorities, the application of security regulations imposed by the government or otherwise applicable to the shipment, authority of law, quarantine, riots, strikes or other labor disputes or disturbances, civil commotions or hazards incident to a state of war, local or national disruptions in ground or air transportation networks or systems due to events beyond our control, disruption or failure of communication and information systems, disruption or failure of utilities, or other circumstances beyond our control (hereinafter referred to collectively as "Force Majeure Events").
5. Compliance with laws, government regulations, orders or requirements, or any cause beyond our control.

AmTryke Safety

1. AmTrykes should be used with close adult supervision.
2. Riders must wear a helmet when riding an AmTryke. The helmet must fit appropriately and remain properly fastened. A properly fitting helmet will sit down on the head comfortably. A helmet that sits high on the head is too small. Some movement is acceptable but a helmet with excessive movement is too large. The chin strap should be adjusted so that there is room for one or two fingers to slide between the strap and the chin. Use caution not to pinch the skin when the buckle is fastened.
3. Riders must wear shoes. Shoe laces must be tied properly.
4. Never allow multiple riders. Do not let other children attempt to approach or climb on a trike when it is being ridden by another rider.
5. AmTrykes are equipped with a steering pin. There are three steering options:
 - a. *Full steering.* This option allows the rider to make sharp turns. This option is appropriate for riders at slow speeds or in close quarters. Close adult supervision is required. Full steering should not be allowed for riders that ride at high speeds as sharp turns may cause the trike to tip over.
 - b. *Limited Steering.* This option allows the rider to steer 20⁰ in either direction. This option limits the turning radius reducing the risk of over-steering or tipping the AmTryke in a sharp turn.
 - c. *No steering.* This option allows for travel in a straight line only. A supervising adult will be necessary to turn the trike around.
6. Avoid tipping the AmTryke by approaching wheelchair ramps or thresholds at a 90⁰ angle.
7. Do not ride AmTrykes where there is a risk of falling off of curbs, stairs, potholes or other hazards.
8. Do not ride AmTrykes in or near traffic.
9. Use caution on sloped parking lots, driveways and sidewalks. Avoid excess speed by having an adult restrain the AmTryke from behind on sloped surfaces. Many riders will not have the motor skills to use the hand brake effectively. Do not restrain the AmTryke by grabbing the handlebars or hand brake as this may cause the bike to turn sharply and risk tipping over.
10. Depending on trunk stability, behavioral compliance, and body awareness, some riders may need lateral supports, head supports, lap belts, shoulder belts, hip abductors or other specialized equipment. A physical therapist can assist in those recommendations.
11. Riders should only be allowed to ride AmTrykes that are the appropriate size. If you are uncertain, please contact a physical therapist.
12. Do not ride the AmTryke if the tires are not inflated properly. If parts are broken or missing the AmTryke should be removed from service until repairs are made.