



Introducing AirLogic™  
Posture and Chest Supports\*

The breathable solution. The logical choice.



air  
LOGIC™





We set out to build  
a more breathable  
Anterior Trunk Support.  
It turned out to be one  
of the most durable.

**AirLogic blends unique materials** and construction techniques to create one of the most durable stretch anterior trunk supports.

**Durable, Concealed Zipper**  
An optional, hidden YKK zipper features a wide, easy-pull tab to facilitate operation by users with limited hand function. The durable zipper is concealed by the welded seam to compliment the modern appearance.

**Sporty Details**  
AirLogic incorporates contemporary, fashionable details and rich fabrics to create functional designs.



**Slim-line, low-profile top buckles** combine easy-to-use side release operation, a dynamic and sporty look with a strength rating of 50 lbs. of direct force. To prevent improper installation, the top buckle cannot be interchanged with the bottom buckle.



**Front D-ring pull straps** enable easy posture support adjustment by users and caregivers.



**Gray Air Mesh material** on the front-facing side of AirLogic trunk supports identifies our Non-Stretch product line. Non-Stretch styles feature the full Air Mesh fabric facing the user but include a laminate membrane backing to prevent the entire belt from stretching.



**Swiveling, quick-release bottom buckles** enable pelvic movement without causing uncomfortable pressure while maintaining proper trunk support and stabilization. The durable, pivoting buckle increases belt longevity by distributing connection point stress.

## Patented AirLogic™ technology maximizes breathability and comfort with moisture-wicking fabrics and durable construction.

After years of research and product design testing, AEL developed the market's most breathable, yet durable, anterior trunk support technology—AirLogic™. While AirLogic™ Anterior Trunk Supports are technically advanced in terms of construction, they are designed for ease of use, convenient connection, accessibility and cleaning. What's more, the unique AirLogic panel design enhances durability through controlled stretching. Ultimately, that protects the

binding and panel from separating, withstanding high tone and heavy use. Add sporty design details, heavy-duty silver contrast stitching, convenient features and rugged buckles and you have everything ever wanted in a trunk support product. Available in a range of sizes—in Stretch, Non-Stretch and Zippered designs—there's a Standard- or Slim-Cut AirLogic™ product that's a perfect fit for your needs.

Breathable, durable and logical. AirLogic.™

### Inside AirLogic™

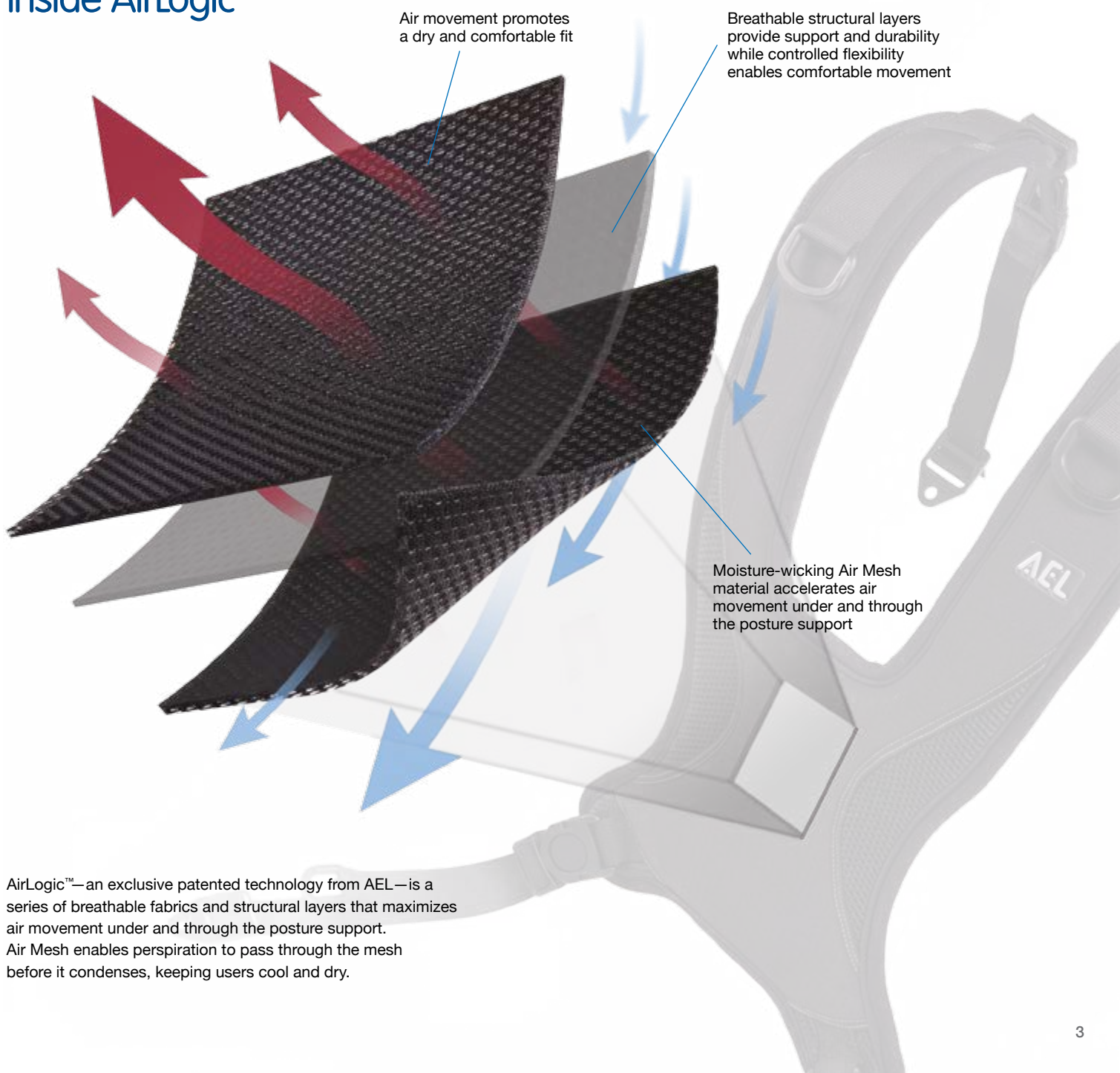

Air movement promotes a dry and comfortable fit

Breathable structural layers provide support and durability while controlled flexibility enables comfortable movement

Moisture-wicking Air Mesh material accelerates air movement under and through the posture support

AirLogic™—an exclusive patented technology from AEL—is a series of breathable fabrics and structural layers that maximizes air movement under and through the posture support.

Air Mesh enables perspiration to pass through the mesh before it condenses, keeping users cool and dry.



# AirLogic™ Standard-Cut Anterior Trunk Supports

Standard-Cut styles provide optimal trunk and chest support, while enabling the comfort of air movement between the user and the underside of the support. Choose from Stretch, Non-Stretch and Zippered styles. To size AirLogic™ Standard-Cut styles, match dimensions in the table with the illustration below.



**AirLogic™ Anterior Trunk Support: Standard-Cut**

Size	A	B	C	D	E	F	Webbing Width	Stretch Part No.	Non-Stretch Part No.
XX Small	6"	10½"	4½"	5¼"	1¼"	2"	1"	14250	14280
Extra Small	8"	14"	4½"	8½"	4"	2"	1"	14251	14281
Small	9¼"	17"	6"	10"	5½"	2"	1"	14252	14282
Medium	10¼"	20"	7½"	11¼"	6¼"	2¼"	1"	14253	14283
Large	11¼"	22"	8¼"	12½"	7"	2½"	1"	14254	14284
X Large	12¼"	24"	9"	13½"	7½"	2¾"	1"	14255	14285

**AirLogic™ Anterior Trunk Support: Standard-Cut Zippered**

Size	A	B	C	D	E	F	Webbing Width	Stretch Zippered Part No.
Small	9½"	18"	5½"	10½"	5¾"	2"	1"	14152
Medium	10½"	21"	7"	12"	6½"	2¼"	1"	14153
Large	11½"	23"	7¾"	13¼"	7¼"	2½"	1"	14154
X Large	12½"	25½"	8¾"	14½"	7¾"	2¾"	1"	14155

## Suggested for Physical Conditions:

- Trunk Lordosis
- Trunk or Shoulder Rotation
- Shoulder Protraction: One or both shoulders lean forward
- Thoracic Kyphosis causing forward flexion of the upper trunk
- Scoliosis
- Spasticity
- Muscle Weakness/Atrophy
- Body Temperature Control

## Suggested for Wheelchair Conditions:

- Maintain seated posture while utilizing tilt and/or recline
- Achieve intimate contact with seating surfaces due to decreased spasticity

# AirLogic™ Slim-Cut Anterior Trunk Supports

Slim-Cut styles are designed especially for women or those who prefer less material covering the chest area. Enjoy all the features of AirLogic™ in a more streamlined design. Choose from Stretch, Non-Stretch and Zippered styles. To size AirLogic™ Slim-Cut styles, match dimensions in the table with the illustration below.



**AirLogic™ Anterior Trunk Support: Slim-Cut**

Size	A	B	C	D	E	F	Webbing Width	Stretch Part No.	Non-Stretch Part No.
Extra Small	8¾"	14½"	5	8¼"	1¼"	2	1"	14256	14286
Small	9¼"	17	6	10	1¼"	2	1"	14257	14287
Medium	10¼"	20	7½"	11¼"	1¼"	2¼"	1"	14258	14288
Large	11¼"	22	8¼"	12½"	1½"	2½"	1"	14259	14289
X Large	12¼"	24	9	13½"	1½"	2¾"	1"	14260	14290

**AirLogic™ Anterior Trunk Support: Slim-Cut Zippered**

Size	A	B	C	D	E	F	Webbing Width	Stretch Zippered Part No.
Medium	10½"	21"	7"	11¾"	2½"	2¼"	1"	14158
Large	11½"	23"	7¾"	13"	2¾"	2½"	1"	14159
X Large	12½"	25"	8¾"	14"	3"	2¾"	1"	14160

**AirLogic Anterior Trunk Support: Replacement Strap Kit**

Belt Style	Webbing Size	Part No.	Unit of Measure
AirLogic	1"	14842	1 Set



## AirLogic™ vs. Dynaform® Anterior Trunk Support: Details

Brand	Style	Suggested for High Tone	Suggested for Women or Small Children	Includes Zipper	Breathable & Moisture-Wicking (Machine Washable)	Front-Pull Top Straps	Rear-Pull Top Straps	Economic Choice
AirLogic	Standard-Cut Stretch				•	•		
AirLogic	Standard-Cut Zippered			•	•	•		
AirLogic	Standard-Cut Non-Stretch	•			•	•		
AirLogic	Slim-Cut Stretch		•		•	•		
AirLogic	Slim-Cut Zippered		•	•	•	•		
AirLogic	Slim-Cut Non-Stretch	•	•		•	•		
Dynaform	Standard-Cut Stretch						•	•
Dynaform	Standard-Cut Non-Stretch	•					•	•
Dynaform	Slim-Cut Stretch		•				•	•
Dynaform	Slim-Cut Non-Stretch	•	•				•	•

## Suggested Size by Back Height\*

Back Height	AirLogic™												Dynaform®							
	Standard-Cut Stretch		Standard-Cut Zippered		Standard-Cut Non-Stretch		Slim-Cut Stretch		Slim-Cut Zippered		Slim-Cut Non-Stretch		Standard-Cut Stretch		Standard-Cut Non-Stretch		Slim-Cut Stretch		Slim-Cut Non-Stretch	
	Size	Part	Size	Part	Size	Part	Size	Part	Size	Part	Size	Part	Size	Part	Size	Part	Size	Part	Size	Part
≤ 9"	XXS	14250			XXS	14280	XS	14256			XS	14286	XXS	14850	XXS	14880	XS	14856	XS	14886
10-13"	XS	14251			XS	14281	XS	14256			XS	14286	XS	14851	XS	14881	XS	14856	XS	14886
14-16"	S	14252	S	14152	S	14282	S	14257			S	14287	S	14852	S	14882	S	14857	S	14887
17-19"	M	14253	M	14153	M	14283	M	14258	M	14158	M	14288	M	14853	M	14883	M	14858	M	14888
20-21"	L	14254	L	14154	L	14284	L	14259	L	14159	L	14289	L	14854	L	14884	L	14859	L	14889
≥ 22"	XL	14255	XL	14155	XL	14285	XL	14260	XL	14160	XL	14290								

\*Sizes shown are suggestions only; actual size may vary by client.

## AirLogic™ vs. Dynaform® Anterior Trunk Support: Which Do You Need?

### Are you looking for any of these features?

- Breathable & Moisture-Wicking
- Front-Pull Top Straps
- XL for Adults
- Zippered Option
- Machine Washable
- Limited Stretch or Non-Stretch

### Are you looking for any of these features?

- Economic Price
- Rear-Pull Top Straps
- 4-Way Stretch or Non-Stretch

For more information on Dynaform Posture Supports, please reference pages 10-11.

**Yes**  
AirLogic™

**No**  
Dynaform®

**Yes**  
Dynaform®

**No**  
AirLogic™

### Choose a Style

#### High Tone?

**Yes**  
Non-Stretch

**No**  
Stretch

#### Female or Small Child?

**Yes**  
Slim-Cut

**No**  
Standard-Cut

### Choose an Accessory

#### Prefer a Zipper?

**Yes**  
AirLogic™  
Stretch  
Zippered

**No**  
AirLogic™ Stretch  
or AirLogic™  
Non-Stretch  
or any Dynaform®

#### Prefer Front-Pull Top Straps?

**Yes**  
AirLogic™

**No**  
Dynaform®



# We've expanded AirLogic options to new posture and chest support styles. Greater comfort. Optimal support.

Unlike traditional neoprene-based belts, the controlled stretching of AirLogic panels significantly reduces incidents of torn stitching.

A swiveling, side-release buckle at the center of our Swivel-Point Posture Support enables a more comfortable and precise fit. Use the swiveling buckle to angle the left and right panels as needed. By distributing connection point stress through its free-moving design, the durable buckle increases belt longevity. Other posture supports feature our slim-line, low-profile, side-release buckle.



**Slim-line, low-profile buckles** combine easy-to-use side release operation, a dynamic and sporty look with a strength rating of 50 lbs. of direct force.



**Rear D-ring pull straps** enable easy support adjustment by users and caregivers.



**Exclusive AirLogic technology** facilitates air movement when in contact with the user's body. It is designed to keep the user cool, dry and secure.



**A variety of posture support styles** provides optimal support and upper body positioning based on individualized needs and comfort.



## AirLogic™ One-Piece Buckle

Chest Supports enable rotation of the shoulders and a greater ability to reach forward than butterfly-style harnesses. On the left and right of the belt, side-release buckles hold securely, yet release easily to simplify transfers.

**AirLogic™ Chest Support:  
One-Piece with Buckles**

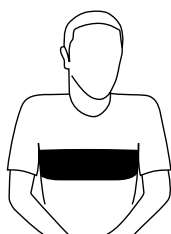

**AirLogic™ Chest Support: One-Piece with Buckles**

Size	Pad Height	Pad Width	Recommended Chest Width	Stretch Part No.
XX Small	3"	14"	6-8"	14222
X Small	3"	16"	8-10"	14223
Small	3"	18"	10-12"	14224
Medium	4"	20"	12-14"	14227
Large	4"	22"	14-16"	14228
X Large	4"	24"	16-18"	14229
XX Large	5"	26"	18-20"	14230

## AirLogic™ Swivel-Point

The Swivel-Point features a swiveling, side-release buckle in the center that enables precise fitting. Use the swivel buckle to angle the left and right panels as needed. Because it uses less material than a traditional butterfly-style harness, the Swivel-Point Posture Support is less restricting and does not obstruct feeding tubes in the lower trunk area.

**AirLogic™ Posture Support:  
Swivel-Point**

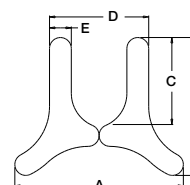
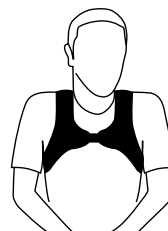

**AirLogic™ Posture Support: Swivel-Point**

Size	A	B	C	D	E	Stretch Part No.
Small	14½"	10½"	6¼"	8½"	2"	14267
Medium	18"	13¼"	8"	10¼"	2¼"	14268
Large	19¼"	15½"	10"	11¼"	2½"	14269

### Suggested for Physical Conditions:

- Kyphosis
- Low Tone
- Spasticity
- Muscle Weakness/Atrophy
- Body Temperature Control

### Suggested for Wheelchair Conditions:

- Hold the client upright when the wheelchair is in an upright position
- Align the client properly between the lateral supports

### Suggested for Physical Conditions:

- Asymmetrical contours
- Thoracic Kyphosis causing forward flexion of the upper trunk
- Shoulder Rotation
- Shoulder Protraction: one or both shoulders lean forward
- Spasticity
- Muscle Weakness/Atrophy
- Body Temperature Control

### Suggested for Wheelchair Conditions:

- Allow for easy transfers in and out of the support with the center release buckle
- Eliminate obstruction in the lower trunk area for feeding tubes
- Maintain seated posture while utilizing tilt and/or recline
- Achieve intimate contact with seating surfaces due to decreased spasticity



# AirLogic™ Y-Style

The asymmetrical Y-Style provides the minimum support needed to maintain upright seating. Apply to the left or right side of the client, or use two supports—one on each arm—for additional support.



**AirLogic™ Posture Support: Y-Style**

**AirLogic™ Posture Support: Y-Style**

Size	A	B	C	Stretch Part No.
Small	7"	18"	2¼"	14262
Medium	8"	20"	2¼"	14263
Large	10"	24"	2½"	14264
X Large	11"	26"	2½"	14265

### Suggested for Physical Conditions:

- Trunk or Shoulder Rotation
- Shoulder Protraction: one shoulder leans forward
- Hemiparesis: one side is weaker than the other
- Body Temperature Control

### Suggested for Wheelchair Conditions:

- Maintain seated posture while allowing for dynamic reach with the non-supported upper extremity

# AirLogic™ Backpack Style

The Backpack style includes two independently mounted straps to accommodate asymmetrical seating postures. If support is only needed on one side, mount one strap on the side that requires the extra support while enabling dynamic movement on the other side.



**AirLogic™ Posture Support: Backpack Style**

**AirLogic™ Posture Support: Backpack Style**

Size	A	B	Stretch Part No.
Small	11"	2"	14272
Medium	13½"	2¼"	14273
Large	16"	2¼"	14274

**AirLogic™ Posture & Chest Supports: Replacement Strap Kit**

Style	Webbing	UOM	Part No
AirLogic Swivel-Point, Y-Style, One-Piece Buckle, and Backpack Style	1"	1 Set	14843

### Suggested for Physical Conditions:

- Bilateral Shoulder Internal Rotation
- Thoracic Kyphosis
- Shoulder Protraction: One or both shoulders are leaning forward
- Spasticity
- Muscle Weakness/Atrophy
- Body Temperature Control

### Suggested for Wheelchair Conditions:

- Maintain seated posture while utilizing tilt and/or recline
- Achieve intimate contact with seating surfaces due to decreased spasticity
- Eliminate obstruction in the lower trunk area for feeding tubes



# Dynaform® Posture and Chest Supports

## Dyanform® continues to offer stretch and non-stretch style Posture and Chest Supports

Our stretch Dynaform® styles are constructed of a Lycra and Nylon covered Neoprene to provide a dynamic and comfortable fit. Non-stretch Dynaform® styles are constructed with a soft vinyl-padded material which is easy to wipe clean. The Dynaform® Posture Support is also available in Standard- or Slim-Cut styles especially designed for female clients or those who prefer less material covering the chest area.



**Standard-Cut Anterior Trunk Support**



**Slim-Cut Anterior Trunk Support**



**Y-Style**



**One-Piece Buckle**



**Upper-Body**



**Backpack Style**



**X-Style**



**Two-Piece Velcro**

## Accessories and Modifications

### Strap Guides

Webbing Size	Part No.	Unit of Measure
¾" & 1"	14581	1 Set (2 ea)
1½"	14582	1 Set (2 ea)

### Replacement Strap Kit

Belt Style	Webbing Size	Part No.	Unit of Measure
Dynaform	¾"	14840	1 Set
Dynaform	1"	14841	1 Set

### Non-Stretch Modification

Part No.
14000





# Dynaform® Posture and Chest Supports

To size any Dynaform® Posture or Chest Support, match the dimensions in the corresponding table to the illustration to the left.

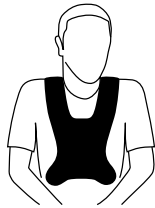
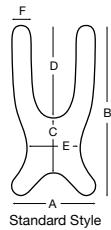

## Dynaform® Anterior Trunk Support: Standard-Cut

Size	A	B	C	D	E	F	Webbing Width	Stretch Part No.	Non-Stretch Part No.
XX Small	5"	10"	4"	5"	1¼"	1¼"	¾"	14850	14880
Extra Small	8"	14"	4"	8½"	4"	2"	¾"	14851	14881
Small	9"	17"	5"	10"	5"	2"	¾"	14852	14882
Medium	10"	20"	6"	11½"	6"	2"	1"	14853	14883
Large	11"	22"	7"	12"	7"	2¼"	1"	14854	14884

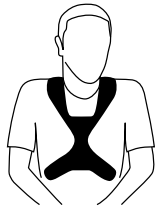
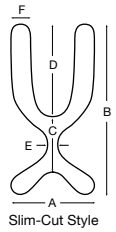

## Dynaform® Anterior Trunk Support: Slim-Cut

Size	A	B	C	D	E	F	Webbing Width	Stretch Part No.	Non-Stretch Part No.
Extra Small	8"	14"	4"	8½"	1"	2"	¾"	14856	14886
Small	9"	17"	5"	10"	1"	2"	¾"	14857	14887
Medium	10"	20"	6"	11½"	1¼"	2"	¾"	14858	14888
Large	11"	22"	7"	12"	1½"	2½"	1"	14859	14889

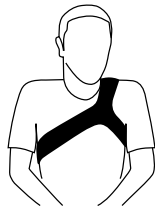
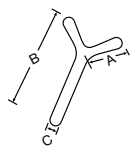

## Dynaform® Posture Support: Y-Style

Size	A	B	C	Webbing Width	Stretch Part No.
Small	7"	18"	2"	¾"	14862
Medium	8"	20"	2"	¾"	14863
Large	10"	24"	2½"	1"	14864

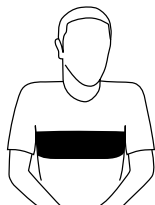

## Dynaform® Chest Support: One-Piece Buckle

Size	Pad Height	Pad Width	Webbing Width	Recommended Chest Width	Part No.
XX Small	3"	14"	1"	6"-8"	14922
Extra Small	3"	16"	1"	8"-10"	14923
Small	3"	18"	1"	10"-12"	14924
Medium	4"	20"	1"	12"-14"	14927
Large	4"	22"	1"	14"-16"	14928
Extra Large	4"	24"	1"	16"-18"	14929

## Dynaform® Chest Support: Two-Piece Velcro

Size	Pad Height	Recommended Chest Width	Stretch Part No.
Small	3"	6"-12"	14941
Medium	4"	10"-16"	14942
Large	5"	12"-18"	14943

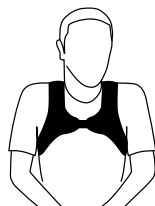
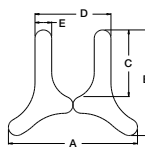

## Dynaform® Posture Support: Upper-Body

Size	A	B	C	D	E	Stretch Part No.
Small	14½"	10½"	6¼"	8½"	2"	14867
Medium	18"	13¼"	8"	10¼"	2¼"	14868
Large	19¼"	15¼"	10"	11¼"	2½"	14869

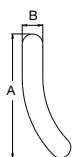

## Dynaform® Posture Support: Backpack Style

Size	A	B	Webbing Size	Stretch Part No.
Small	11"	2"	1"	14872
Medium	13½"	2¼"	1"	14873
Large	16"	2¼"	1"	14874

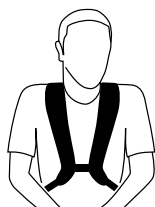

## X-Style Posture Belt

Size	Pad Height	Pad Width	Webbing Width	Stretch Part No.
Small	12"	1½"	¾"	14806
Medium	14"	2"	1"	14807
Large	17"	2½"	1½"	14808



### **AirLogic™ Cleaning Guidelines**

AirLogic™ Posture and Chest Supports may be machine washed separately in cold water on a delicate setting. Use a mild detergent, and air- or machine-dry on a delicate setting.

**Note: Chest Supports should always be used with a pelvic support (i.e. hip belt) to prevent the client from sliding down in the seat.**

**Note: AEL AirLogic Posture Supports, Posture Belts and Hip Belts are designed as positioning aids and do not qualify as automobile restraints.**



Adaptive Engineering Lab, Inc.  
102 East Keefe Avenue  
Milwaukee, Wisconsin 53212, USA

