



Rolling Walker

Provides added stability while walking



1 Part Check

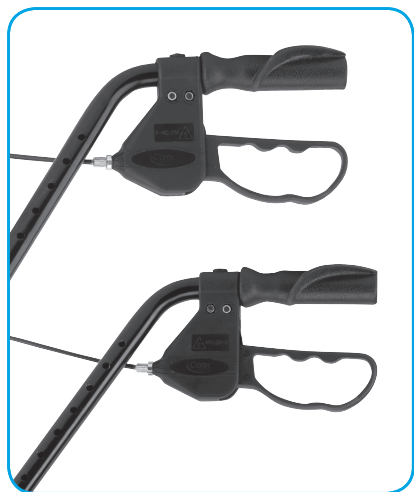

2 Handles



1 Backrest



6 Hand screws



2 Front wheels



2 Rear wheels



6 Bolts with plastic washers

Note: actual items may vary slightly from what is shown.

6 Installing Backrest



1



2

5 Adjusting the handles

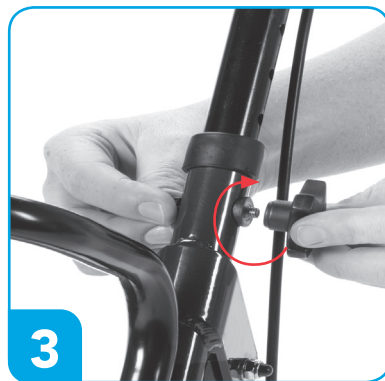
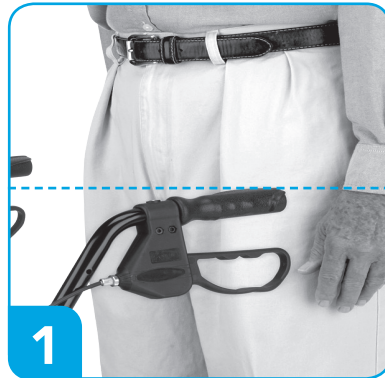

2 Front wheel assembly

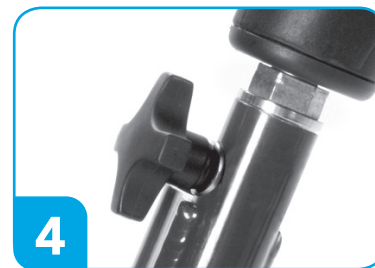

3 Rear wheel & brake assembly

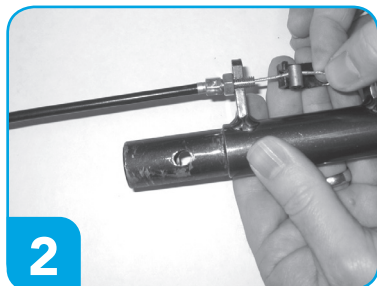
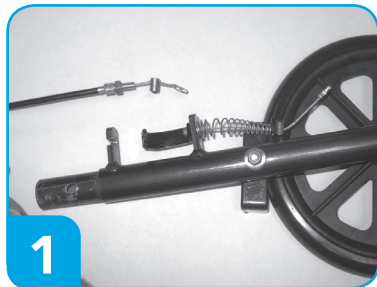

Brake Assembly



4 Unfolding walker & installing handles

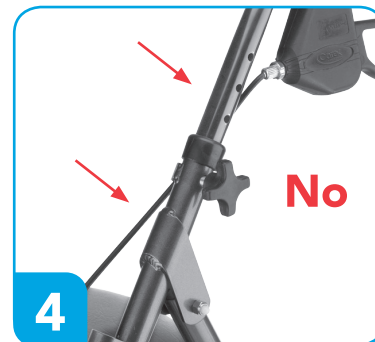
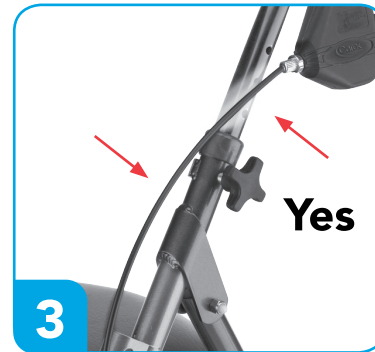
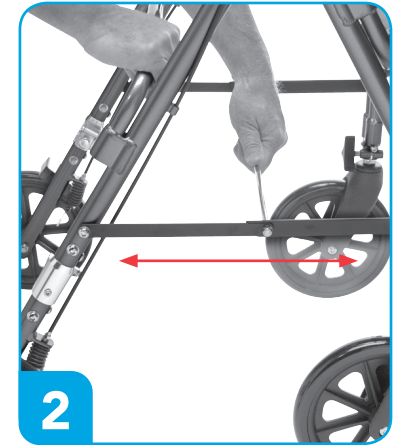

Handle brakes lock for safety.
1. Squeeze handle to brake
2. Press handle down to engage lock

