

WiZARD 310 Nasal Mask Assembling Guide

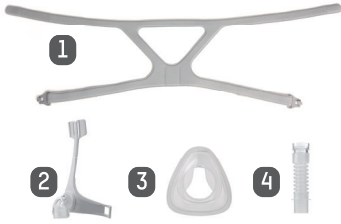

Component

- 1 WiZARD 310/320 Headgear with Buckles
- 2 WiZARD 310 Elbow Connector with frame
- 3 WiZARD 310 Nasal Mask Cushion, Large
- 3 WiZARD 310 Nasal Mask Cushion, Medium
- 3 WiZARD 310 Nasal Mask Cushion, Small
- 4 Silicon Tubing

Caution! Please confirm that all the components belong to WiZARD 310 Nasal Mask by checking the reference number before assembling.



1 Connect the silicon tube to the frame directly



2 Align the arrow on cushion to the groove on frame and assemble them together directly



3 Lay flat the headgear with WiZARD label downwards



4 Place the frame on the center of headgear and hook on the buckles

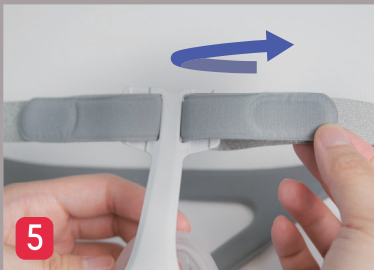

5 Assemble the upper straps through the holes in front of forehead pad and attach the velcros



6 Assembly completed. (The WiZARD logo should be outwards on the back of headgear)