



TRAILMATE

www.trailmate.com

FUN CYCLE













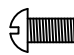

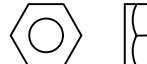
OWNER'S GUIDE

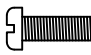
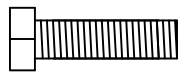
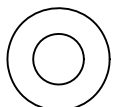
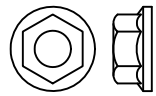
FUN CYCLE PARTS LIST

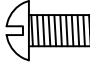
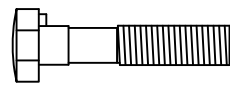
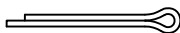
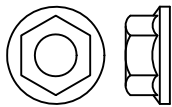
ITEM	PART	DESCRIPTION	QTY.	ITEM	PART	DESCRIPTION	QTY.
1.	19561	TIRE 20 X 2.25 BSW F/C,LR W/TU	2	24.	11857	PEDAL 1/2" PR #643P10E141	1
2.	11162	BUSHING NYLON 5/8 12SWS3151	2	25.	18175	GRIP HANDLE YLW & BLK -530	2
3.	11695	CRANK 5 1/2"	1	26.	11070	PIN COTTER 3/32X1	2
4.	11697	CRANK SET COMPLETE	1	27.	11340	NUT 1/2-13 NYLON JAM	2
5.	11713	CHAINGUARD F/C	1	28.	12170	NUT 10-32 HEX KEPS	3
6.	11718	DECAL TM HEAD	1	29.	12172	NUT 1/4-20 FLANGED	2
7.	11728	DECAL FUNCYCLE SIDE RAIL	2	30.	12178	NUT 3/8-16 FLANGED	2
8.	20288	FENDER BRACE FC	1	31.	12197	SCREW 1/4-20X1/2 RHMS (frame welded)	2
9.	11934	SPROCKET 36T 1/2X1/8-TRK/BP/FC	1	32.	12224	SCREW 3/8-16X3/4 HHCS	2
10.	11957	TIRE 20X1.75 BSW-DES/FC W/TUBE	1	33.	19640	WASHER 5/8 SAE	4
11.	12057	WHL 20" MAG F/C REAR W/BRG	2	34.	12279	CLAMP (BRAKE STRAP) SHIMANO	1
12.	12058	WHL 20" MAG F/C W/CB HUB&HDW	1	35.	12301	WASHER 3/8 FLAT SAE	2
13.	12102	SAFETY FLAG W/O BRACKET	2	36.	13225	CLMP BOLT M8X38MM LG HH	2
14.	12188	SCREW 10-32X3/8 SLTD HWH T/F/S	2	37.	13226	CLMP WASHER M8 FLAT	2
15.	12241	SET COLLAR 5/8"	4	38.	13227	CLMP NUT ACORN M8 HEX	2
16.	12273	RETAINING RING	2	39.	18764	SCREW 1/2-13X1-1/4 HHCS ZC	2
17.	13182	FRAME F/C BACK REST <u>ASSEMBLY</u>	1	40.	19153	NUT AXLE CB	2
18.	13184	FRAME F/C FRONT	1	41.	19168	NUT BRAKE STRAP	1
19.	13190	FRAME F/C REAR	1	42.	19169	SCREW BRAKE STRAP	1
20.	19167	SPROCKET 18T F/C	1	43.	19171	SCREW 10-32X3/8 RHMS	3
21.	19278	SEAT FUN CYCLE YELLOW	1	44.	20028	CHAIN ADJUSTER COMPLETE	2
22.	19325	DECAL "DO NOT STAND ON CYCLE"	1	45.	11745	FENDER 20" MWT F/C	1
23.	11693	CHAIN/CL 73 PITCH F/C	1	46.	20307	SCREW RHMS 8/32 X 3/8" FC/BP	1
				47.	20308	NUT HEX 8/32 FC/BP	1

ILLUSTRATED PARTS LIST (FUN CYCLE)

<p>ITEM #41 PART #19168 (1) NUT BRAKE STRAP</p> 	<p>ITEM #28 PART #12170 (3) NUT #10-32 HEX</p> 	<p>ITEM #43 PART #19171 (3) SCREW #10-32 X 3/8"</p> 	<p>ITEM #32 PART #12224 (2) SCREW #3/8-16 X 3/4"</p> 	<p>ITEM 11340 (2) NUT #1/2-13 NYLON JAM</p> 	
<p>ITEM #29 PART #12172 (2) NUT #1/4-20</p> 	<p>ITEM #38 PART #13227(2) CLAMP NUT</p> 	<p>ITEM #42 PART #19169 (1) SCREW #10-32 X 1/2" SCREW FOR BRAKE STRAP</p> 	<p>ITEM #39 PART #18764 (2) SCREW #1/2-13 X 1 1/4"</p> 	<p>ITEM #33 PART #19640 (2) WASHER 5/8 SAE</p> 	
<p>ITEM #30 PART #12178 (2) NUT #3/8-16</p> 	<p>ITEM #37 PART #13226 (2) WASHER (THICKER)</p> 	<p>ITEM #31 PART #12197 (2) SCREW #1/4-20 X 1/2" (frame welded)</p> 	<p>ITEM #36 PART #13225 (2) CLAMP BOLT</p> 	<p>ITEM #26 PART #11070 (2) COTTER PIN</p> 	
<p>ITEM #40 PART #19153 (4) NUT AXLE</p> 	<p>ITEM #35 PART #12301 (2) WASHER</p> 	<p>ITEM #46 PART #20307 (1) SCREW # RHMS 8/32 X 3/8" FC/BP</p> 	<p>ITEM #34 PART #12279 (1) CLAMP (BRAKE STRAP)</p> 		
		<p>ITEM #47 PART #20308 (1) NUT HEX 8/32 FC/BP</p> 			

1. Preparation

Remove all parts from the carton. Do not remove protective wrapping until necessary.

Open the parts bag and verify all parts present (refer to the illustrated parts list).

Check tire air pressure inflate to 35 psi. Make sure tires are properly seated on rims.

2. Backrest

Install backrest (17) onto front frame assembly (18) with pivot mounting tube pointed downward and to the rear (see figure 1). The backrest should slide onto the frame 1-1/2" to 2" evenly on both sides.

Note: This may be a tight fit and it may be necessary to lubricate the frame and tap the backrest on with a rubber mallet.

Insert bolts (36) into backrest clamps from the outside and loosely install washers (37) and nuts (38). Note: On some backrest clamps it may be necessary to squeeze with pliers before inserting screws.

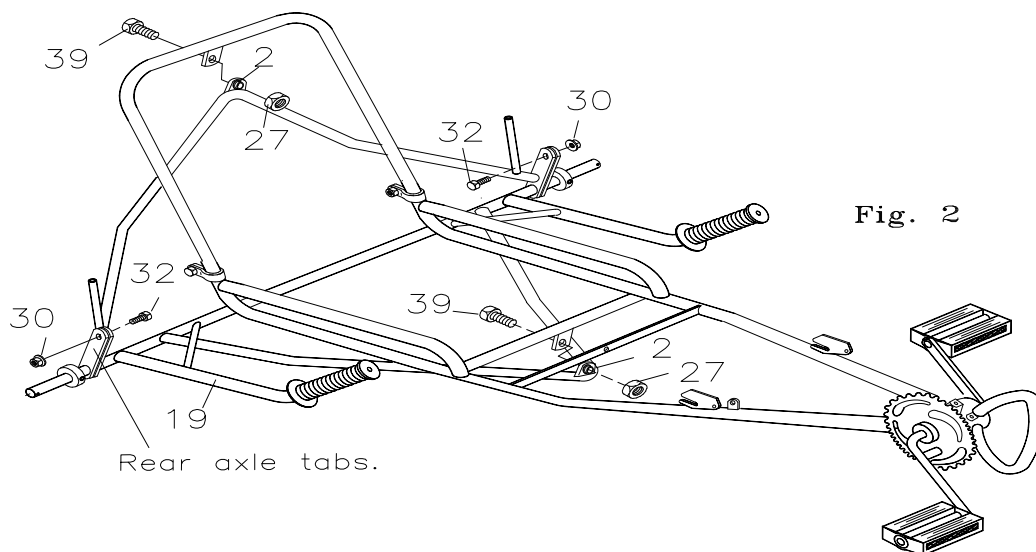
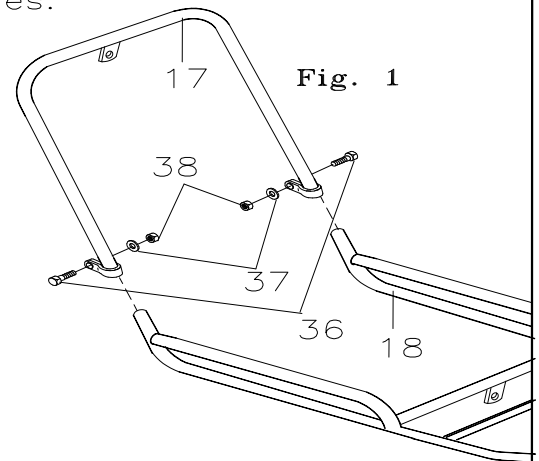

3. Front and Rear Frame.

Insert the screws (32) in the holes on rear axle tabs. Loosely tighten with the nuts (30). Assemble front frame (18), with the backrest on top of rear frame (19) section (see figure 2).

Insert screws (39) into nylon bushings that are preassembled into frame sections. Secure with nylon jam nuts (27). Tighten nuts so that the frame sections are securely held together, but not so tight to cause binding when pivoted. Tighten backrest clamps. Tighten axle tabs screws (32).

Fig. 3

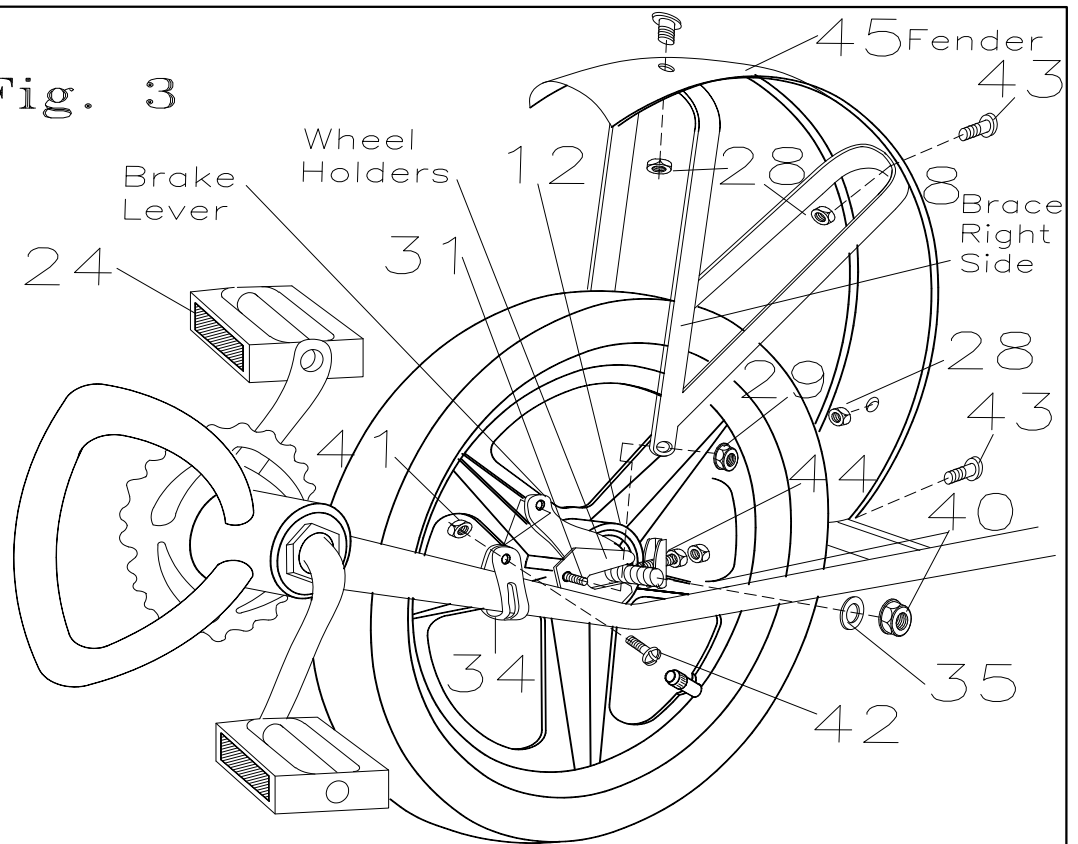

4. Front Wheel Assembly

Install front wheel assembly (12) with the chain adjusters (44) between the frame wheelholders, with the brake lever pointing forward and above the left frame tube (see figure 3).

Install the nuts (40) and loosely tighten. Install the front fender (45) & brace (8) onto frame welded screw (31), with nut (29) (see figure 3). Attach the rear of the fender to the frame using screw (43) and nut (28). Install washers (35) and nuts (40), loosely tighten.

5. Brake Strap

Attach the brake strap (34) to the frame by bending it into a "U" shape and sliding it over the left frame tube, from the bottom up (see figure 3). Align the brake strap around the brake arm and insert screw (42) from the outside through the strap and arm. If necessary, use an awl to align all three holes. Secure with nut (41). Do not tighten until chain is adjusted.

6. Chain

Place chain (23) around sprockets and join with connecting link (see figure 4). Slide wheel assembly back use the chain adjuster (44) until chain is tight (approximately 3/4" up and down movement is permissible). While holding wheel assembly centered between frame tubes, gradually tighten axle nuts alternately on each side. Tighten brake strap screw and chain adjuster lock nuts.

Crank the pedal sprocket and check for binding or "clicking" noise. If any is noticed, visually check the chain and sprocket alignment. Check that the sprocket does not rub on the frame tube and that the front tire is centered properly.

7. Pedals

Install pedals (24) by threading the pedal marked "R" into the right side of the crank (clockwise) and the pedal marked "L" into the left side of the crank (counterclockwise).

8. Chainguard (see figure 4)

Install chainguard (5) by removing the screws (14) in the front mounting brackets (see figure 4). Place the rear of the chainguard between the wheel and fender brace (8). Align hole in the rear of chainguard with the upper hole on the left side of brace (8) arm. Insert screw (46) from the outside and secure with nut (47). Pull chainguard forward until front chainguard mounting brackets line up with the second and fourth hole in the front of the chainguard. Secure chainguard with screws (14).

9. Rear Wheels (see figure 5)

Loosen set collar (15) on axle. Slide one washer (33) onto each rear axle against set collar (15). Slide wheel (11) onto axle along with washer (33) and another set collar (15). Secure cotter pin (26) into end of axle. Slide outside set collar against cotter pin and tighten. Move remaining components against outside set collar and tighten inside set collar.

Rear Wheel Installation

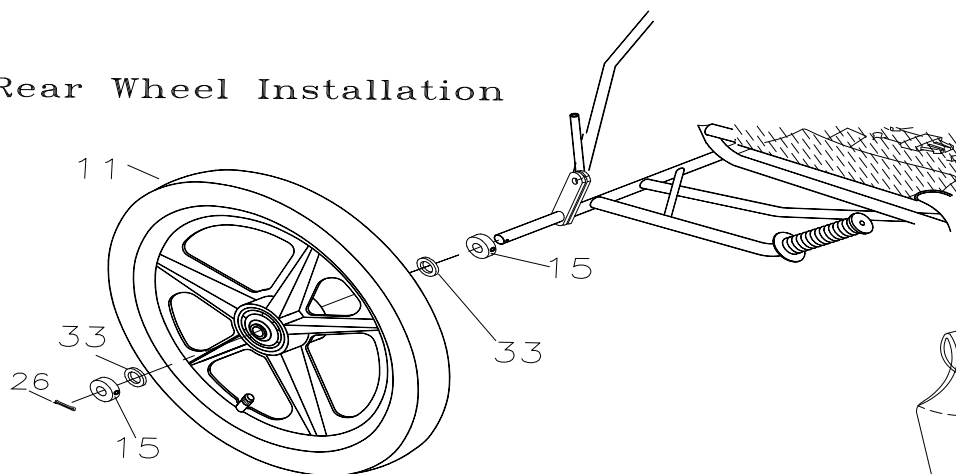

Fig. 5

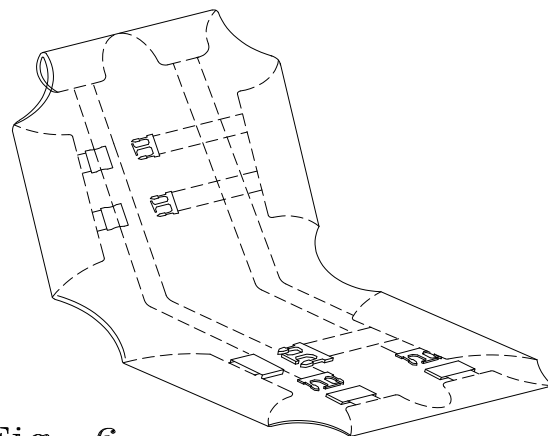

Fig. 6

10. All-Weather Canvas Seat

Place seat (21) on back rest, with the wide flap at top. Install flaps around outside frame and buckle from top to bottom and side to side. Sit in seat and readjust tension until comfortable.

11. Handlegrips and Flag

Complete by installing handlegrips (25) and placing safety flags (13) in holders.

REGULAR MAINTENANCE: Bi-Monthly

1. Keep all painted parts cleaned and waxed for a long-lasting luster.
 2. Spray all chrome parts with recommended protective spray coating (LPS-1, WD-40, etc.).
When spraying with protective coatings, it is recommended that you let parts set overnight so the coating will penetrate.
 3. Lubricate the following:
 - a. Pivot points at top and bottom of seat
 - b. Axle shafts
 - c. Inside bearings of both pedals
 - d. Chain – turn pedal crank forward and spray freely
 4. When storing over prolonged periods, turn upside down to prevent flat spots from occurring on the tires. If stored outside, cover to protect finish and moving parts.
-

PREVENTATIVE MAINTENANCE: Every Six Months

These are services that should be performed by your local bicycle shop. A fee may be charged.

1. Check tires for wear, rim cuts, and valve core alignment (usually caused by improper air pressure).
2. Check wheels for cracks and alignment.
3. Check brakes for proper operation.
4. Clean and repack all bearings and adjust all cones.
5. Check for worn bearings, cones, and cups.
6. Check chain for adjustment and clean as needed.
7. Check for loose bolts and nuts.

Attention: While your unit is new, some noises may occur when the unit is breaking in. Should they continue for more than 30 days, see your local bike shop.

INSPECTION

Check the following, as it applies to your cycle, on a regular basis:

1. Coaster brake – Make sure the brake engages, by pedaling backwards.
2. Wheels – Check wheels for alignment.
3. Pedals – Inspect pedal bearings and make sure pedal is tightly attached to crank.
4. Handle grips – Replace worn or loose grips.
5. Chain – Check for proper tightness. Replace damaged chain immediately.
6. Seat – Adjust seat for rider comfort and safety.
7. Tires – Keep tires inflated to the recommended tire pressure, as indicated on the tire's sidewall.
8. Chainguard – Replace damaged or missing chainguard immediately.
9. Frame – Replace damaged frame immediately.



Trailmate

1851 67th AVE East

Sarasota, FL 34243

Tel: (941) 755-5511

Fax: (941) 758-5141

Visit us @ www.trailmate.com

**For service or to order
replacement parts
please contact your
local Trailmate dealer.**

FUN CYCLE

This is a recreational unit, not designed for excessive speeds or misuse.

Do not brake or turn at high speeds. This may cause cycle to roll over. Careless operation may cause rider to lose control and result in **serious injury**.

Things to know before riding your cycle:

1. Know your local bicycle laws and wear a helmet.
2. Do not exceed the recommended weight limit of 250 lbs.
3. No more than one rider at one time.
4. Do not stand on unit.
5. Be sure to install safety flags.
6. Wear light-colored clothing and protective gear.
7. Do not ride at night.
8. Children must be supervised by an adult at all times.

Trailmate Limited Warranty

Trailmate, Inc., guarantees each cycle product against all defects in materials and workmanship for a period of 90 days from date of purchase. Tires and tubes are not covered by this guarantee.

During this period, any part that is judged by the makers to be defective will be replaced free of charge. Any failure resulting from accident, abuse, neglect, normal wear, or improper assembly or maintenance by the owner is not covered.

Trailmate, Inc., further authorizes a lifetime frame guarantee and will replace any frame, at no cost to the buyer, providing that item has not been used for rental use and that:

- 1) The item has not been altered, repaired, or modified in any way.
- 2) The item has not been subject to misuse, negligence, and/or an accident.
- 3) Original ownership is established.

Any parts under this guarantee on which claims are entered shall be returned for inspection with transportation charges prepaid by the claimant. Replacement parts will be shipped F.O.B. factory.

There are no warranties or guarantee, expressed or implied, written or oral, which extend beyond the description on the face hereof.