



# Traveller Plus

## User Guide



Safety Information . . . . .	2-5
Features . . . . .	6-7
Vehicle Safety Belts . . . . .	8
Vehicle Seating Positions . . . . .	9
Installation . . . . .	10-17
LATCH Installation . . . . .	10-11
Lap-Shoulder Belt Installation (Long Route) . . . . .	12-13
Lap-Shoulder Belt Installation (Short Route) . . . . .	14-15
Lap Belt Only Installation . . . . .	16-17
Versa-Tether® . . . . .	18-19
Using Restraint Features . . . . .	20-23
Recline Bar . . . . .	20
Seat Extension . . . . .	20
Pad Inserts . . . . .	21
Head Pad . . . . .	21
Pommel . . . . .	22
Chest Clip . . . . .	22
Buckle . . . . .	23
Securing Your Child . . . . .	24-25
Harness Height . . . . .	26-27
Checking Harness Height . . . . .	26
Harness Height Adjustment . . . . .	26-27
Buckle Position . . . . .	27
Adjusting Buckle Position . . . . .	27
Care and Maintenance . . . . .	28-31
Warranty . . . . .	32



# WARNING

DEATH or SERIOUS INJURY can occur:

- Use only with children who weigh between 22 and 105 pounds (10 and 48 kg) and whose height is 56 inches (142 cm) or less.
- Snugly adjust the belts provided with this child restraint around your child. A snug strap should not allow any slack. It lies in a relatively straight line without sagging. It does not press on the child's flesh or push the child's body into an unnatural position.
- Always secure the top anchorage strap provided with this child restraint.
- Secure this child restraint with the vehicle's child restraint anchorage system if available or with a vehicle belt.
- Follow all instructions on this child restraint and in the written instructions located on lanyard, under cover in front of seat.
- Register your child restraint with the manufacturer.
- Use vehicle belt (not LATCH connectors) for installations with children weighing more than 48 pounds (21 kg). Refer to the vehicle owner's manual or contact the vehicle manufacturer for the maximum weight rating for their LATCH anchors. Unless specified otherwise by the vehicle manufacturer, assume a 48-pound child is the vehicle LATCH anchor limit.
- Use restraint forward facing only! The American Academy of Pediatrics recommends forward facing only after one year old.
- This child restraint must not be used in the home, in boats, or other non-certified applications.
- Secure this child restraint even when it is not occupied. In a crash, an unsecured child restraint may injure vehicle occupants.

- Never route vehicle belt over child!
- Based on crash statistics, the National Highway Traffic Safety Administration recommends that parents select the rear seat as the safest location for a properly installed child restraint. Please study the section on *Vehicle Safety Belts* in this booklet to ensure the child's safety. If in doubt about installing the child restraint, consult the vehicle owner's manual.
- When using in vehicle with air bags, refer to the vehicle owner's manual for child restraint installation instructions and precautions.
- Never use the adjuster strap to lift or carry this child restraint. Doing so could cause damage to the harness adjuster and webbing. Always carry this child restraint by the shell or tether straps.
- The primary protection for occupants of a vehicle in a collision is the body of the vehicle itself; a child restraint will not protect a child when the vehicle is seriously impacted. However, correctly installed, a child restraint will substantially improve the chances for survival in most crashes. Make sure that all users fully understand the correct ways to use this child restraint in a vehicle.



**DO NOT** place a child restraint in the front seat of a vehicle with a passenger air bag unless the air bag is turned off. **DEATH or SERIOUS INJURY** can occur. The back seat is the safest place for children under 12.

- This child restraint system conforms to all applicable Federal motor vehicle safety standards. **This restraint is certified for use in motor vehicles and aircraft.**
- **Fill out the registration card and mail it in today!**

Child restraints could be recalled for safety reasons. You must register this restraint to be reached in a recall. Send your name, address, and the restraint's model number and manufacturing date to Britax Child Safety, Inc. 13501 South Ridge Drive Charlotte, NC 28273 or call 1-888-4BRITAX. For recall information, call the U.S. Government's Auto Safety Hotline at 1-800-424-9393 (202-366-0123 in DC area).

You may also register by visiting [BritaxUSA.com](http://BritaxUSA.com).

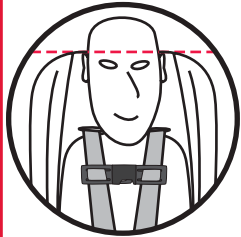

**Weight Range:** 22–105 lbs. (10–48 kg)

**Height:** The child is too tall when the top of the ears are above the top of the restraint. Child's height must be between 30 inches and 56 inches.

**Chest Clip:** Position the chest clip at the middle of the child's chest, level with the armpits.

### IMPORTANT NOTES

- Verify that the restraint is secure and that the harness is properly adjusted around your child each time you use the restraint.
- Adjust the harness to fit the clothes the child is wearing. The harness will fit a child in winter clothes differently than a child in summer clothes.
- Cover the restraint if your vehicle is parked in direct sunlight. Parts of the restraint can become hot enough to burn.
- Store the restraint in a safe place when it is not being used. Avoid placing heavy objects on top of it.
- To prevent injury due to deterioration or hidden damage, discontinue use of a restraint that is older than six years or has been in a severe crash.
- Do not leave children alone in a vehicle, even for a short time.
- Do not, except as described in this booklet, attempt to disassemble any part of the restraint or change the way its harness or your vehicle restraint belts are used.
- Do not leave loose objects, e.g. books, bags, etc., in the back of your vehicle. In the event of a sudden stop, loose objects will keep moving, potentially causing serious injuries.
- Do not leave folding vehicle seats unlatched. In the event of a sudden stop, a loose seat back could prevent the restraint from protecting your child as well as it should.
- Do not allow children to play with the restraint.
- Do not use anything to raise the restraint off the vehicle seat. In a crash, it could slide and be unable to protect your child as well as it should.



- 1 Head Pad
- 2 Cover
- 3 Harness Retainer
- 4 Harness Slots
- 5 Comfort Pads
- 6 Chest Clip
- 7 HUGS™ Shoulder Pads
- 8 Buckle
- 9 Pommel
- 10 Belly Pad
- 11 Perma-Book™ (under cover)



- 12 Harness Adjuster (under flap)
- 13 Harness Adjuster Strap
- 14 Head Pad Straps
- 15 Versa-Tether® Assembly
- 16 Harness Straps
- 17 LATCH/Tether/User Guide Storage Pouches
- 18 Harness Yoke
- 19 Recline Bar
- 20 LATCH Connectors

## Vehicle Safety Belts

**NOTE:** The information in this section only applies to installation with vehicle seat belts.

**IMPORTANT:** Some vehicles have no seating positions which are compatible with this restraint, or any other restraint. If in doubt, contact your vehicle manufacturer for assistance.

The following types of vehicle seat belts are not compatible with this restraint:

- ✗ Front vehicle belts with top or bottom anchorage points in the door.
- ✗ Motor driven automatic vehicle belts.
- ✗ Three-point belts that have separate retractors for the shoulder section and the lap section.
- ✗ Non-locking (ELR) vehicle belts.

The owner's manual for your vehicle will have information on the types of vehicle belts in your vehicle. If your belt type is listed above, select another seating position or use LATCH connectors.

This restraint can fit securely in most vehicles using the existing vehicle belts. However, some types of vehicle designs prevent a secure fit of the restraint due to the position of the vehicle belt lower anchorage points.

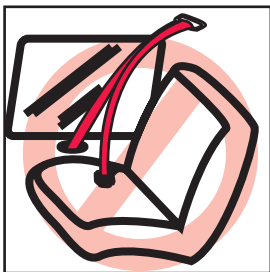
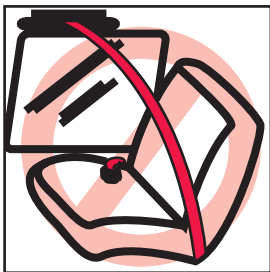

## Vehicle Seating Positions

### **WARNING:**

- Forward facing vehicle seats **MUST** be used with this restraint. Side facing or rear facing seats in vans, station wagons or trucks **CANNOT** be used.
- Britax® and the U.S. Department of Transportation warn that children 12 and under must ride in the rear seats, away from front air bags. The only exception is if the air bag has been turned off.

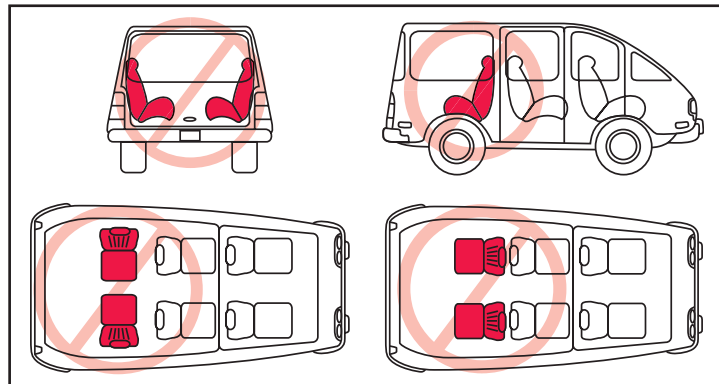

## LATCH Installation

1 Verify that your vehicle is equipped with LATCH anchors (Fig A).

- If LATCH anchors are *not* installed, you must use standard vehicle belt installation methods.

2 If stored, remove LATCH connectors from storage pouches on rear of cover.

3 Remove tether from pouch and loosely attach to approved anchorage point(s).

- See pages 18–19 for complete Versa-Tether instructions.
- ALWAYS use the Versa-Tether!

4 Place the restraint on the vehicle seat with the back facing toward you.

5 Route the furthest LATCH connector under the recline bar, then attach to LATCH anchor (Fig. B).

- A positive click confirms attachment.
- Verify that LATCH harness is not twisted.

6 Rotate seat into forward facing position.

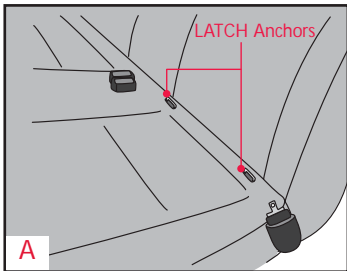

A



B



C

7 Route the closest LATCH connector under the recline bar, then attach to LATCH anchor (Fig. C).

- A positive click confirms attachment.
- Verify that LATCH harness is not twisted.

8 Push restraint firmly into the vehicle backrest, while reaching through belt slots to access loop end of LATCH harness adjuster straps. Pull straps under recline bar and through slots to tighten (Fig. D). Pull strap until all slack is removed from the LATCH harness.

9 Attach Versa-Tether® as instructed on pages 18–19.

**WARNING:** Use vehicle belt (not LATCH connectors) for installations with children weighing more than 48 pounds (21 kg). Refer to the vehicle owner's manual or contact the vehicle manufacturer for the maximum weight rating for their LATCH anchors. Unless specified otherwise by the vehicle manufacturer, assume a 48-pound child is the vehicle LATCH anchor limit.



D

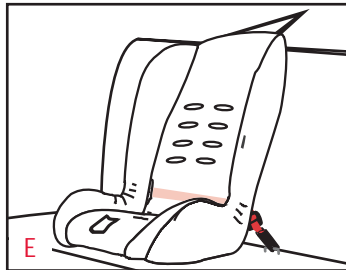

E

## Removal

To remove the restraint, release both LATCH connectors from the LATCH anchors by pressing the release buttons. Disconnect the Versa-Tether from the tether anchor. Store LATCH connectors and tether components in storage pouches on back of cover when not in use.

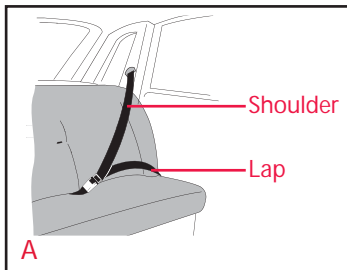

## Lap-Shoulder Belt Installation Long Route

*(Recommended vehicle belt route)*

- Figure A illustrates a typical lap-shoulder belt installation.
- When not in use, always store the LATCH connectors in storage pouches sewn in back of cover.

- 1 Place the restraint in a forward facing position on the vehicle seat.
- 2 Remove tether from pouch and loosely attach to approved anchorage point(s).
  - See pages 18–19 for complete Versa-Tether instructions.
  - ALWAYS use the Versa-Tether!
- 3 Pull the vehicle belt out completely and pass it through the first belt slot, from the front of the restraint to the rear (Fig B).



- 4 Route the vehicle belt around the back of the restraint then through the second belt slot, from the rear of the restraint to the front (Fig. C).
- 5 Verify that the vehicle belt is not twisted, then buckle (Fig. D).
  - If unable to buckle the vehicle belt around the restraint using the long route, use Lap-Shoulder Belt Installation (Short Route) on pages 14–15.
- 6 While pushing the restraint firmly into the vehicle backrest, remove all slack from the vehicle belt.
  - First remove slack from the lap portion of the vehicle belt, then the shoulder portion (Fig. E & F).
- 7 Verify that the vehicle belt is tight and the restraint is secure.
- 8 Refer to Figure G to verify correct routing of the vehicle belt.
- 9 Attach Versa-Tether® as instructed on pages 18–19.
  - ALWAYS use the Versa-Tether!

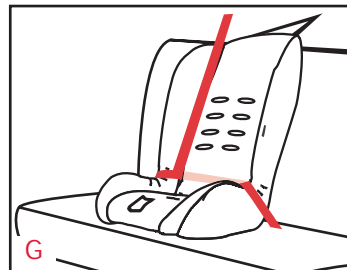



## Lap-Shoulder Belt Installation

### Short Route

(Recommended *ONLY* if vehicle belt is too short for Long Route)

- Figure A illustrates a typical lap-shoulder belt installation.
- When not in use, always store the LATCH connectors in storage pouches sewn in back of cover.

- 1 Place the restraint in a forward facing position on the vehicle seat.
- 2 Remove tether from pouch and loosely attach to approved anchorage point(s).
  - See pages 18–19 for complete Versa-Tether instructions.
  - **ALWAYS** use the Versa-Tether!
- 3 Pull the vehicle belt out and pass it through the first belt slot, from the rear of the restraint to the front (Fig B).

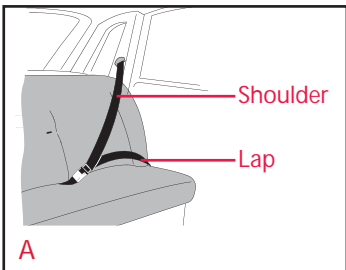

- 4 Route the vehicle belt under the cover then through the second belt slot, from the front of the restraint to the rear (Fig. C).
- 5 Verify that the vehicle belt is not twisted, then buckle (Fig. D).
- 6 While pushing the restraint firmly into the vehicle backrest, remove all slack from the vehicle belt.
  - First remove slack from the lap portion of the vehicle belt, then the shoulder portion (Fig. E).
- 7 Verify that the vehicle belt is tight and the restraint is secure.
- 8 Refer to Figure F to verify correct routing of the vehicle belt.
- 9 Attach Versa-Tether® as instructed on pages 18–19.
  - **ALWAYS** use the Versa-Tether!

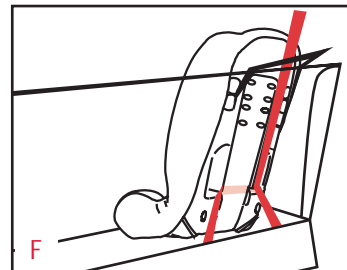

### Lap Belt Only Installation

- *Figure A illustrates a typical lap belt only installation.*
- *When not in use, always store the LATCH connectors in storage pouches sewn in back of cover.*

- 1 Place the restraint in a forward facing position on the vehicle seat.
- 2 Remove tether from pouch and loosely attach to approved anchorage point(s).
  - *See pages 18–19 for complete Versa-Tether instructions.*
  - **ALWAYS use the Versa-Tether!**
- 3 Pull the vehicle belt out, then pass it through the first belt slot, from the front of the restraint to the rear (Fig. B).
- 4 Route the vehicle belt around the back of the restraint then through the second belt slot, from the rear of the restraint to the front (Fig. C).

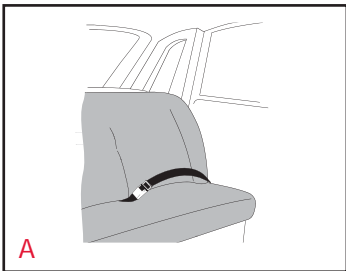

- 5 Verify that the vehicle belt is not twisted, then buckle (Fig. D).
- 6 While pushing the restraint firmly into the vehicle backrest, remove all slack from the vehicle belt. (Fig. E).
- 7 Verify that the vehicle belt is tight and the restraint is secure.
- 8 Refer to *Figure F* to verify correct routing of the vehicle belt.
- 9 Attach Versa-Tether® as instructed on pages 18–19.

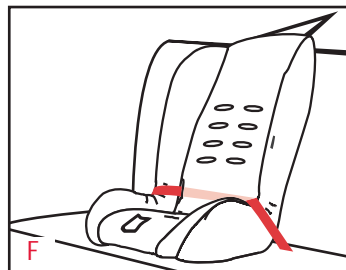

**WARNING:**

- ATTACH THE VERSA-TETHER ONLY TO TETHER ANCHORS IDENTIFIED BY YOUR VEHICLE MANUFACTURER AS TETHER ANCHORAGE POINTS. USE OF OTHER LOCATIONS IS NOT APPROVED OR PERMITTED.
- **THE VERSA-TETHER MUST BE USED AT ALL TIMES. USING THE TETHER IMPROVES THE STABILITY OF THE RESTRAINT AND REDUCES THE RISK OF INJURY.**
- Use BOTH tether hooks for children heavier than 80 pounds (36 kg). Attach each hook to a separate tether anchor. One tether anchor is not strong enough for children over 80 pounds.
- If your vehicle does not currently have a tether anchor attachment, refer to your vehicle owner's manual or contact your vehicle manufacturer for assistance. If a tether anchor is not available, DO NOT modify your vehicle without advice from your vehicle manufacturer.

**Using the Versa-Tether**

- 1 Locate the tether on the back of the restraint.
- 2 Once the restraint is secured with the vehicle belts or LATCH, lift the tether adjuster tab to release the tether straps, then pull to fully extend tether.
- 3 Locate the hooks on the strap.
- 4 Attach tether hook to tether anchor(s) in vehicle (*Fig. A-1 OR Fig. A-2*).
  - **For children less than 80 pounds:** hook the tether to an anchor point using a single hook.
  - **For children more than 80 pounds:** use BOTH tether hooks and attach each hook to a separate tether anchor (*Fig. A*).
- 5 Pull the tether adjuster belt to remove all slack.
- 6 Verify that there is tension in the tether strap and that the restraint is properly secured.

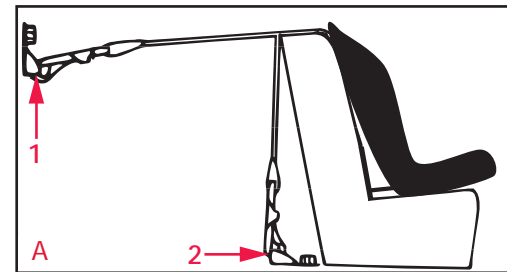

## Recline Bar

The recline bar allows the restraint recline to be adjusted for comfort. Use of the recline bar is optional.

### Attaching the Recline Bar

Insert recline bar into the holes in lower rear of restraint prior to installation in vehicle (Fig. A).

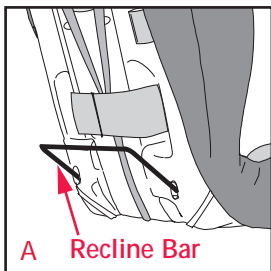

**IMPORTANT:** The bottom of the restraint should be flat on the vehicle seat when installed.

## Seat Extension

The seat extension is intended to provide extra leg support for taller children. Use the seat extension when a child's legs have grown too long to allow a comfortable seating position in the restraint alone.

### Attaching the Seat Extension

Pull cover back from bottom of restraint. Insert seat extension into the holes in front of restraint prior to installation in vehicle (Fig. B). Replace cover.

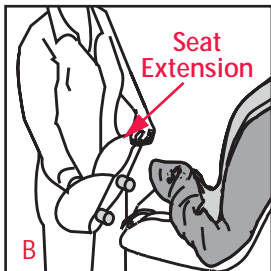

## Pad Inserts

The pad inserts are designed to be adjusted to offer the child more or less support as needed.

The two flat pads are intended for use under the cover on the sides of the restraint. The four foam cylinders are intended for use under the cover and are secured by elastic loops.

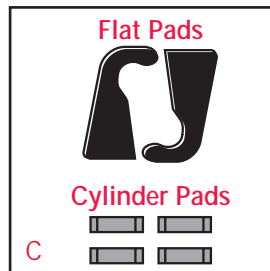

## Head Pad

The head pad should be used to provide additional padding and support for the child's head.

### Attaching the Head Pad

Route straps through the top slots, then over the top of the restraint (Fig. E). Fasten the head pad straps using the snap buttons.

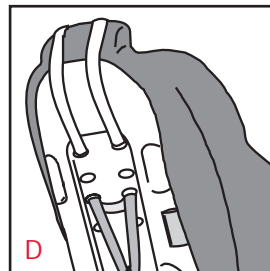

### Adjusting the Head Pad

To adjust the height of the head pad, slide it up or down as needed (Fig. F).

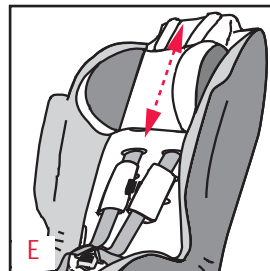

### Pommel

The pommel (*Fig. A*) is intended for extra comfort with older children. While the pommel is optional, the belly pad should always be used.

#### Removing the Pommel

To remove, slide belly pad and pommel off the buckle. Replace belly pad.

#### Installing the Pommel

To install, slide belly pad off buckle to remove. Slide pommel then belly pad on buckle.

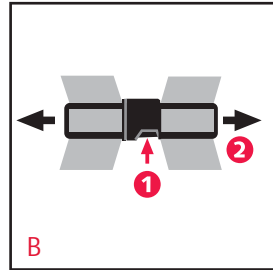
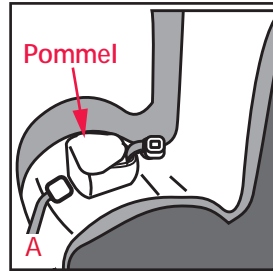

### Chest Clip

**IMPORTANT:** The correct height for the chest clip is at the middle of the chest, level with the armpit.

#### Fastening the Chest Clip

Close chest clip by fitting the two halves together. The chest clip is properly secured when a positive click is heard.

#### Releasing the Chest Clip

Open the chest clip by squeezing the middle tab, then pull the two pieces apart (*Fig. B*).

### Buckle

#### Fastening the Buckle

- 1 Hold the buckle with one hand.
- 2 Use your other hand to insert one tongue at a time into the buckle. Proper connection is confirmed with a positive click, after inserting the second buckle tongue (*Fig. C*).

#### Releasing the Buckle

- 1 Brace the rear of the buckle with hand.
- 2 Use thumb to press release button until tongues are ejected from buckle (*Fig. C*).

**NOTE:** Periodically clean the buckle to ensure proper operation. See page 29.

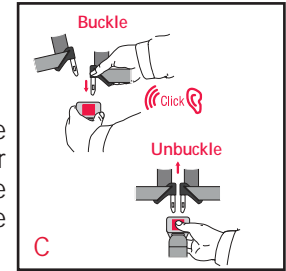

## Securing Your Child

Once the restraint has been installed in the vehicle, follow these instructions to secure your child in the restraint.

**IMPORTANT:** Before securing your child in the restraint, always check the adjuster area for debris (e.g. food, coins, toys, etc.). If debris is present, it must be removed to prevent interference with the adjuster mechanism.

- 1 Loosen the harness by lifting the harness adjuster located in front of the restraint, then pull the shoulder straps forward (Fig. A).
- 2 Unfasten the chest clip by squeezing the middle tab (Fig. B).
- 3 Unfasten the buckle by pressing down on the middle button.
- 4 Move harness straps to the side of the restraint. To aid in holding the straps, insert the pieces of the chest clip into elastic loops on the cover.
- 5 Place child in the restraint.

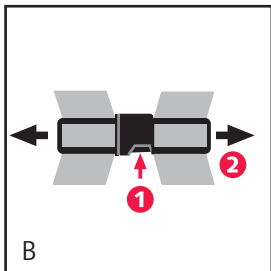

## Securing Your Child

- 6 Position the harness straps around the child and fasten the restraint buckle (Fig. C). Proper connection is confirmed with a positive click after inserting the second buckle tongue.
- 7 Gently pull up on the harness straps to tighten the lap section of the harness, which should fit low on your child's body.
- 8 Slowly pull the adjuster strap to tighten the harness around the child (Fig. D).
  - Snugly adjust the belts provided with this child restraint around your child. A snug strap should not allow any slack. It lies in a relatively straight line without sagging. It does not press on the child's flesh or push the child's body into an unnatural position.
- 9 Fasten the chest clip by connecting the two halves together (Fig. E).
  - The correct height for the chest clip is at the middle of the chest, level with the child's armpit (Fig. F).
  - The HUGS pads may be placed in any position that is comfortable for the child, within the range of the correctly placed chest clip.
- 10 Verify that harness is not twisted and child is properly secured.
  - See *Checking Harness Height* on page 26.



## Harness Height

### Checking Harness Height:

- 1 Place child in restraint, then secure harness (see pages 22–23).
- 2 Observe where the shoulder harness is positioned on your child.
  - *Harness straps should be located in the nearest slot at or above the child's shoulders.*
- 3 If harness height is okay, continue using restraint without adjustment. If harness height requires adjustment, refer to *Harness Height Adjustment* below.

**NOTE:** Once the top slots become necessary, your child may continue to use the restraint until the top of the ears become level with the top of the restraint shell, the child's shoulder height exceeds the height of the top slots, or the child's weight exceeds 105 pounds (48 kg).

### Harness Height Adjustment

- 1 Loosen the harness, by lifting the harness adjuster while pulling the shoulder straps forward as far as possible (Fig. A).
- 2 From the rear of the restraint, unhook the shoulder harness from the yoke (Fig. B).



## Harness Height

- 3 Pull one strap through the shell and cover, to the front of the restraint.
- 4 Thread the harness strap through the appropriate harness slot (Fig. C).
- 5 Reattach harness strap to the yoke.
- 6 Repeat steps 3–5 for the second strap.

**IMPORTANT:** Do not remove HUGS system.

- 7 Pull harness adjuster strap to tighten the harness.
- 8 Verify that all straps are threaded at the same height and are not twisted.



## Buckle Position

### Adjusting Buckle Position

The buckle has two positions and should be adjusted to fit your child (Fig. D). Select the slot closest to, but not under, the child.

**WARNING:** Do not use position two (2) until child exceeds 50 pounds (23 kg)!

Remove the buckle, then rethread in appropriate position. See page 30 for buckle removal and rethreading instructions.

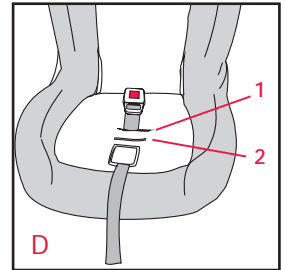

**Cover Removal**

- 1 Loosen the harness, by lifting the harness adjuster while pulling the shoulder straps forward as far as possible.
- 2 Unhook the shoulder straps from the yoke, on the rear of restraint.
- 3 Pull upper harness straps through the shell and cover, to the front of the restraint.
- 4 Remove the belly pad and pommel from the buckle.
- 5 Gently remove the upper portion of the cover. Be careful not to damage the energy absorbing foam.
- 6 Pull the lower harness straps, buckle tongues, chest clip, and buckle through the slots in the cover.

**WARNING:**

- Do not take apart or attempt to take apart the harness. It is unnecessary and dangerous to do so.
  - Never remove the buckle tongues from the harness. They cannot be reattached after removal.
  - Never remove the HUGS system from the harness straps.
- 7 Remove the entire cover from the restraint.

**Refitting the Cover**

To refit the cover, reverse *Cover Removal* directions. Make sure that the shoulder straps are threaded through the chest clip and that the harness is not twisted.

**Cleaning the Cover**

**HAND WASH**, using cold water and mild soap.

**LINE DRY**, to prevent cover from shrinking.

**DO NOT:**

- Bleach
- Machine wash
- Machine dry

**Cleaning the Harness**

**SPONGE CLEAN**, using warm water and mild soap.

**TOWEL DRY**

**DO NOT:**

- Bleach
- Machine wash
- Machine dry
- Disassemble the harness

**Cleaning the Shell**

**SPONGE CLEAN**, using warm water and mild soap.

**TOWEL DRY**

**DO NOT:**

- Use abrasive cleaners
- Disassemble the harness



### Buckle Removal

- 1 Locate the metal buckle strap retainer on bottom of the restraint.
- 2 Pull retainer away from restraint to loosen.
- 3 Turn the retainer so that the short side will go through the slot in the restraint shell (*Fig. A*).
- 4 Push the retainer through slots in the shell and cover, to the front of the restraint.

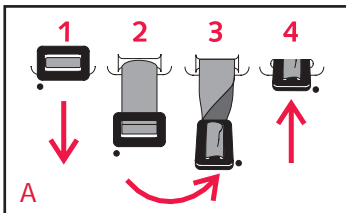

### Rethreading the Buckle

- 1 Locate the necessary buckle slot.
- 2 Turn the buckle retainer so that the short side will go through the slot in the cover and restraint shell (*Fig. A*).
- 3 Pull buckle away from restraint until tight, then verify that the strap is not twisted and the release button is facing out.
- 4 Verify that the buckle retainer lies flat against the restraint shell.

### Cleaning the Buckle

If your child eats and drinks while in the restraint, you may need to check the buckle periodically and wash out any accumulated debris or dried liquids.

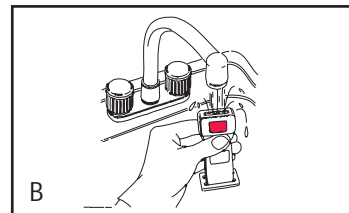

**THOROUGHLY RINSE**, using warm water (*Fig. B*).

**SOAK**, overnight if possible, using warm water to loosen hardened drinks or food.

**TEST THE BUCKLE**, by fastening and unfastening until a positive click is heard after inserting the second buckle tongue (*Fig. C*). If click is not heard, repeat cleaning procedure.

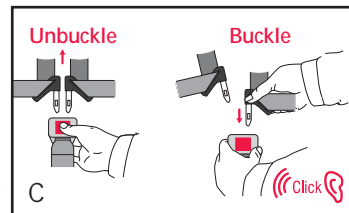

**TOWEL DRY**

#### DO NOT:

- Lubricate
- Use solvents
- Use soap or household detergents

## Warranty

This restraint was distributed by SnugSeat®. SnugSeat warrants this product to the original purchaser as follows:

### LIMITED ONE-YEAR WARRANTY

This product is warranted against defective materials or workmanship for one year from the date of original purchase. Proof of purchase is required. Your exclusive remedy for this warranty is that SnugSeat will, at its option, provide repair or replacement components for this product or refund the original purchase price of the product. SnugSeat reserves the right to discontinue or change fabrics, parts, models or products, or to make substitutions.

To make a claim under this warranty, you must contact SnugSeat at 1-800-336-7684 or write to us using the address on the back cover of this booklet. Proof of purchase is required.

PLEASE COMPLETE AND MAIL THE OWNER REGISTRATION CARD WITHIN (30) DAYS OF PURCHASE.

### WARRANTY LIMITATIONS

This warranty does not include damages which arise from negligence, misuse or use not in accordance with the product instruction.

The use of non-SnugSeat covers, inserts, toys, accessories, or tightening devices is not approved by SnugSeat. Their use could cause this restraint to fail Federal Safety Standards or perform worse in a crash. Their use automatically voids the SnugSeat warranty.

### LIMITATION OF DAMAGES

The warranty and remedies as set forth above are exclusive and in lieu of all others, oral or written, express or implied. In no event will SnugSeat, or the retailer selling this product, be liable to you for any damages, including incidental or consequential damages, arising out of the use or inability to use this product.

### LIMITATIONS OF WARRANTIES AND OTHER WARRANTY TERMS AND STATE LAWS

Any implied warranties, including implied warranties of merchantability and fitness for a particular purpose, shall be limited to the duration and terms of the express written warranty. Some states do not allow limitations on how long an implied warranty lasts or the exclusion or limitation of incidental or consequential damages, so the above limitations may not apply to you. This warranty gives you specific legal rights, and you may have other rights, which vary from state to state. Neither SnugSeat, nor the retailer selling this product, authorizes any person to create for it any other warranty, obligation, or liability in connection with this product.